

PETITION FOR ANNEXATION OF
PLATTED LAND OR UNPLATTED LAND OF 200 ACRES OR LESS
MINNESOTA STATUTES, SECTION 414.033 SUBD. 5

To: Common Council
City Hall
Rochester, MN 55901

The undersigned being (all) (a majority) of the owners in number of the land hereinafter described which abuts the City of Rochester, petition the Common Council to annex said land to the City of Rochester: (If more space is needed, attach additional sheet)

Description: SEE ATTACHED

Reason for Annexation: For Residential Development

Total Number of Owners: Two
"Owners" include each fee holder, contract for deed purchaser, joint tenant, and tenant in common.

Area of Land to be Annexed in Acres:
Platted 0 Unplatted 13.25 Total 13.25

Existing Population of Area to be Annexed: _____

IN WITNESS WHEREOF we have subscribed to this petition of this 10th day of February, 1989.

Respectfully submitted, (Additional names may be put on attached sheet if necessary.)

George N. Kehr 500 S.W. 1st Avenue, Rochester, MN 55902
(Owner) (Address)

George N. Kehr, Attorney-in-fact on behalf of Nathaniel Hendricks, Charlyna Burks & Gladys Payne Company
1700 Northwood Drive NE, Rochester, MN 55904 Fayer

(Owner) (Address)

- DISTRIBUTION:
City Clerk (White Copy)
Consolidated Planning Department (Yellow Copy)
Township Board (Blue Copy)
Olmsted County Board (Green Copy)
Minnesota Municipal Commission (Pink Copy)
Petitioner (Goldenrod Copy)

ANNEXATION: FORM NO. 1
Petition for Annexation

CASCADE TOWNSHIP
ANNEXATION DESCRIPTION

That part of the East Half of the Northeast Quarter of Section 25, Township 107 North, Range 14 West, Olmsted County, Minnesota, described as follows:

Commencing at the southeast corner of said Northeast Quarter; thence northerly on a Minnesota State Plane Grid Azimuth from north of 359 degrees 42 minutes 20 seconds along the east line of said Northeast Quarter 317.00 feet to the northerly line of Northern Heights Eighth Subdivision; thence westerly 269 degrees 22 minutes 07 seconds azimuth along said northerly line 325.75 feet to the point of beginning; thence continuing westerly 269 degrees 22 minutes 07 seconds azimuth along said north line 320.00 feet; thence northwesterly 326 degrees 00 minutes 56 seconds azimuth 589.48 feet; thence northerly 359 degrees 42 minutes 12 seconds azimuth 324.12 feet; thence northeasterly 32 degrees 29 minutes 33 seconds azimuth 373.40 feet; thence southeasterly 122 degrees 29 minutes 33 seconds azimuth 451.36 feet; thence southwesterly 212 degrees 29 minutes 33 seconds azimuth 120.00 feet; thence southeasterly 122 degrees 29 minutes 33 seconds azimuth 396.98 feet to the northwesterly line of Northern Heights East Fourth Subdivision; thence southwesterly 221 degrees 02 minutes 06 seconds azimuth along said northwesterly line 308.03 feet; thence southerly 179 degrees 42 minutes 20 seconds azimuth along the westerly line of Northern Heights East Fourth Subdivision and an extension thereof 335.06 feet to the point of beginning.

Said tract contains 13.25 acres more or less.

ANNEXATION MAP

E. 1/2, N.E. 1/4
SEC. 25, T107 N
R14W

EXISTING
CITY LIMITS

AREA TO BE
ANNEXED

CASCADE TWP
HAVERHILL TWP

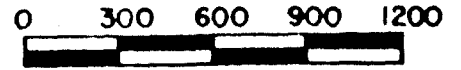

SCALE: 1" = 600

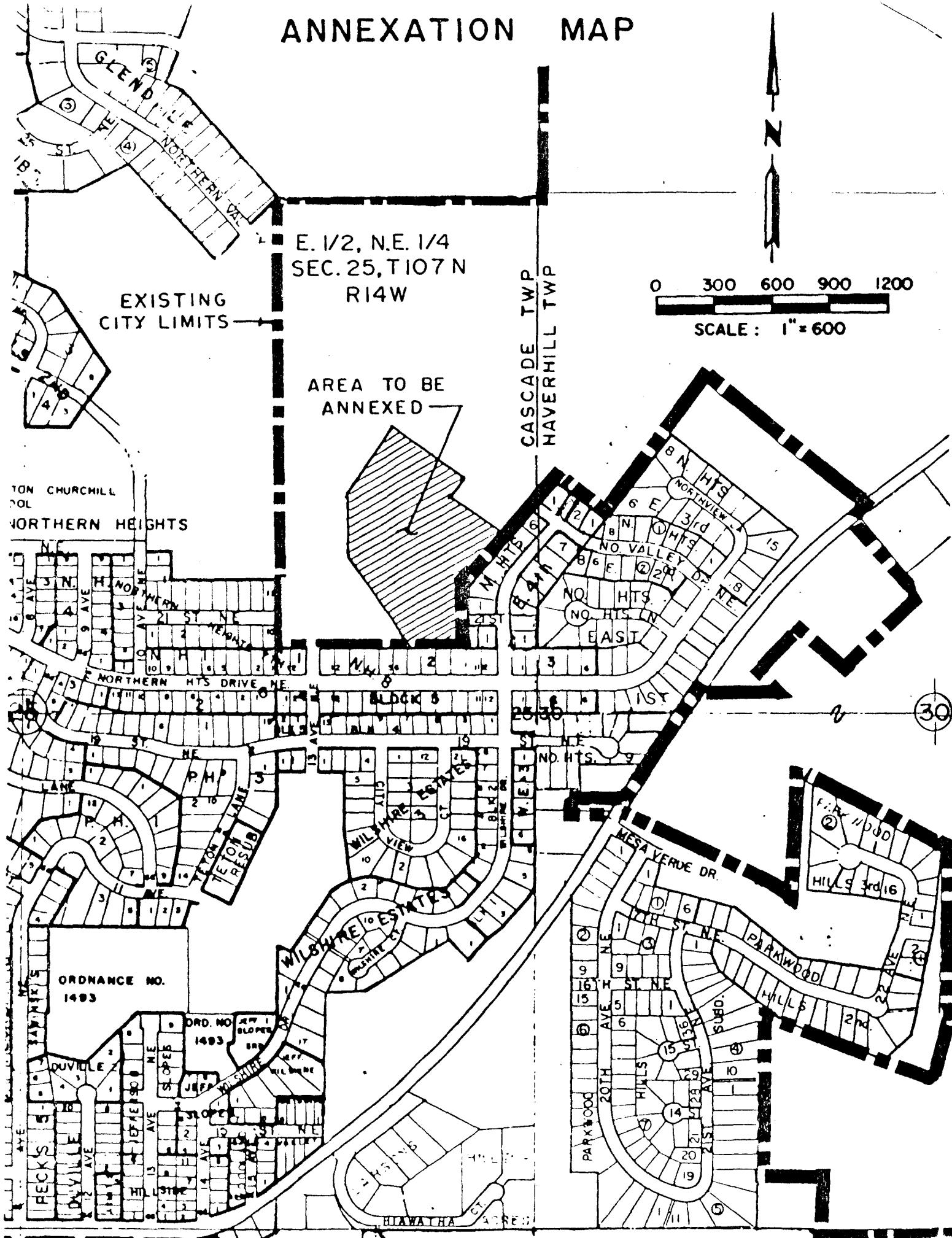

TON CHURCHILL
COL
NORTHERN HEIGHTS

ORDNANCE NO.
1493

ORD. NO. 1493

30