

AN ORDINANCE ANNEXING TO THE CITY OF ROCHESTER, MINNESOTA, CERTAIN PLATTED AND UNPLATTED LANDS IN THE SOUTHWEST QUARTER OF SECTIONS MARION TOWNSHIP, OLMSTED COUNTY, MINNESOTA.

THE COMMON COUNCIL OF THE CITY OF ROCHESTER DO ORDAIN:

Section 1. A petition has been filed with the Common Council of the City of Rochester, signed by the owner of land described herein, requesting the Common Council to annex said land to the City of Rochester. The land described in said petition for annexation is located in Marion Township, Olmsted County, Minnesota, and is described together with adjacent public road right-of-way as follows:

A part of the Southwest Quarter of the Northeast Quarter of Section 5, Township 106 North Range 13 West, Olmsted County, Minnesota, a part of Lot 25, Block 2, all of Lot 33, Block 2, Sunnydale Subdivision Blocks 1, 2 and 3, and a part of Vacated 7th Street SE, as platted in said Sunnydale Subdivision Blocks 1, 2 and 3 described as follows:

Commencing at the northwest corner of said Lot 25; thence South 00 degrees 59 minutes 30 seconds East, along the west line of said Lot 25, a distance of 251.50 feet to the south line of Sheffield Lane SE for a point of beginning; thence North 89 degrees 55 minutes 50 seconds East, along said south line, 271.99 feet thence northeasterly, 56.07 feet, along a said south line, along a curve concaved to the north, central angle of 06 degrees 39 minutes 04 seconds, radius of 483.00 feet, and chord of said curve bears North 86 degrees 36 minutes 18 seconds East, 56.04 feet to the easterly line, of said lot 25; thence South 18 degrees 14 minutes 40 seconds East, along said easterly line, 311.91 feet to the northwest corner of said Lot 33; thence North 61 degrees 00 minutes 07 seconds East, along the northwesterly line of said Lot 33 for a distance of 65.00 feet to the northeast corner thereof; thence South 31 degrees 54 minutes 00 seconds East, along the east line of said Lot 33; a distance of 110.00 feet; thence South 23 degrees 00 minutes 27 seconds East, along said east line, 100.40 feet to the southeast corner of said Lot 33; thence South 00 degrees 59 minutes 30 seconds East, parallel with the west line of the Northeast Quarter of said Section 5, a distance of 264.66 feet, more or less to the south line of said Northeast Quarter; thence westerly, along said south line, 605.06 feet to the southwest corner of said Northeast Quarter; thence North 00 degrees 59 minutes 30 seconds West, along the west line of said Northeast Quarter, 711.13 feet to a point which is South 89 degrees 55 minutes 50 seconds West of the point of beginning; thence North 89 degrees 55 minutes 50 seconds East, 33.00 feet to the point of beginning.

Containing 8.46 acres, more or less.

Said petition has also been filed with the Town Board of Marion Township, with the County Board of the County of Olmsted, and with the Minnesota Municipal Board, and the Town Board of Marion Township has notified the City that it has no objections to the annexation of the above-described land.

Section 2. The quantity of land included in said petition is approximately 8.47 acres in size.

Section 3. The Common Council of the City of Rochester does hereby determine that the land described in Section 1 abuts upon the present territorial limits of the City of Rochester, is so conditioned as to be properly subjected to municipal government, and the annexation of said land will be in the best interest of the City of Rochester and the land described.

Section 4. Therefore, the land described in Section 1 above is hereby annexed, added to and made a part of the City of Rochester, Minnesota, as effectually as if it had originally been a part thereof.

Section 5. Present and future owners of the lands annexed by this ordinance are hereby notified that in addition to the usual assessments, it is the intention of the Common Council to assess against benefited property all or a portion of the cost of any storm sewer, water tower, and trunk line sanitary sewer construction, heretofore or hereafter undertaken to serve the area annexed.

Section 6. Present and future owners of the lands annexed by this ordinance are hereby notified that it is the intention of the City of Rochester to provide electrical service through its Public Utility Department to any development on the lands annexed; and that said annexation by the City represents a commitment by the City to extend its electrical distribution facilities to serve said lands.

Section 7. This ordinance shall take effect and be in force from and after its official publication and from and after the filing of a certified copy hereof with the Minnesota Municipal board, the Marion Town Clerk, the County Auditor, and the Secretary of State.

PASSED AND ADOPTED BY THE COMMON COUNCIL OF THE CITY OF
ROCHESTER, MINNESOTA, THIS 22 DAY OF August, 1988.

Nancy B Selby
PRESIDENT OF SAID COMMON COUNCIL

ATTEST:

Carroll A. Drumm
CITY CLERK

Approved this 23 day of August, 1988.

[Signature]
MAYOR OF SAID CITY

(Seal of the City of
Rochester, Minnesota

STATE OF MINNESOTA)
)
COUNTY OF OLMSTED)

I, JUDY KAY SCHERR, DEPUTY CITY CLERK OF THE CITY OF ROCHESTER,
MINNESOTA, DO HEREBY CERTIFY THAT I HAVE COMPARED THE ATTACHED
COPY OF AN ORDINANCE WITH THE ORIGINAL ORDINANCE ON FILE IN MY
OFFICE AND THAT THE FOREGOING IS A TRUE AND CORRECT COPY OF THE
SAID ORDINANCE AND OF THE WHOLE THEREOF.

WITNESS MY HAND THIS 28TH DAY OF SEPTEMBER, 1988.

Judy Kay Scherr
Deputy City Clerk
City of Rochester, Minnesota

(Seal of the City of
Rochester, Minnesota)

REC'D BY SEP 29 1988
MMB

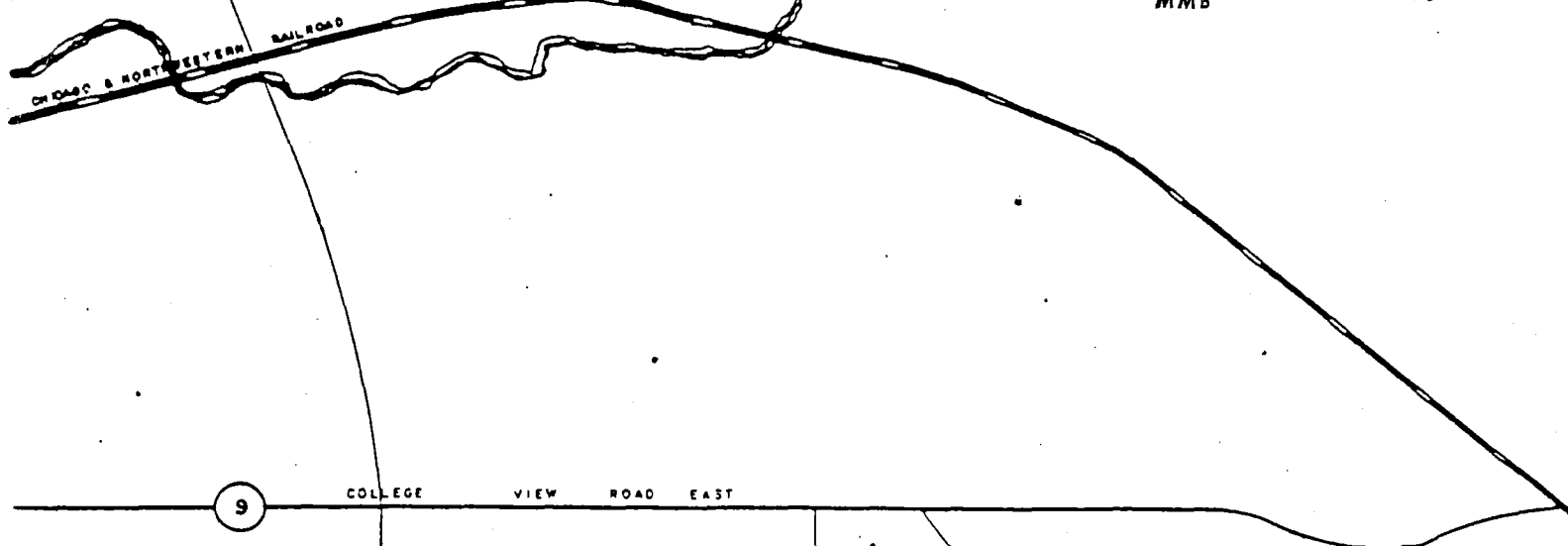

9 COLLEGE VIEW ROAD EAST

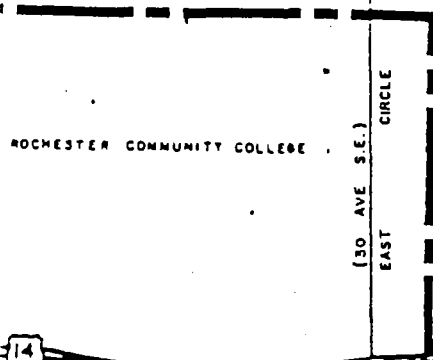

AREA PROPOSED FOR ANNEXATION
SEE ATTACHED SURVEYOR'S DRAWING
VACANT PROPERTY

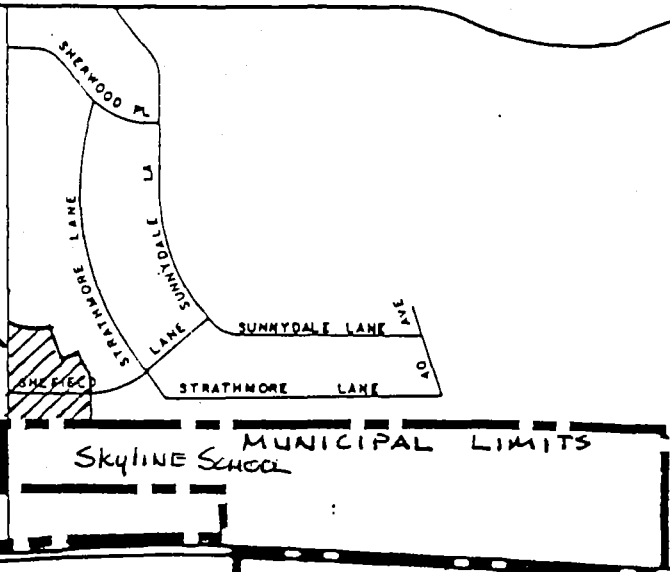

MUNICIPAL LIMITS
Skyline School

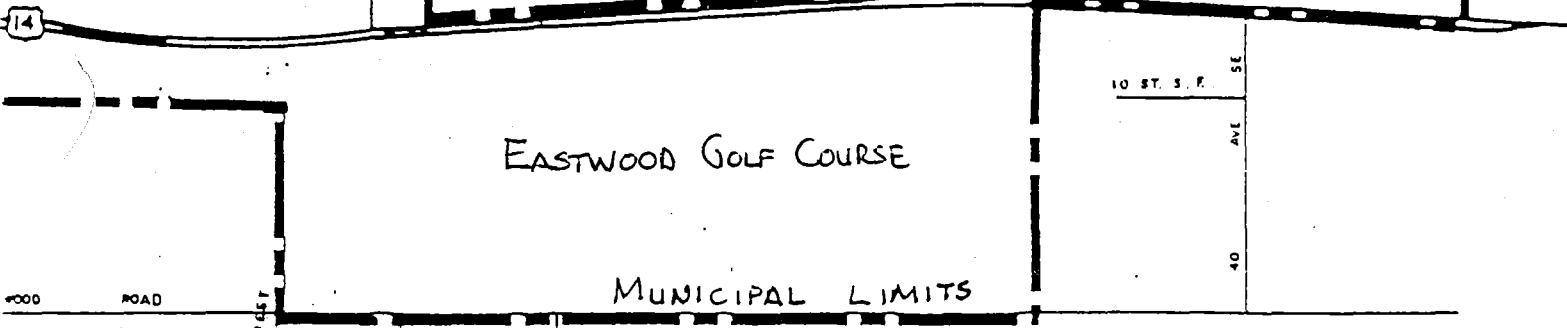

EASTWOOD GOLF COURSE

MUNICIPAL LIMITS

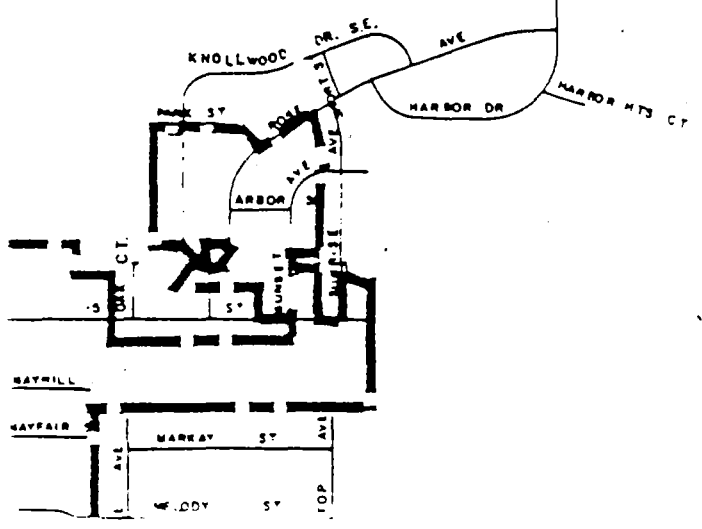

NORTH
No SCALE