

PETITION FOR ANNEXATION
BY ORDINANCE

WE the undersigned property owners hereby petition for annexation to the City of Red Wing the following described property for which we represent 100% ownership.

Land owned by Bernard F. and Agnes G. Gadiant (34-006-3100)

All of Southern Half of the Southeast Quarter of Section 6, Township 112 North, Range 14 West of Goodhue County, State of Minnesota consisting of approximately 80 acres.

Land Owned by Josephine Hanson (34-005-2200)

That part of Southern half of the Southwest Quarter of Section 5, Township 112 North, Range 14 West of Goodhue County, State of Minnesota, which lies West of Minnesota Trunk Highway #58 consisting of approximately 67.50 acres

SIGNED:

Bernard F. Gadiant
Bernard F. Gadiant

Agnes G. Gadiant
Agnes G. Gadiant

Josephine M. Hanson
Josephine Hanson

Sewage Disposal

RECD. BY MMB JUL 29 1987

Trailer Park

Twin Bluffs Jr High Sch

Calvary Cem

FOREST BOUNDARY

Radio Tower

Radio Tower (KCUE)

Red Wing Area Vocational Tech Institute

Water Tank

CORPORATE BOUNDARY



Hay

GRADE

12

HAY CREEK

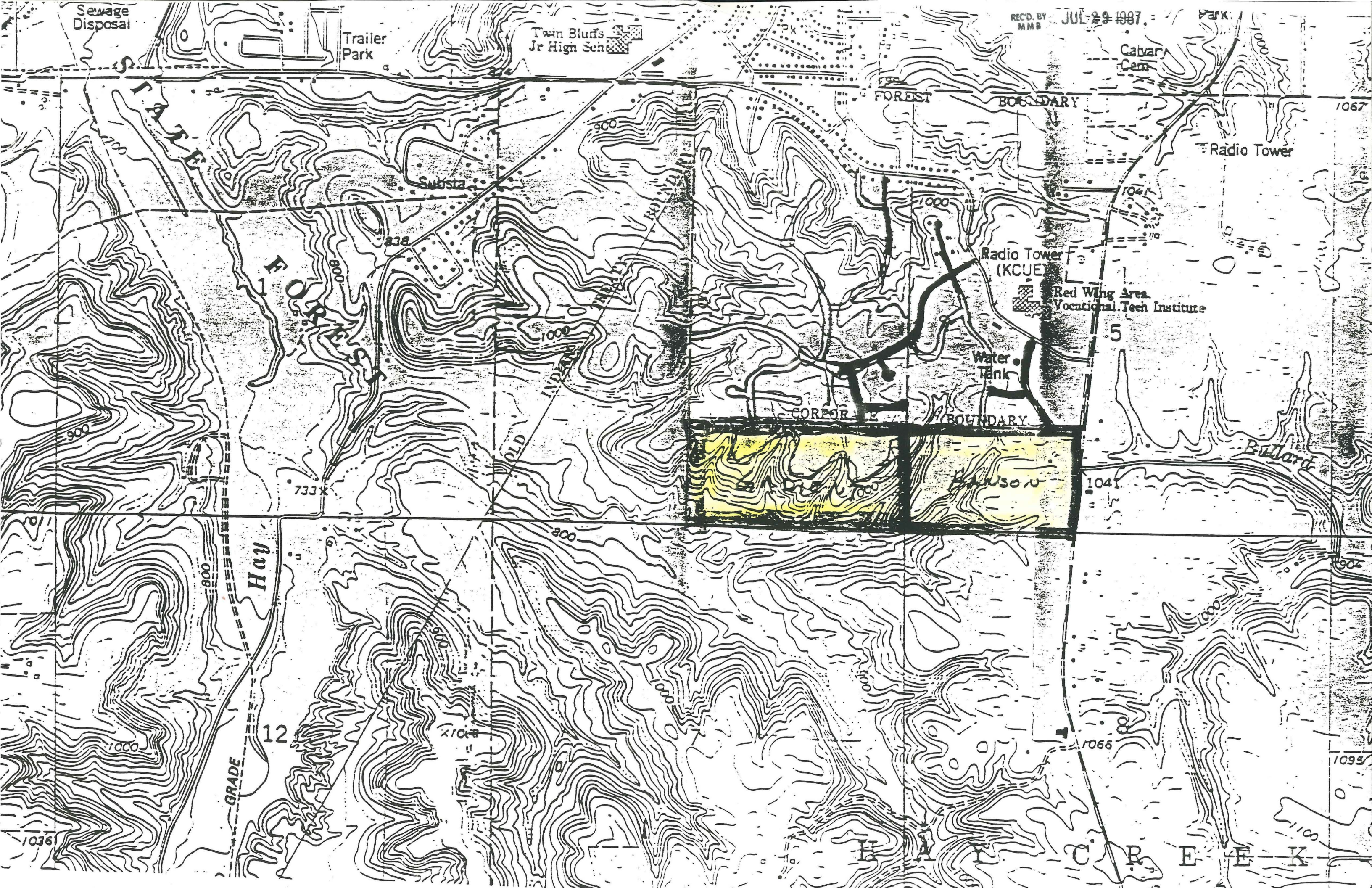

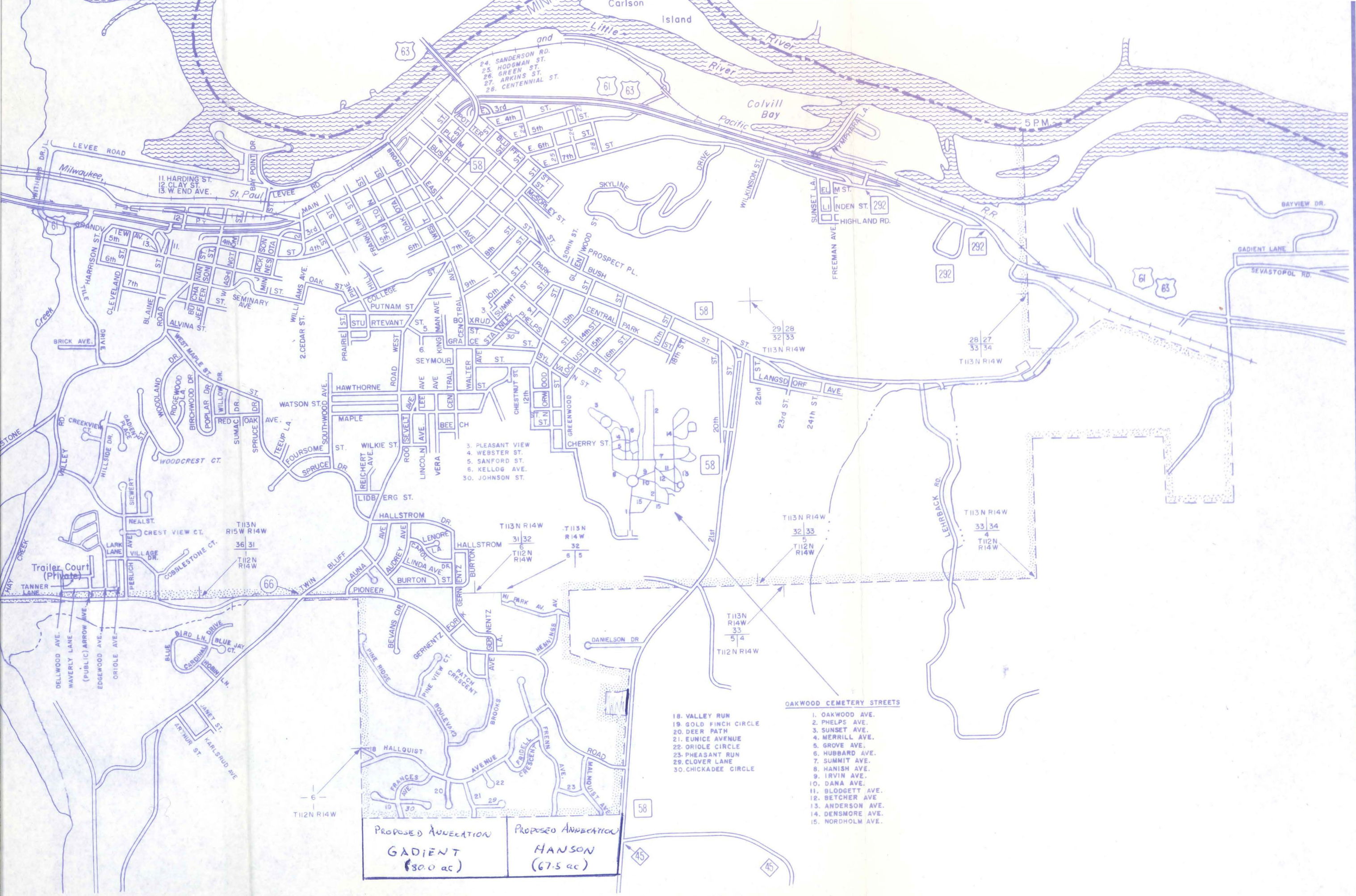

24. SANDERSON RD.
25. HODGMAN ST.
26. GREEN ST.
27. ARKINS ST.
28. CENTENNIAL ST.

3. PLEASANT VIEW
4. WEBSTER ST.
5. SANFORD ST.
6. KELLOG AVE.
30. JOHNSON ST.

18. VALLEY RUN
19. GOLD FINCH CIRCLE
20. DEER PATH
21. EUNICE AVENUE
22. ORIOLE CIRCLE
23. PHEASANT RUN
29. CLOVER LANE
30. CHICKADEE CIRCLE

OAKWOOD CEMETERY STREETS

- OAKWOOD AVE.
- PHELPS AVE.
- SUNSET AVE.
- MERRILL AVE.
- GROVE AVE.
- HUBBARD AVE.
- SUMMIT AVE.
- HANISH AVE.
- IRVIN AVE.
- DANA AVE.
- BLODGETT AVE.
- BETCHER AVE.
- ANDERSON AVE.
- DENSMORE AVE.
- NORDHOLM AVE.

PROPOSED ANNEXATION
GADIANT
(30.0 ac)

PROPOSED ANNEXATION
HANSON
(67.5 ac)