

JUN 08 1987

RESOLUTION NO. 87-33

IN THE MATTER OF THE PETITION OF THE CITY OF WASECA, MINNESOTA  
TO ANNEX CERTAIN ADJOINING UNINCORPORATED TERRITORY TO THE CITY

TO THE MINNESOTA MUNICIPAL BOARD:

WHEREAS, certain territory described below is not presently included within the incorporated limits of any city; and

WHEREAS, this territory abuts upon the city limits at the (boundaries) thereof and is or is about to become urban or suburban in character; that the territory is required to protect the public health, safety, and welfare; that annexation would be in the best interest of the territory proposed for annexation.

BE IT RESOLVED BY THE CITY COUNCIL OF WASECA, MINNESOTA:

1. The City Council hereby determines (1) that the territory described below abuts upon the city limits and is or is about to become urban or suburban in character; and (2) that none of the territory is now included within the limits of any city; (3) that the territory is required to protect the public health, safety, and welfare; (4) that annexation would be in the best interest of the territory proposed for annexation.
2. The Council hereby declares its intention to annex the following territory to the City of Waseca as described in the attached Exhibit "A" and "B".
3. The names of all parties entitled to notice under M.S. Section 414.09 are:

Robert Peterson  
Waseca County Board of Commissioners  
Waseca County Courthouse  
Waseca, Minnesota 56093

Al Ruhland  
Township Clerk  
Woodville Township  
Route #3  
Waseca, Minnesota 56093

Terrence Stone  
Regione Nine  
P.O. Box 3367  
Mankato, Minnesota 56001

Lloyd Schoenfeld  
Chairman  
St. Mary's Township  
Route #1  
Waseca, Minnesota 56093

REC'D. BY  
MMB

JUN 08 1987

RESOLUTION NO. 87-33  
CONTINUED:

Adopted by the City Council of the City of Waseca, Minnesota this 2nd day of June, 1987.

*Arny "Doc" Hall*

MAYOR

*Timothy Madigan*

CITY MANAGER

ATTEST:

*Robert J. Lamm*  
CITY CLERK

## EXHIBIT "A"

PROPERTY PROPOSED FOR ANNEXATION BY THE  
CITY OF WASECA, MINNESOTA

JUNE, 1987

S½ of Section 4, Twp 107-N, Range 22-W

S½ of Section 5, Twp 107-N, Range 22-W

S½ of Section 6, Twp 107-N, Range 22-W

Section 7, Twp 107-N, Range 22-W

Section 8, Twp 107-N, Range 22-W

E½ of Section 9, Twp 107-N, Range 22-W

W 332.67 ft of NW¼ of NW¼, Section 10, Twp 107-N, Range 22-W

The Knoll, Waseca County, Minnesota

Section 16, Twp 107-N, Range 22-W

SE¼ of Section 17, Twp 107-N, Range 22-W

Commencing at the Northwest corner of Government Lot 4 in Section 18, Township 107 North of Range 22 West, running thence South 22½ rods, thence East 36 ¾ rods to Loon Lake, thence in a Northwesterly direction along the shore line of said Loon Lake to a point directly 11 rods East of the point of beginning, thence West 11 rods to the point of beginning, in Waseca County, Minnesota, except for the following described property: beginning at a point 242.28 ft South and 33.9 ft South 76° 30' East of the NW corner Section 18; thence South 76° 30' East 153 ft, thence North 77.13 ft, thence South 76° 30' East 124.35 ft to edge of Loon Lake, thence Southeasterly along the shore of Loon Lake to the North line of U.S. Hwy 14 right of way, thence North 76° 30' West 606.37 ft, thence North 100 ft to point of beginning. Containing 1.37 ac.

E½ of the NE¼ of Section 19, Twp 107-N, Range 22-W

N½ of Section 20, Twp 107-N, Range 22-W

N½ of Section 21, Twp 107-N, Range 22-W

W 28 ac. of NE¼ of SW¼ of Section 21, Twp 107-N, Range 22-W  
(Woodville Estates #1 and #2)

EXHIBIT "B"  
PROPERTY PROPOSED FOR ANNEXATION OF THE  
CITY OF WASECA, MINNESOTA

REC'D. BY  
MMB

JUN 08 1987

JUNE, 1987

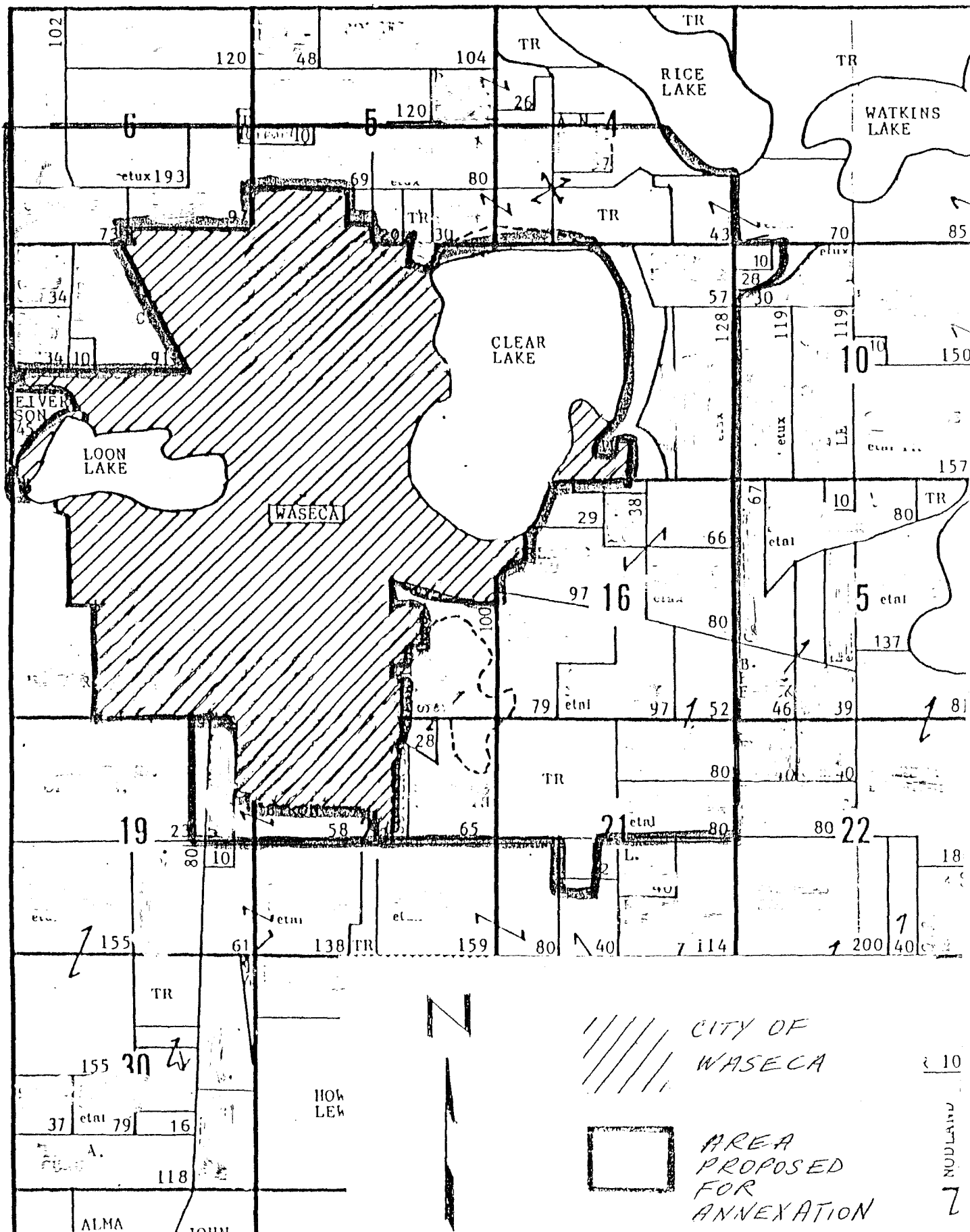



# WASECA

## URBAN/RURAL FRINGE AREA

WASECA COUNTY, MN

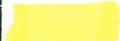
## ORDERLY ANNEXATION AREA : WOODVILLE TOWNSHIP

 PRESENT  
CITY BOUNDARY

 PROPOSED  
ADJUSTED BOUNDARY

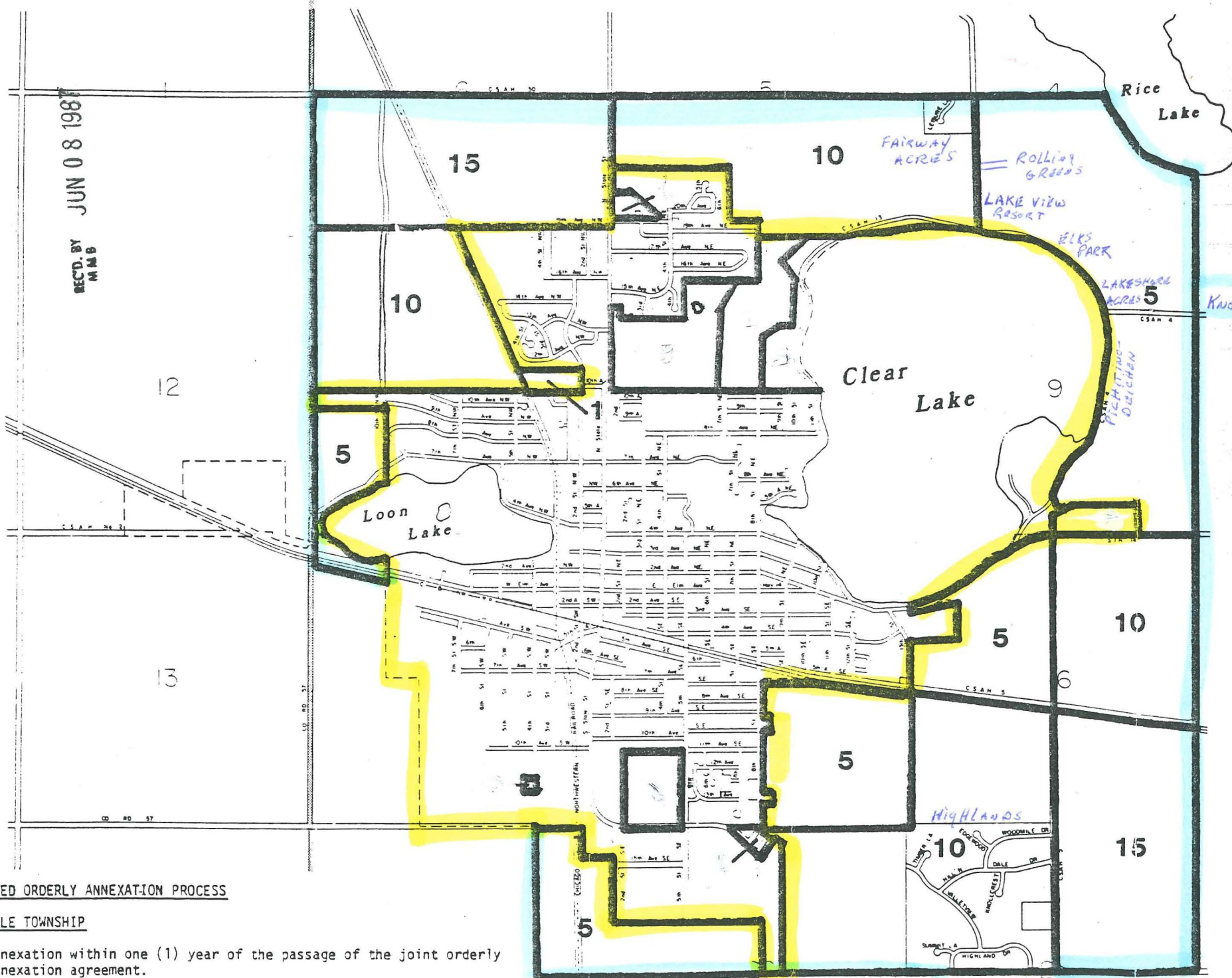

### SUGGESTED ORDERLY ANNEXATION PROCESS

#### WOODVILLE TOWNSHIP

- 1 = Annexation within one (1) year of the passage of the joint orderly annexation agreement.
- 5 = No annexations within five (5) years of passage of the joint orderly annexation agreement, unless requested by a specified percentage of the property or a development request is presented.
- 10 = No annexations within ten (10) years of passage of the joint orderly

JULY 1979