

REC'D. BY FEB 01 1988
M M B

ORDINANCE NO. 53, 2ND SERIES

AN ORDINANCE ANNEXING CERTAIN PARCELS OF LAND TO THE CITY OF INTERNATIONAL FALLS AND PLACING THE SAME WITHIN THE JURISDICTION OF SAID CITY.

THE CITY COUNCIL OF THE CITY OF INTERNATIONAL FALLS, MINNESOTA DOES ORDAIN AS FOLLOWS:

Section 1. That the following parcels of land described in Section 2 have been petitioned for annexation by the City of International Falls by all of the landowners.

Section 2. That after due consideration, the City Council has deemed it to be in the best interest of the City that said land be annexed to and become a part of said City, said property being described as follows:

- A. PARCEL ONE A: Government Lots 1, 2, 3 and that part of 4 lying in the Northwest Quarter of the Northwest Quarter (NW $\frac{1}{4}$ - NW $\frac{1}{4}$) of Section Thirty-five, Township Seventy-one North; Range Twenty-four West (Sec. 35, T-71-N, R-24-W) containing approximately 89.53 acres.
- B. PARCEL ONE B.: The Southeast Quarter of the Northeast Quarter (SE $\frac{1}{4}$ - NE $\frac{1}{4}$), Section 35, Township 71 North, Range 24 West, less that part lying southerly of Trunk Highway No. 11 as now located and established and westerly of the Second Creek; which lies northerly of a line run parallel with and distant 475 feet southerly of the following described line: From a point on the east line of said Section 35 distant 422.4 feet south of the meander corner, located near the south boundary of the Rainy River; run northeasterly at an angle of 64° 32' with said east section line for 758.2 feet to the point of beginning of the line to be described; thence run southwesterly on the last described course for 100 feet; thence deflect to the right on a ten chord spiral curve of decreasing radius (spiral angle 2° 00') for 200 feet; thence deflect to the right on a 2° 00' circular curve (delta angle 21° 57' 30") for 1097.9 feet; thence deflect to the right on a ten chord spiral curve of increasing radius (spiral angle 2° 00') having a length of 200 feet for 49 feet and there terminating. PARCEL TWO B.: the Northeast Quarter of the Southeast Quarter (NE $\frac{1}{4}$ - SE $\frac{1}{4}$), and the North one-half of the Southeast Quarter of the Southeast Quarter (N $\frac{1}{2}$ - SE $\frac{1}{4}$ - SE $\frac{1}{4}$) and the Trunk Highway 332 Right-of-way located in the South One-half of the Southeast Quarter of the Southeast Quarter (S $\frac{1}{2}$ - SE $\frac{1}{4}$ - SE $\frac{1}{4}$) both parcels being in Section Thirty-five, Township Seventy-one North, Range Twenty-four West (Sec. 35, T-71-N, R-24-W) containing a total of approximately 97.49 acres.

C. PARCEL ONE C.: described as follows: that part of Lot 35, Auditor's Plat No. 2 in Government Lot 1, Section 36, Township 71 North, Range 24 West of the Fourth Principal Meridian described as follows: commencing at the Northeast Corner of said Lot 35; thence South 44° 56' 06" West, bearing assumed, along the southeasterly line of said Lot 35, also being the northwesterly right-of-way of Koochiching C.S.A.H. No. 21, a distance of 568.06 feet to the point of beginning of the land to be described; thence continue South 44° 56' 06" West along said southeasterly line a distance of 390 feet, more or less, to the intersection with the centerline of the creek, being about 835 feet northeasterly of the southwest corner of Government Lot 1 of said Section 36; thence northwesterly along said centerline to the shoreline of Rainy River; thence northeasterly along said shoreline a distance of 400 feet, more or less, to the intersection with a line bearing North 45° 03' 54" West from the point of beginning; thence South 45° 03' 54" East a distance of 229 feet, more or less, to the point of beginning and there terminating. Containing 1.8 acres, more or less; PARCEL TWO C.: described as follows: That part of Lot 35, Auditor's Plat No. 2 in Government Lot 1, Section 36, Township 71 North, Range 24 West, West of Parcel One C. described herein, containing 5.2 acres, more or less. Parcel One C. and Parcel Two C. total approximately 7 acres.

Section 3. That accordingly, said tracts of land described, herein, be and they are, annexed to the City of International Falls and that said tracts of land hereby are part of and subject to the jurisdiction of the City of International Falls, Minnesota, and are zoned in accordance with the City Code as follows:

Parcel One A - M-2 Manufacturing
Parcel One B and Two B - M-2 Manufacturing
Parcel One C and Two C - R-2 Residential

Section 4. City Code Chapter 1 entitled "GENERAL PROVISIONS AND DEFINITIONS APPLICABLE TO THE ENTIRE CITY CODE INCLUDING PENALTY FOR VIOLATION", and City Code Section 1.03, "VIOLATION A MISDEMEANOR", are hereby adopted by reference as though repeated verbatim herein.

Section 5. This Ordinance will supersede and replace Ordinance No. 44, 2nd Series, passed July 13, 1987.

Section 6. After adoption, signing and attestation, this Ordinance shall be published once in the official newspaper of the City and shall be in effect on and after the day following such publication.

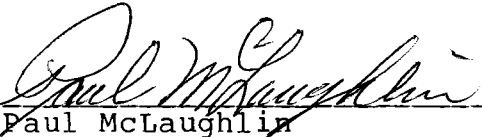

Paul McLaughlin
President of Council

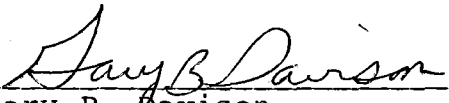
Attest:

Gary B. Davison
City Clerk/Treasurer

Passed its first reading this 14th day of December, 1987.
Passed its second reading this 28th day of December, 1987.
Passed its third reading this 11th day of January, 1988.

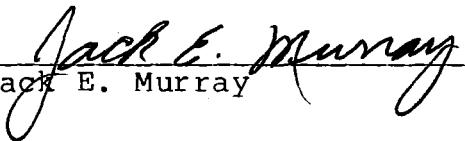
I, Jack E. Murray, hereby approve the foregoing Ordinance this 11th day of January, 1988.

Jack E. Murray

Published:

SCALE
1" = 600'

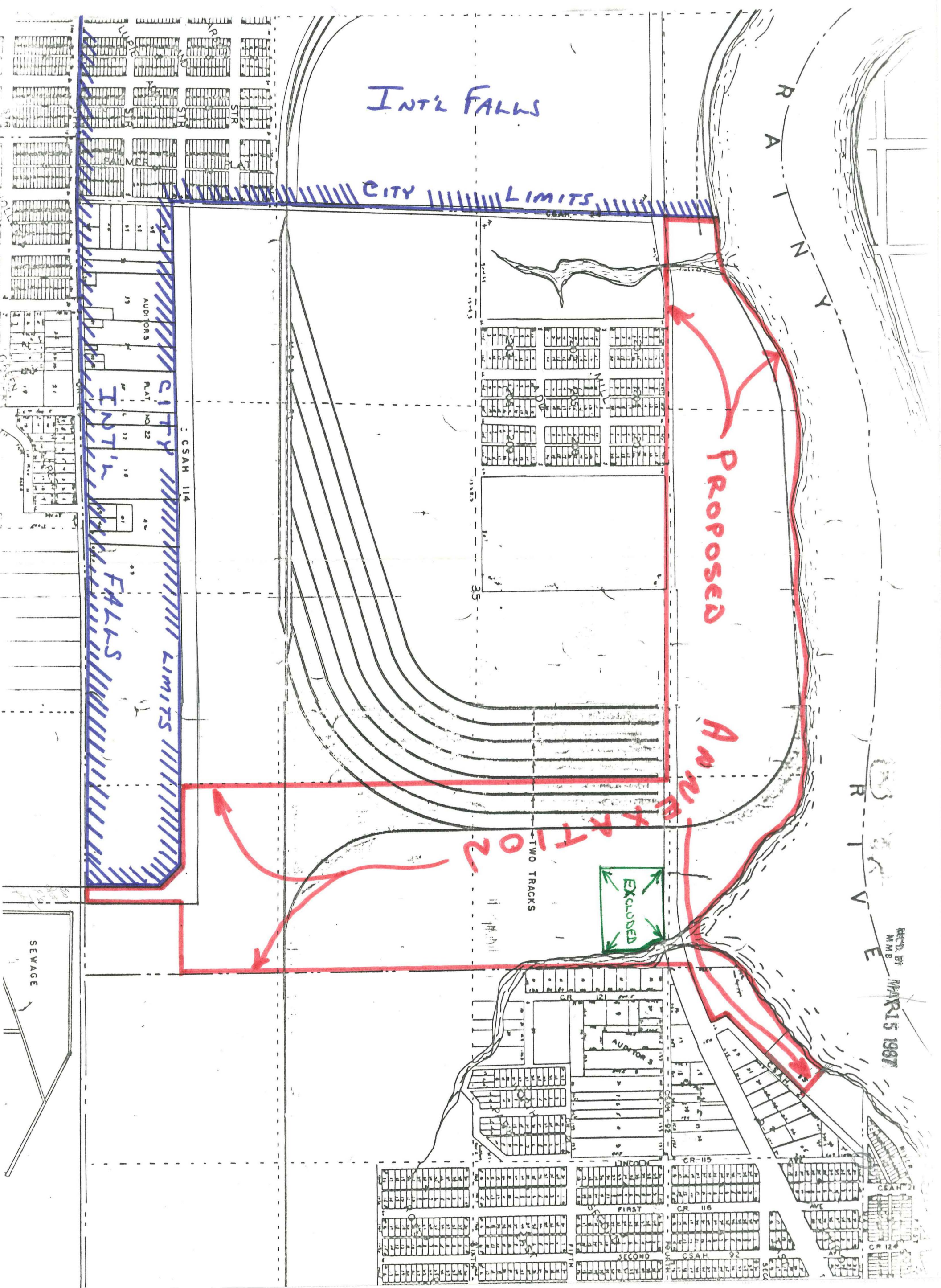

RECD. BY
M.M.B.
MAY 15 1987