

0-86-1124-230

AN ORDINANCE TO ANNEX CERTAIN
PROPERTY TO THE CITY OF MANKATO PER
MINNESOTA STATUTES 414.033, SUBDIVISION 2(b)

WHEREAS, certain property described below has been found to not have been included in a previous annexation procedure and is not within the corporate limits of any incorporated city, village, or borough; and

WHEREAS, said property is completely surrounded by land already included within the corporate limits of the City of Mankato, does not exceed 40 acres and provides access right-of-way to property already annexed to the City of Mankato;

THE CITY OF MANKATO HEREBY FINDS THAT:

1. The land described herein is surrounded by the City.
2. The land described herein was thought to have been previously annexed to the City of Mankato.
3. That said described property presents a non-incorporated island of property surrounded by the City.
4. That annexation of this parcel will enhance the City's ability to plan for utilities and streets in this part of the City.

NOW, THEREFORE, THE CITY OF MANKATO HEREBY ORDAINS that the corporate limits of the City are hereby extended to include the land described as follows and the same is hereby annexed to and included within the City as effectively as if it had originally been part thereof:

That part of the Northwest Quarter of the Southeast Quarter (NW 1/4, SE 1/4), Section 19, Township 108 North, Range 26 West, described as follows:

Beginning at the Northeast corner of the Northwest Quarter of the Southeast Quarter of said Section 19, thence 38 feet west; thence 1,039.5 feet south; thence 38 feet east; thence 1,039.5 feet North to the point of beginning. Said property containing .90 acres.

The City Clerk is hereby directed to file certified copies of this ordinance with the Minnesota Municipal Board, the Secretary of State, the Blue Earth County Auditor and Mankato Township.

This ordinance shall take effect 30 days after the date of its passage and due publication and filing thereof.

Adopted this 24th day of November, 1986.

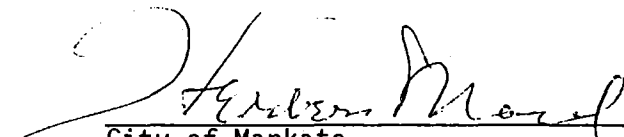

 City of Mankato
 Herbert Mocol, Mayor

ATTEST: 

 Carla Raberge
 City Clerk

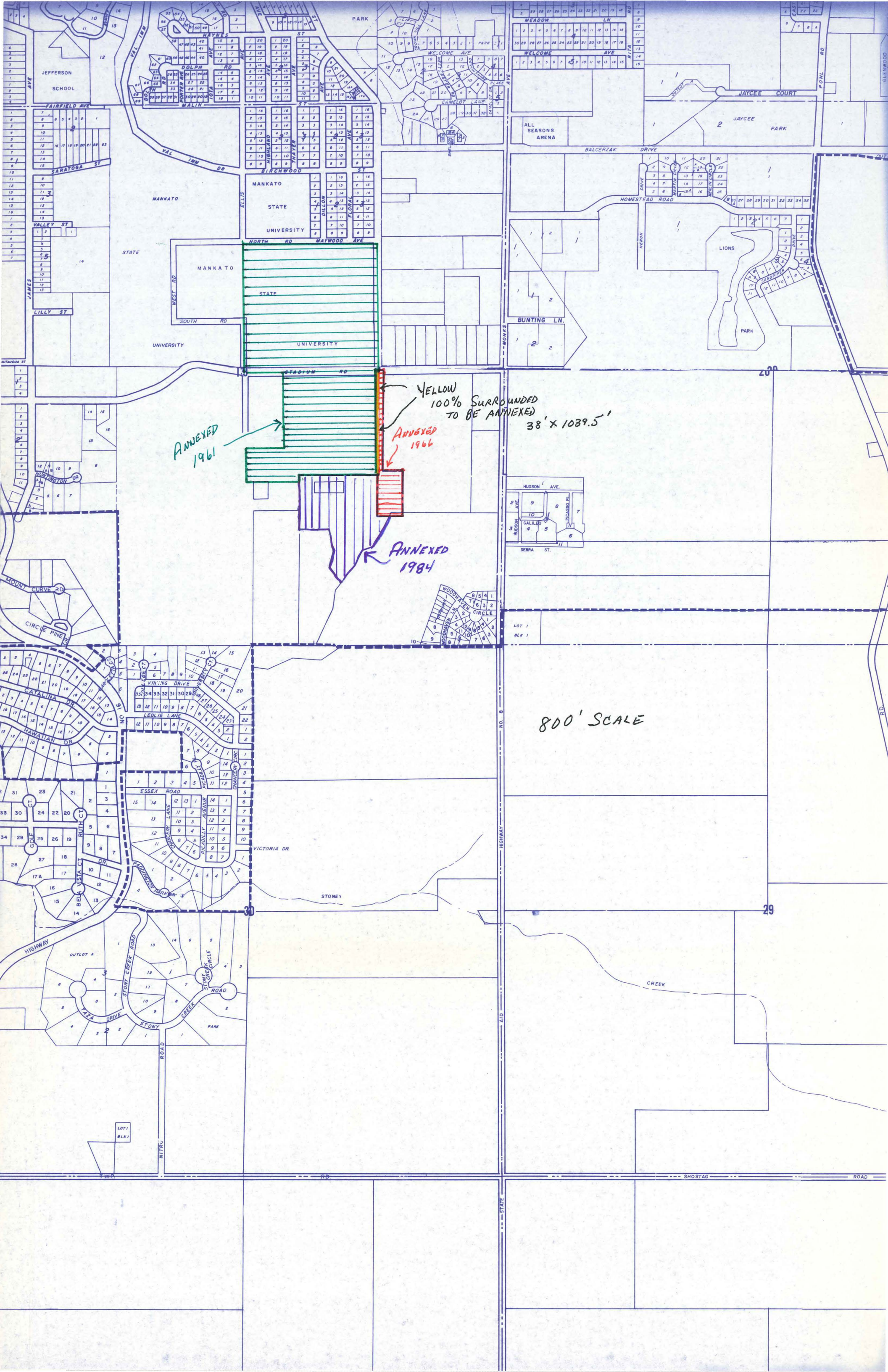

ANNEXED
1961

YELLOW
100% SURROUNDED
TO BE ANNEXED
38' X 1039.5'

ANNEXED
1966

ANNEXED
1984

800' SCALE

LOT 1
BLK 1

LOT 1
BLK 1

29

20

PARK

JEFFERSON
SCHOOL

MANKATO

MANKATO
STATE
UNIVERSITY

MANKATO
UNIVERSITY

ALL SEASONS
ARENA

LIONS
PARK

BUNTING LN.

HUDSON AVE.
SIERRA ST.

FAIRFIELD AVE

SARATOGA ST

VALLEY ST

LILLY ST

HAWKINGTON DR

MOUNTAIN CURVE RD

CIRCLE PINES

CATALINA DR

HAWAIIAN DR

ESSEX ROAD

BEA VISTA CT

STONY CREEK ROAD

STONY CREEK ROAD

STONY CREEK ROAD

STONY CREEK ROAD

STONY CREEK ROAD

STONY CREEK ROAD

STONY CREEK ROAD

STONY CREEK ROAD

VIA VINGS DRIVE

LEDLIE LANE

ESSEX ROAD

BEA VISTA CT

STONY CREEK ROAD

STONY CREEK ROAD

STONY CREEK ROAD

STONY CREEK ROAD

STONY CREEK ROAD

STONY CREEK ROAD

STONY CREEK ROAD

STONY CREEK ROAD

VIA VINGS DRIVE

LEDLIE LANE

ESSEX ROAD

BEA VISTA CT

STONY CREEK ROAD

STONY CREEK ROAD

STONY CREEK ROAD

STONY CREEK ROAD

STONY CREEK ROAD

STONY CREEK ROAD

STONY CREEK ROAD

STONY CREEK ROAD

VIA VINGS DRIVE

LEDLIE LANE

ESSEX ROAD

BEA VISTA CT

STONY CREEK ROAD

STONY CREEK ROAD

STONY CREEK ROAD

STONY CREEK ROAD

STONY CREEK ROAD

STONY CREEK ROAD

STONY CREEK ROAD

STONY CREEK ROAD

VIA VINGS DRIVE

LEDLIE LANE

ESSEX ROAD

BEA VISTA CT

STONY CREEK ROAD

STONY CREEK ROAD

STONY CREEK ROAD

STONY CREEK ROAD

STONY CREEK ROAD

STONY CREEK ROAD

STONY CREEK ROAD

STONY CREEK ROAD

VIA VINGS DRIVE

LEDLIE LANE

ESSEX ROAD

BEA VISTA CT

STONY CREEK ROAD

STONY CREEK ROAD

STONY CREEK ROAD

STONY CREEK ROAD

STONY CREEK ROAD

STONY CREEK ROAD

STONY CREEK ROAD

STONY CREEK ROAD

VIA VINGS DRIVE

LEDLIE LANE

ESSEX ROAD

BEA VISTA CT

STONY CREEK ROAD

STONY CREEK ROAD

STONY CREEK ROAD

STONY CREEK ROAD

STONY CREEK ROAD

STONY CREEK ROAD

STONY CREEK ROAD

STONY CREEK ROAD