

ORDINANCE NO.

2504

AN ORDINANCE ANNEXING TO THE CITY OF
ROCHESTER, MINNESOTA, CERTAIN
UNPLATTED LAND IN HAVERHILL
TOWNSHIP, OLNSTED COUNTY, MINNESOTA.

THE COMMON COUNCIL OF THE CITY OF ROCHESTER DO ORDAIN:

Section 1. A petition has been filed with the Common Council of the City of Rochester, signed by the owners of land described herein, requesting the Common Council to annex said land to the City of Rochester. The land described in said petition for annexation is located in the Northwest Quarter of Section 30 of Haverhill Township, Olmsted County, Minnesota, and is described as follows:

That part of the Northwest Quarter of Section 30, Township 107 North, Range 13 West, Olmsted County, Minnesota, described as follows:

Commencing at the southwest corner of said Northwest Quarter; thence northerly on an assumed azimuth from north of 00 degrees 20 minutes 08 seconds along the west line of said northwest Quarter and the west line of Northern Heights East First Subdivision 532.84 feet; thence northeasterly 45 degrees 20 minutes 08 seconds azimuth along the northwesterly line of Northern Heights East First Subdivision 219.20 feet to the point of beginning; thence northeasterly 35 degrees 07 minutes 40 seconds azimuth 131.55 feet; thence northeasterly 36 degrees 51 minutes 00 seconds azimuth 1080.00 feet; thence southeasterly 126 degrees 51 minutes 00 seconds azimuth 1011.10 feet to the center line of Viola Road N.E. (C.S.A.H. No. 2); thence southwesterly 232 degrees 25 minutes 35 seconds azimuth along said center line 72.91 feet; thence northwesterly 322 degrees 25 minutes 35 seconds azimuth 200.00 feet; thence southwesterly 232 degrees 25 minutes 35 seconds azimuth 110.00 feet; thence southwesterly 382.56 feet on a tangential curve concave to the southeast having a radius of 2112.76 feet with a central angle of 10 degrees 22 minutes 29 seconds; thence southwesterly 222 degrees 03 minutes 06 seconds azimuth 201.14 feet; thence southwesterly 64.72 feet on a tangential curve concave to the southeast having a radius of 3081.65 feet with a central angle of 01 degrees 12 minutes 12 seconds to the northeasterly line of Northern Heights East First Subdivision, thence northwesterly 306 degrees 51 minutes 00 seconds azimuth

along said northeasterly line of 169.28 feet; thence southwesterly 216 degrees 51 minutes 00 seconds azimuth along the northwesterly line of Northern Heights East First Subdivision 196.25 feet; thence northwesterly 306 degrees 51 minutes 00 seconds azimuth along the northeasterly line of Northern Heights First Subdivision 36.86 feet; thence westerly 288 degrees 29 minutes 04 seconds azimuth along the northerly line of Northern Heights First Subdivision 117.13 feet; thence westerly 270 degrees 07 minutes 08 seconds azimuth along said northerly line 161.38 feet; thence westerly 279 degrees 10 minutes 40 seconds azimuth along said northerly line 255.66 feet to the point of beginning.

Said petition has also been filed with the Town Board of Haverhill Township, with the County Board of the County of Olmsted, and with the Minnesota Municipal Commission, and the Town Board of Haverhill Township has notified the City that it has no objections to the annexation of the above-described land.

Section 2. The quantity of land included in said petition is approximately 16.50 acres in size.

Section 3. The Common Council of the City of Rochester does hereby determine that the land described in Section 1 abuts upon the present territorial limits of the City of Rochester, is so conditioned as to be properly subjected to municipal government, and the annexation of said land will be in the best interest of the City of Rochester and the land described.

Section 4. Therefore, the land described in Section 1 above is hereby annexed, added to and made a part of the City of Rochester, Minnesota, as effectually as if it had originally been a part thereof.

Section 5. Present and future owners of the area annexed by this ordinance are hereby notified that in addition to the usual assessments, it is the intention of the Common Council to assess against benefited property all or a portion of the cost of any storm sewer, water tower, and trunk line sanitary sewer construction, heretofore or hereafter undertaken to serve the area annexed.

Section 6. This ordinance shall take effect and be in force from and after its official publication and from and after the filing of a certified copy hereof with the Minnesota Municipal Board, the Haverhill Town Clerk, the County Auditor, and the Secretary of State.

PASSED AND ADOPTED BY THE COMMON COUNCIL OF THE CITY OF
ROCHESTER, MINNESOTA, THIS 21 DAY OF April, 1986.

R. J. Poth
PRESIDENT OF SAID COMMON COUNCIL

ATTEST: Carol A. Grimm
CITY CLERK

Approved this 22nd day of April, 1986.

Chuck Kazan
MAYOR OF SAID CITY

(Seal of the City of
Rochester, Minnesota)

REC'D. BY
MAR 18 1986

BERRY VALLEY

ROCHESTER CITY LIMITS

Proposed Annexation

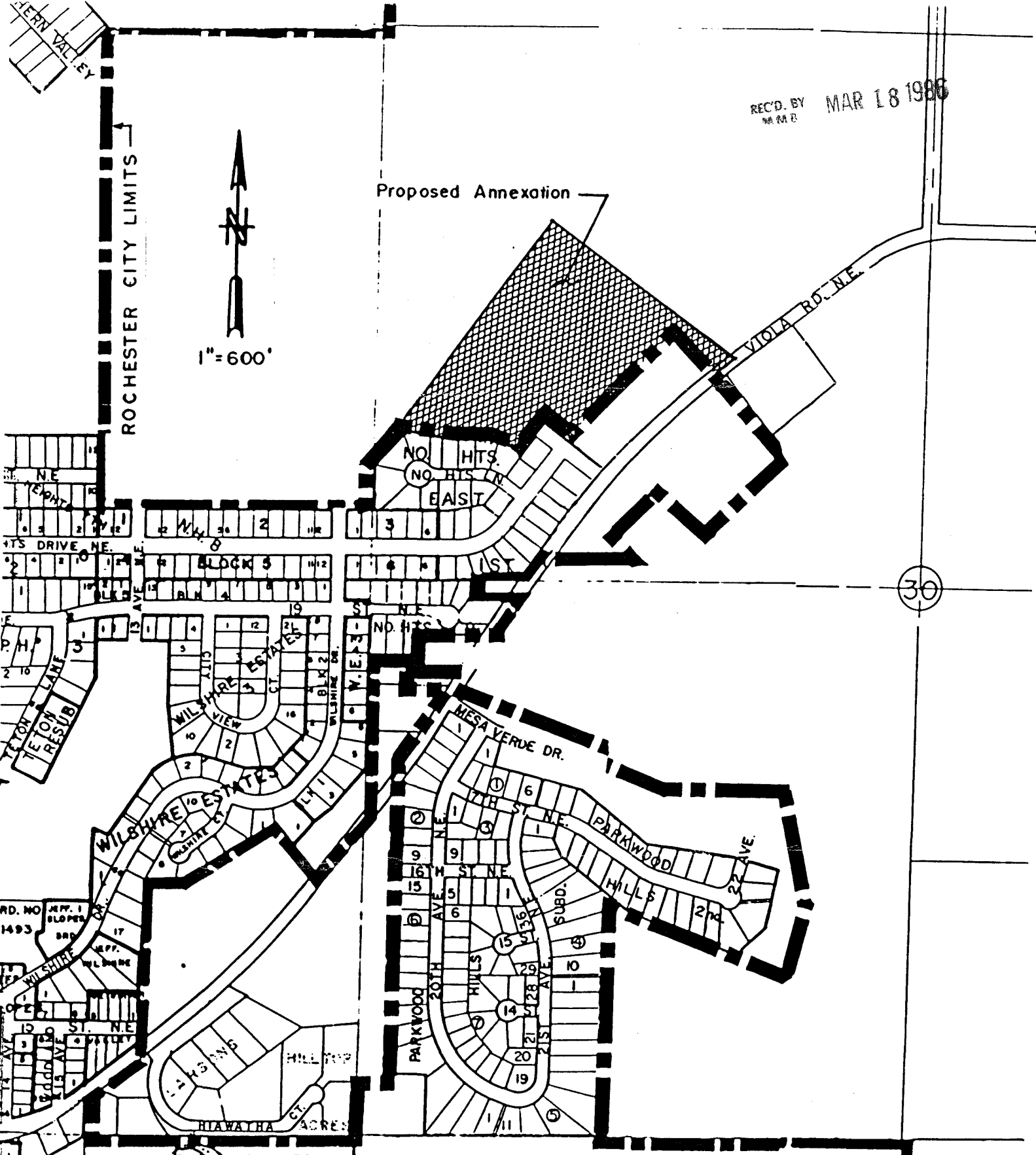

ANNEXATION MAP

MARCH 13, 1986



PREPARED BY
YAGGY ASSOCIATES, INC.
CONSULTING ENGINEERS ■ PLANNERS ■ SURVEYORS
ROCHESTER MINNESOTA MASON CITY IOWA

REC'D. BY MAR 18 1986

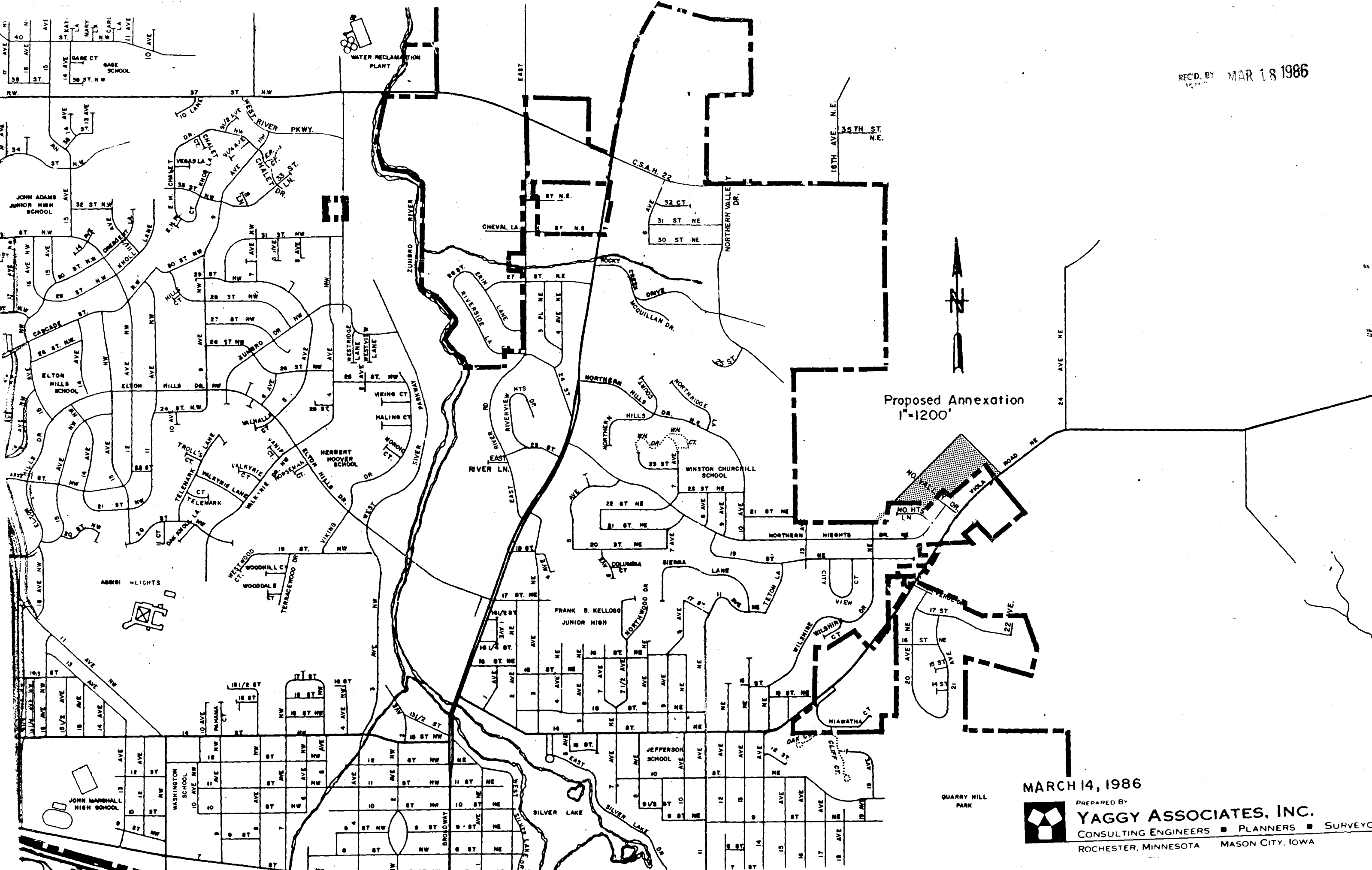

Proposed Annexation
1"=1200'

MARCH 14, 1986



PREPARED BY
YAGGY ASSOCIATES, INC.
CONSULTING ENGINEERS ■ PLANNERS ■ SURVEYORS
ROCHESTER, MINNESOTA ■ MASON CITY, IOWA