

PETITION FOR ANNEXATION OF
PLATTED LAND OR UNPLATTED LAND OF 200 ACRES OR LESS
MINNESOTA STATUTES, SECTION 414.033 SUBD. 5

To: Common Council
City Hall
Rochester, MN 55901

REC'D. BY MAR 18 1986
MMP

The undersigned being (all) (a majority) of the owners in number of the land hereinafter described which abuts the City of Rochester, petition the Common Council to annex said land to the City of Rochester: (If more space is needed, attach additional sheet)

Description: See Attached

Reason for Annexation: Residential Development

Total Number of Owners: 1
"Owners" include each fee holder, contract for deed purchaser, joint tenant, and tenant in common.

Area of Land to be Annexed in Acres:
Platted 16.50 Unplatted 0 Total 16.45

Existing Population of Area to be Annexed: _____

IN WITNESS WHEREOF we have subscribed to this petition of this _____ day of _____, 19____.

Respectfully submitted, (Additional names may be put on attached sheet if necessary.)

Payne Company 799 Sierra Lane N.E., Rochester, MN 55904
(Owner) (Address)

(Owner) (Address)

- DISTRIBUTION:
City Clerk (White Copy)
Consolidated Planning Department (Yellow Copy)
Township Board (Blue Copy)
Olmsted County Board (Green Copy)
Minnesota Municipal Commission (Pink Copy)
Petitioner (Goldenrod Copy)

ANNEXATION: FORM NO. 1

Petition for Annexation

March 13, 1986
1411DES.TXT

ANNEXATION DESCRIPTION

REC'D BY MAR 18 1986
FILE

That part of the Northwest Quarter of Section 30, Township 107 North, Range 13 West, Olmsted County, Minnesota, described as follows:

Commencing at the southwest corner of said Northwest Quarter; thence northerly on an assumed azimuth from north of 00 degrees 20 minutes 08 seconds along the west line of said northwest Quarter and the west line of Northern Heights East First Subdivision 532.84 feet; thence northeasterly 45 degrees 20 minutes 08 seconds azimuth along the northwesterly line of Northern Heights East First Subdivision 219.20 feet to the point of beginning; thence northeasterly 35 degrees 07 minutes 40 seconds azimuth 131.55 feet; thence northeasterly 36 degrees 51 minutes 00 seconds azimuth 1080.00 feet; thence southeasterly 126 degrees 51 minutes 00 seconds azimuth 1011.10 feet to the center line of Viola Road N.E. (C.S.A.H. No. 2); thence southwesterly 232 degrees 25 minutes 35 seconds azimuth along said center line 72.91 feet; thence northwesterly 322 degrees 25 minutes 35 seconds azimuth 200.00 feet; thence southwesterly 232 degrees 25 minutes 35 seconds azimuth 110.00 feet; thence southwesterly 382.56 feet on a tangential curve concave to the southeast having a radius of 2112.76 feet with a central angle of 10 degrees 22 minutes 29 seconds; thence southwesterly 222 degrees 03 minutes 06 seconds azimuth 201.14 feet; thence southwesterly 64.72 feet on a tangential curve concave to the southeast having a radius of 3081.65 feet with a central angle of 01 degrees 12 minutes 12 seconds to the northeasterly line of Northern Heights East First Subdivision, thence northwesterly 306 degrees 51 minutes 00 seconds azimuth along said northeasterly line 169.28 feet; thence southwesterly 216 degrees 51 minutes 00 seconds azimuth along the northwesterly line of Northern Heights East First Subdivision 196.25 feet; thence northwesterly 306 degrees 51 minutes 00 seconds azimuth along the northeasterly line of Northern Heights First Subdivision 36.86 feet; thence westerly 288 degrees 29 minutes 04 seconds azimuth along the northerly line of Northern Heights First Subdivision 117.13 feet; thence westerly 270 degrees 07 minutes 08 seconds azimuth along said northerly line 161.38 feet; thence westerly 279 degrees 10 minutes 40 seconds azimuth along said northerly line 255.66 feet to the point of beginning.

Said tract contains 16.50 acres more or less.

REC'D. BY
MAR 18 1986

BERRY VALLEY

ROCHESTER CITY LIMITS

Proposed Annexation

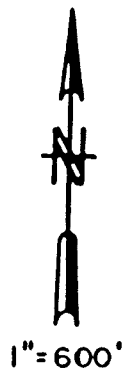

30

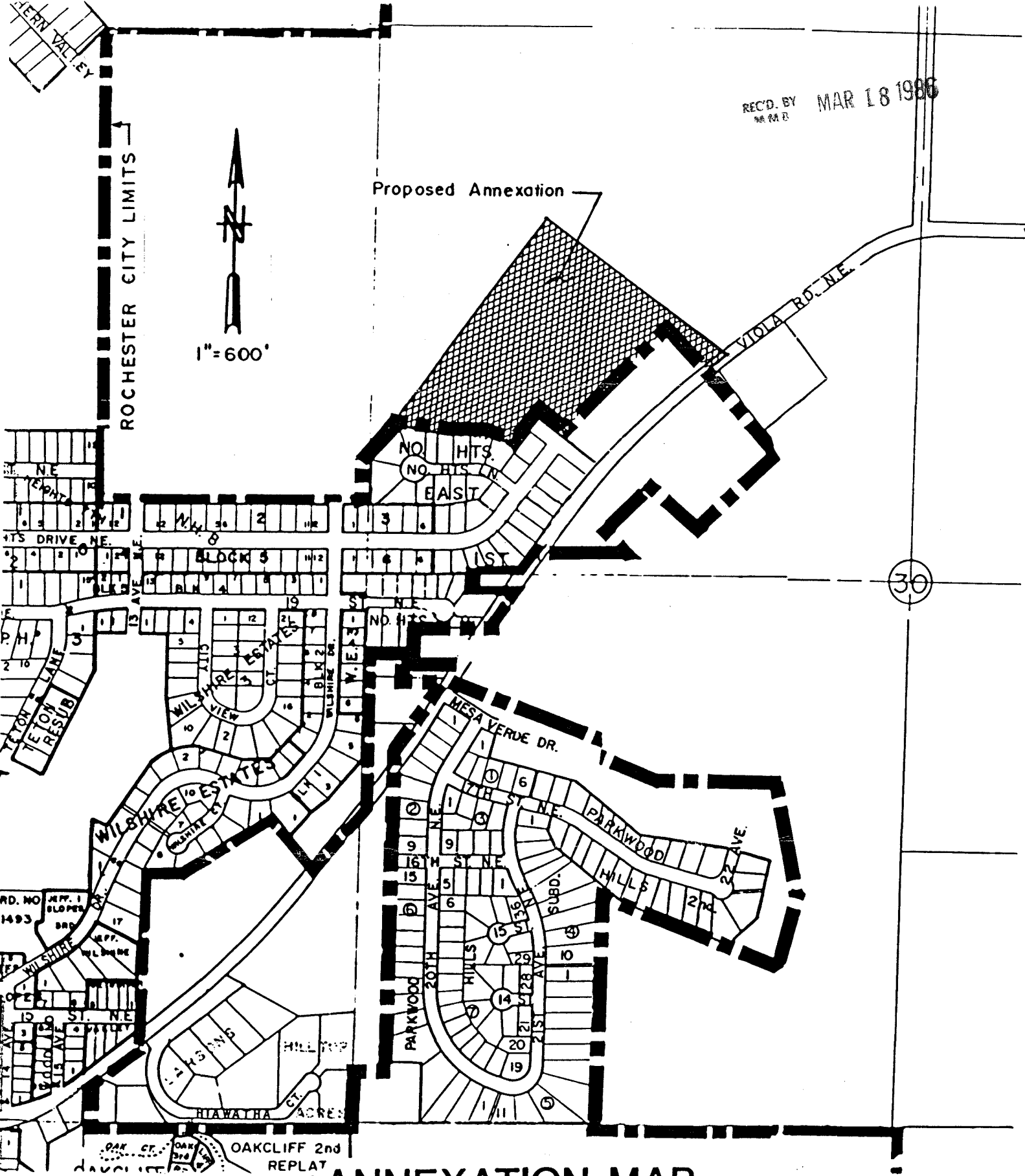

ANNEXATION MAP

MARCH 13, 1986



PREPARED BY
YAGGY ASSOCIATES, INC.
CONSULTING ENGINEERS ■ PLANNERS ■ SURVEYORS
ROCHESTER MINNESOTA MASON CITY IOWA

REC'D. BY MAR 18 1986

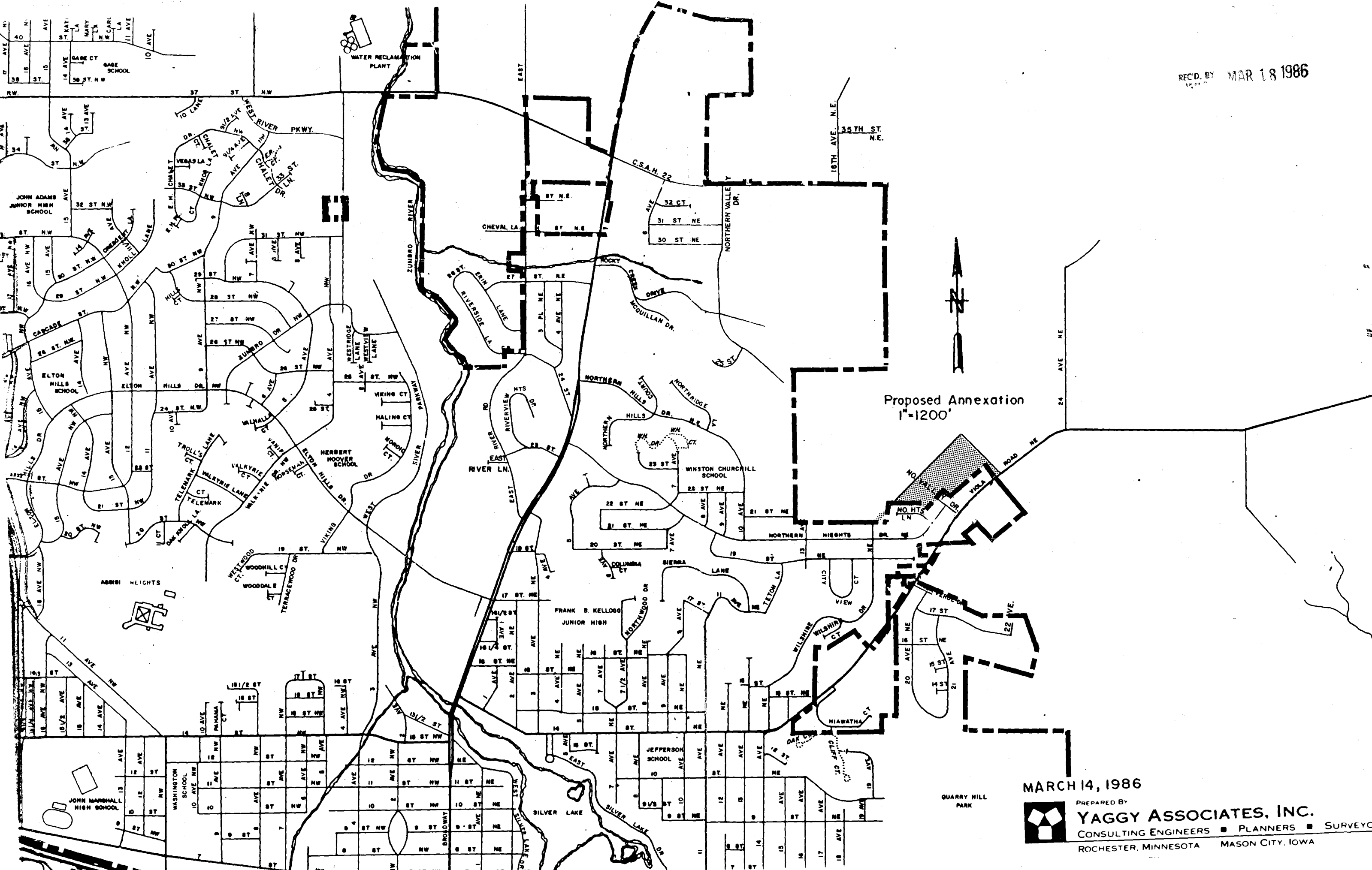

Proposed Annexation
1"=1200'

MARCH 14, 1986



PREPARED BY
YAGGY ASSOCIATES, INC.
CONSULTING ENGINEERS ■ PLANNERS ■ SURVEYORS
ROCHESTER, MINNESOTA ■ MASON CITY, IOWA