

0-86-0630-219

AN ORDINANCE ANNEXING PROPERTY TO THE
CORPORATE LIMITS OF THE CITY OF MANKATO

WHEREAS, certain property described below is not presently included in the corporate limits of any incorporated city, village, or borough; and

WHEREAS, pursuant to M.S. 414.033, Subdivision 5, a majority of the owners of the property described below have petitioned the City of Mankato for annexation of such property; and

WHEREAS, the property is located adjacent to existing City boundaries and can be served with public utilities; and

WHEREAS, the Council of the City of Mankato finds that the property is about to become urban in character and no objections to the annexation have been received.

NOW, THEREFORE, the Council of the City of Mankato hereby ordains that the corporate limits of the City are hereby extended to include the land described as follows and the same is hereby annexed to and included within the City of Mankato as effectively as if it had originally been part thereof:

A part of the Southwest Quarter of the Southwest Quarter and a part of the Northwest Quarter of the Southwest Quarter of Section 10, Township 108 North, Range 26 West, Town of Mankato, Blue Earth County, Minnesota described as follows:

Commencing at the Southwest Corner of said Section 10; thence North 00 degrees 11 minutes 51 seconds East 1,365.80 feet; thence North 89 degrees 36 minutes 08 seconds East 183.55 feet to the point of beginning, also being the East right-of-way line of Trunk Highway 22; thence North 89 degrees 36 minutes 08 seconds East 505.00 feet; thence South 00 degrees 10 minutes 55 seconds West 852.11 feet; thence along the arc of a curve concave easterly having a radius of 250.72 feet and whose chord bears South 13 degrees 50 minutes 31 seconds East 121.51 feet; thence South 27 degrees 51 minutes 56 seconds East 110.20 feet; thence along the arc of a curve concave westerly having a radius of 500.74 feet and whose chord bears South 16 degrees 51 minutes 23 seconds East 191.25 feet to the North right-of-way line of Trunk Highway 14; thence South 89 degrees 36 minutes 08 seconds West 486.82 feet; thence along the arc of a curve concave northerly having a radius of 68,644.94 feet and whose chord bears South 89 degrees 42 minutes 40 seconds West 55.58 feet; thence North 45 degrees 02 minutes 05 seconds West 140.75 feet; thence North 00 degrees 10 minutes 55 seconds East 1,151.24 feet to the point of beginning. This parcel contains 654,730 square feet.

and

All that part of Trunk Highway 14 right-of-way within the West 758.50 feet of the Southwest Quarter of the Southwest Quarter of Section 10 and within the West 758.50 feet of the Northwest Quarter

of the Northwest Quarter of Section 15, all in Township 108 North, Range 26 West, Blue Earth County Minnesota. Containing 3.0 acres more or less.

Also, all that part of Minnesota Trunk Highway 22 right-of-way within the North Half of the Northeast Quarter of the Southeast Quarter of Section 9 and within the West Half of the Southwest Quarter of Section 10, all in Township 108 North, Range 26 West, Blue Earth County, Minnesota. Containing 11.8 acres more or less.

The City Clerk is hereby directed to file copies of this Ordinance with the Minnesota Municipal Board, the Secretary of State, the Blue Earth County Auditor and the Mankato Town Board.

This Ordinance shall take effect thirty (30) days after its passage, due publication thereof, and approval by the Minnesota Municipal Board.

Adopted this 30th day of June, 1986.

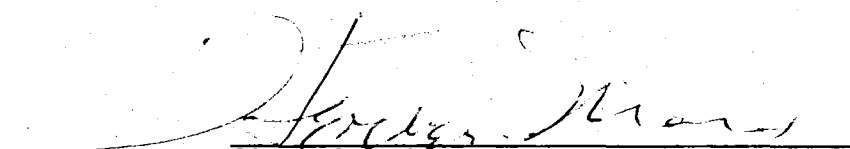

City of Mankato
Herbert Mocol, Mayor

ATTEST:

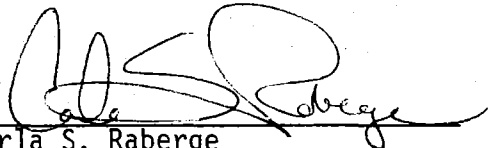

Carla S. Raberge
City Clerk

REC'D. BY JUL 9 1986
MMB

POND

← HAEFNER
&
MN. Highway R.O.W
ANNEXATION
←

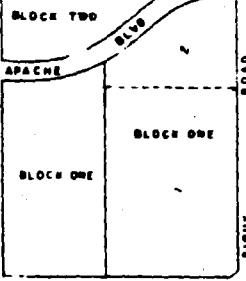
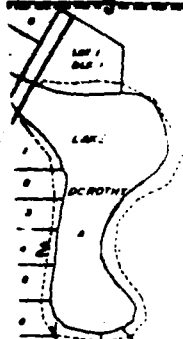

AVE EAST

WEST