

PETITION FOR ANNEXATION

The undersigned owners of the property described herein hereby petition the City of Tyler to annex as a part of said City the following described property:

That part of the Northeast Quarter of Section 9, Township 109 North, Range 44 West of the Fifth Principal Meridian in Lincoln County, Minnesota, described as follows:

Commencing at the Northeast corner of said northeast quarter; thence west assumed bearing, along the north line of said northeast quarter, a distance of 2135.65 feet to the point of beginning of the tract to be described; thence south  $01^{\circ} 13' 39''$  east, along a line parallel with the east line of said section, a distance of 658.52 feet; thence west, along a line parallel with the north line of said northeast quarter, a distance of 503.40 feet, to the west line of said northeast quarter; thence north  $00^{\circ} 30' 17''$  west, along the west line of said northeast quarter, a distance of 698.39 feet, to the northwest corner of said northeast quarter; thence east, along the north line of said northeast quarter a distance of 494.59 feet, to the point of beginning. Said tract contains 8.00 acres. Subject to easements and reservations of record.

JOHNSONS

By: Dan Johnson

By: Deane Johnson

By: Ken Johnson

Dated this 12th day of November, 1985.

REC'D. BY  
MMB  
NOV 22 1985

# MUNICIPALITIES OF LINCOLN CO.

PREPARED BY THE  
MINNESOTA DEPARTMENT OF TRANSPORTATION  
TECHNICAL SERVICES DIVISION  
IN COOPERATION WITH THE  
U.S. DEPARTMENT OF TRANSPORTATION  
FEDERAL HIGHWAY ADMINISTRATION



## LEGEND

- INTERSTATE TRUNK HIGHWAY.....(35)
- U.S. NUMBERED TRUNK HIGHWAY.....(10)
- STATE NUMBERED TRUNK HIGHWAY.....(6)
- COUNTY STATE AID HIGHWAY.....(3)
- COUNTY ROAD.....(7)
- COUNTY STATE AID HIGHWAY IN  
ADJOINING COUNTY.....(2)
- COUNTY ROAD IN ADJOINING COUNTY.....(1)
- CORPORATE LIMITS.....
- CENTRAL BUSINESS DISTRICT BOUNDARY.....

MAP OF  
TYLER  
LINCOLN COUNTY  
POP. 1353

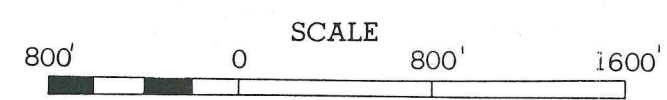

1985  
BASIC DATA-1977

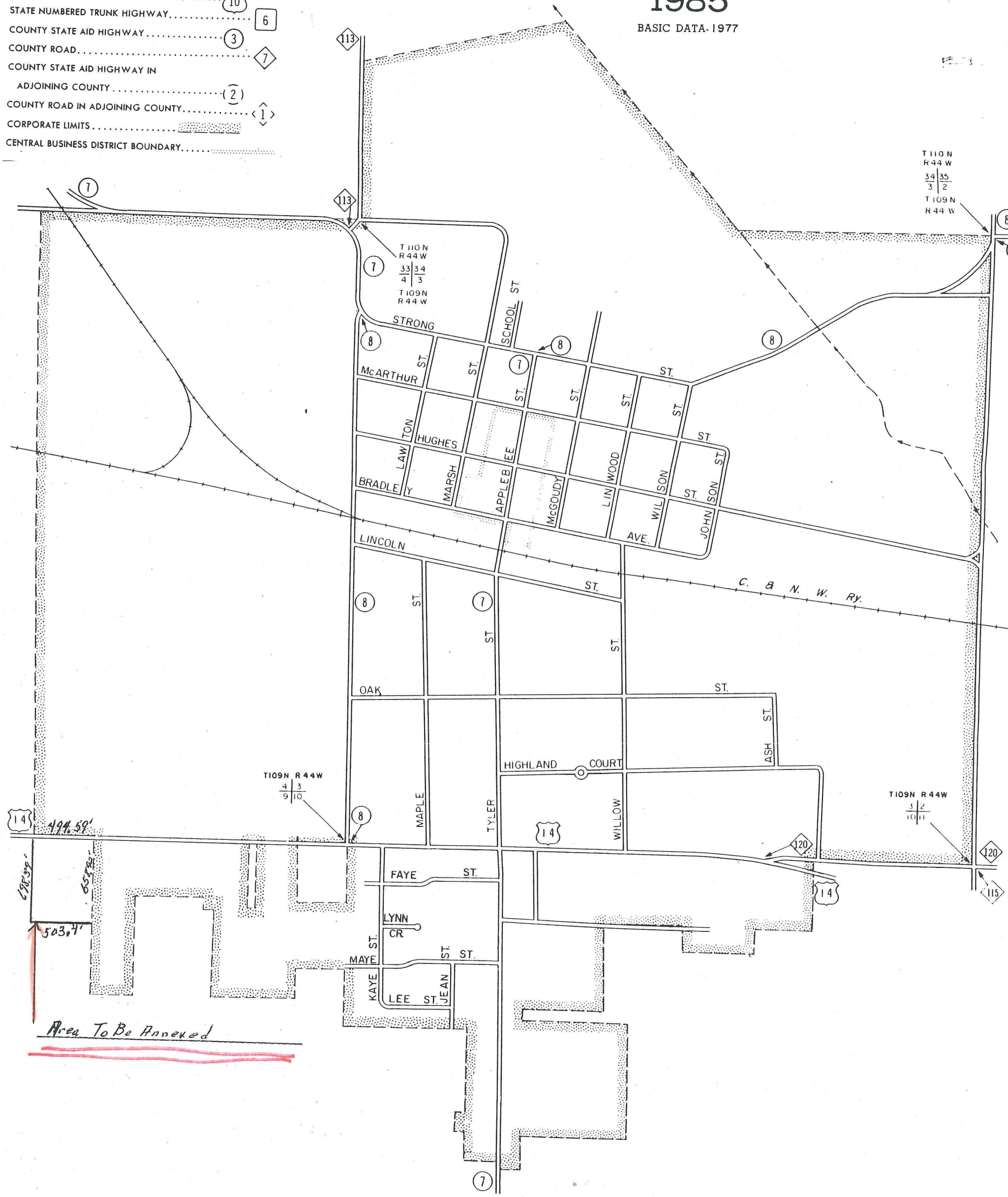

Area To Be Annexed