

AN ORDINANCE EXTENDING THE CORPORATE LIMITS OF  
THE CITY OF BEMIDJI  
TO INCLUDE CERTAIN UNINCORPORATED TERRITORY

WHEREAS, certain territory described below is not presently included within any other municipality and does not abut upon the limits of any other municipality, and

WHEREAS, the owners of this territory have petitioned the City for annexation by ordinance pursuant to Minnesota Statutes 414.033, and

WHEREAS, said property abuts upon the limits of the City of Bemidji, is platted in part and unplatted, and does not exceed 200 acres in area in part, and

SECTION 1. TERRITORY ANNEXED.

The corporate limits of the City of Bemidji, Minnesota, are hereby extended to include the unplatted territory described as follows:

The South 30 feet of the West 417 feet of the East 450 feet of the SE 1/4 of Section 32, Township 147 North, Range 33 West; the South 33 feet of the SE 1/4 of Section 32, Township 147 North, Range 33 West except the East 450 feet thereof and the South 33 feet of the East 500.01 feet of the SE 1/4 SW 1/4 of Section 32, Township 147 North, Range 33 West.

SECTION 2. FILING.

The City Clerk is directed to file certified copies of this ordinance with the Secretary of State, the County Auditor of Beltrami County, and the Minnesota Municipal Commission.

SECTION 3. EFFECTIVE DATE OF ANNEXATION.

This ordinance shall take effect upon its passage and publication and the filing of certified copies as directed in Section 2.

First Reading: August 19, 1985

Second Reading: September 3, 1985

Third Reading: September 16, 1985

Passed: September 16, 1985

Delivered to Mayor: September 17, 1985

Returned by Mayor: September 18, 1985

ATTEST:

APPROVED:

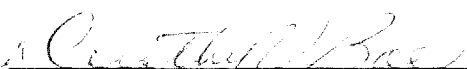
  
Dorothy V. Boe, City Clerk

  
Douglas E. Peterson, Mayor

STATE OF MINNESOTA

COUNTY OF BELTRAMI

OCT 21 1995

PETITION FOR ANNEXATION  
BY ORDINANCE PURSUANT TO  
MINNESOTA STATUTE 414.033

TO: THE CITY COUNCIL  
CITY OF BEMIDJI, MINNESOTA

Petitioners state as follows:

1. We, the undersigned, are the sole owners of the following described property lying in the Town of Northern, County of Beltrami, State of Minnesota:

South 33 feet of the West 100.01 feet of the East  
500.01 feet of the SE 1/4 of the SW 1/4 of Section  
32, Township 147 North, Range 33 West, also known  
as the North 1/2 of 30th Street.

2. Said property is unincorporated and abuts upon the limits of the City of Bemidji.

3. Said property is unplatted and does not exceed 200 acres in area. The acreage of such area is 0.08 acres.

4. Said property is not included within any other municipality and does not abut upon the limits of any other municipality.

PETITIONERS REQUEST that pursuant to Minnesota Statute 414.033, and particularly Subdivision 5 thereof, said property be annexed to and included within the City of Bemidji.

Dated: \_\_\_\_\_

-----  
On this 5th day of August, 1985,  
before me personally appeared  
Gerald and Linda Brooks who  
executed the foregoing instrument  
and acknowledged to me that they  
executed the same as their free act  
and deed.

Dorothy V. Boe  
Notary Public

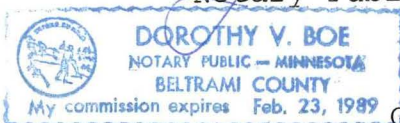

Gerald and Linda Brooks

Gerald Brooks  
Linda J. Brooks

STATE OF MINNESOTA

RECD. BY  
OCT 21 1985

COUNTY OF BELTRAMI

PETITION FOR ANNEXATION  
BY ORDINANCE PURSUANT TO  
MINNESOTA STATUTE 414.033

TO: THE CITY COUNCIL  
CITY OF BEMIDJI, MINNESOTA

Petitioners state as follows:

1. We, the undersigned, are the sole owners of the following described property lying in the Town of Northern, County of Beltrami, State of Minnesota:

South 33 feet of the West 185 feet of the East 400 feet  
of the SE $\frac{1}{4}$  of the SW $\frac{1}{4}$  of Section 32, Township 147 North,  
Range 33 West, also known as the North  $\frac{1}{2}$  of 30th Street,

2. Said property is unincorporated and abuts upon the limits  
of the City of Bemidji.

3. Said property is unplatted and does not exceed 200 acres  
in area. The acreage of such area is 0.14 acres.

4. Said property is not included within any other municipality  
and does not abut upon the limits of any other municipality.

PETITIONERS REQUEST that pursuant to Minnesota Statute 414.033,  
and particularly Subdivision 5 thereof, said property be annexed to and  
included within the City of Bemidji.

Dated: July 23 - 1984

Bonnie Lou Maxine Bahr

STATE OF MINNESOTA  
COUNTY OF BELTRAMI

PETITION FOR ANNEXATION  
BY ORDINANCE PURSUANT TO  
MINNESOTA STATUTE 414.033



REC'D. BY  
12.14.8

OCT 21 1985

TO: THE CITY COUNCIL  
CITY OF BEMIDJI, MINNESOTA

Petitioners state as follows:

1. We, the undersigned, are the sole owners of the following described property lying in the Town of Northern, County of Beltrami, State of Minnesota:

The South 33 feet of the East 1/2 of Southeast 1/4  
Section 32, Township 147 North, Range 33 West, less the  
East 950 feet thereof, Also known as the North 1/2 of  
30th Street.

2. Said property is unincorporated and abuts upon the limits of the City of Bemidji,

3. Said property is unplatted and does not exceed 200 acres in area. The acreage of such area is 0.28 acres.

4. Said property is not included within any other municipality and does not abut upon the limits of any other municipality.

PETITIONERS REQUEST that pursuant to Minnesota Statute 414.033, and particularly Subdivision 5 thereof, said property be annexed to and included within the City of Bemidji.

Dated: 7-11-84

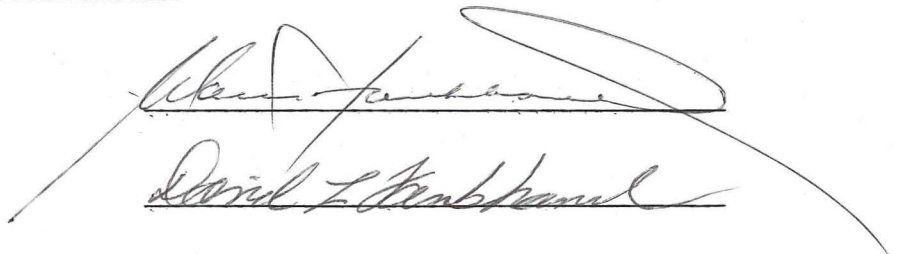

Walter and Dave Fankhanel

REC'D. BY  
M.M.B.

OCT 21 1985

STATE OF MINNESOTA

COUNTY OF BELTRAMI

PETITION FOR ANNEXATION  
BY ORDINANCE PURSUANT TO  
MINNESOTA STATUTE 414.033

TO: THE CITY COUNCIL  
CITY OF BEMIDJI, MINNESOTA

Petitioners state as follows:

1. We, the undersigned, are the sole owners of the following described property lying in the Town of Northern, County of Beltrami, State of Minnesota:

South 33 feet of the West 1/2 of the Southeast 1/4  
Section 32, Township 147 North, Range 33 West, also  
known as the North 1/2 of 30th Street.

2. Said property is unincorporated and abuts upon the limits of the City of Bemidji.

3. Said property is unplatted and does not exceed 200 acres in area. The acreage of such area is 1 acre.

4. Said property is not included within any other municipality and does not abut upon the limits of any other municipality.

PETITIONERS REQUEST that pursuant to Minnesota Statute 414.033, and particularly Subdivision 5 thereof, said property be annexed to and included within the City of Bemidji.

Dated: July 5, 1984

Wayne Thorson  
Beverly Thorson



REC'D. BY OCT 21 1985  
By

STATE OF MINNESOTA

COUNTY OF BELTRAMI

PETITION FOR ANNEXATION  
BY ORDINANCE PURSUANT TO  
MINNESOTA STATUTE 414.033

TO: THE CITY COUNCIL  
CITY OF BEMIDJI, MINNESOTA

Petitioners state as follows:

1. We, the undersigned, are the sole owners of the following described property lying in the Town of Northern, County of Beltrami, State of Minnesota:

South 33 feet of the East 215 feet of the SE $\frac{1}{4}$  of the SW $\frac{1}{4}$  Section 32, Township 147 North, Range 33 West, also known as the North  $\frac{1}{2}$  of 30th Street,

2. Said property is unincorporated and abuts upon the limits of the City of Bemidji.

3. Said property is unplatted and does not exceed 200 acres in area. The acreage of such area is 0.16 acres.

4. Said property is not included within any other municipality and does not abut upon the limits of any other municipality.

PETITIONERS REQUEST that pursuant to Minnesota Statute 414.033, and particularly Subdivision 5 thereof, said property be annexed to and included within the City of Bemidji.

Dated: 7/30/84

Walter Brooks  
Jeannine Brooks

SEP 21 1985

STATE OF MINNESOTA  
COUNTY OF BELTRAMI

PETITION FOR ANNEXATION  
BY ORDINANCE PURSUANT TO  
MINNESOTA STATUTE 414.033

TO: THE CITY COUNCIL  
CITY OF BEMIDJI, MINNESOTA

Petitioners state as follows:

1. We, the undersigned, are the sole owners of the following described property lying in the Town of Northern, County of Beltrami, State of Minnesota:

The south 30' of Dickenson 1st Subdivision Sec. 32,  
Township 147 North, Range 33 West, lying adjacent to  
Lot 16 of said subdivision also known as the North 1/2  
of 30th Street.

2. Said property is unincorporated and abuts upon the limits of the City of Bemidji.

3. Said property is unplatted and does not exceed 200 acres in area. The acreage of such area is 0.18 acres.

4. Said property is not included within any other municipality and does not abut upon the limits of any other municipality.

PETITIONERS REQUEST that pursuant to Minnesota Statute 414.033, and particularly Subdivision 5 thereof, said property be annexed to and included within the City of Bemidji.

DATED: 7/30/84

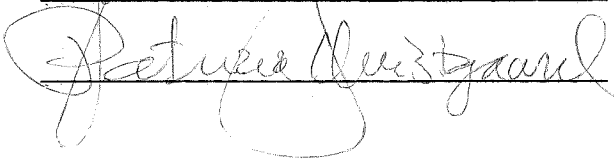
Jon and June Quistgaard

STATE OF MINNESOTA

COUNTY OF BELTRAMI

PETITION FOR ANNEXATION  
BY ORDINANCE PURSUANT TO  
MINNESOTA STATUTE 414.033

TO: THE CITY COUNCIL  
CITY OF BEMIDJI, MINNESOTA

Petitioners state as follows:

1. We, the undersigned, are the sole owners of the following described property lying in the Town of Northern, County of Beltrami, State of Minnesota:

The South 30 feet of Dickenson 1st Subdivision, Section 32, Township 147 North, Range 33 West, lying adjacent to Lot 1 of said subdivision also known as the North 1/2 of 30th Street.

2. Said property is unincorporated and abuts upon the limits of the City of Bemidji.

3. Said property is unplatted and does not exceed 200 acres in area. The acreage of such area is 0.13 acres.

4. Said property is not included within any other municipality and does not abut upon the limits of any other municipality.

PETITIONERS REQUEST that pursuant to Minnesota Statute 414.033, and particularly Subdivision 5 thereof, said property be annexed to and included within the City of Bemidji.

Dated: 7-10-84

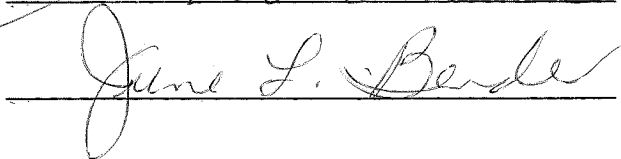
Bill and June Bender



RECD. BY  
OCT 21 1985

STATE OF MINNESOTA  
COUNTY OF BELTRAMI

PETITION FOR ANNEXATION  
BY ORDINANCE PURSUANT TO  
MINNESOTA STATUTE 414.033

TO: THE CITY COUNCIL  
CITY OF BEMIDJI, MINNESOTA

Petitioners state as follows:

1. We, the undersigned, are the sole owners of the following described property lying in the Town of Northern, County of Beltrami, State of Minnesota:

The South 33 feet of the South 450 feet of West 500 feet of east 950 feet of SE $\frac{1}{4}$  of SE $\frac{1}{4}$  of Section 32, Township 147 North, Range 33 West, also known as the North 1/2 of 30th Street.

2. Said property is unincorporated and abuts upon the limits of the City of Bemidji,

3. Said property is unplatted and does not exceed 200 acres in area. The acreage of such area is 0.38 acres.

4. Said property is not included within any other municipality and does not abut upon the limits of any other municipality.

PETITIONERS REQUEST that pursuant to Minnesota Statute 414.033, and particularly Subdivision 5 thereof, said property be annexed to and included within the City of Bemidji.

DATED: Aug. 14-1984

Lem Pierce  
Executor for Gladys Pierce

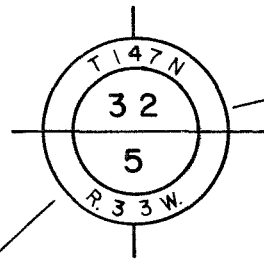
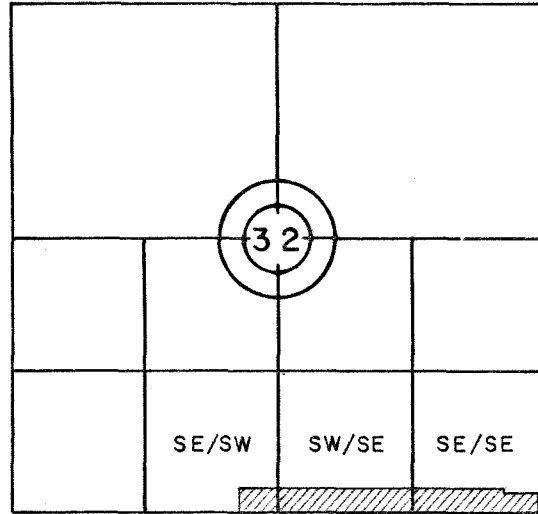

Gladys Pierce

NW COR. R. 33 W. NE COR.

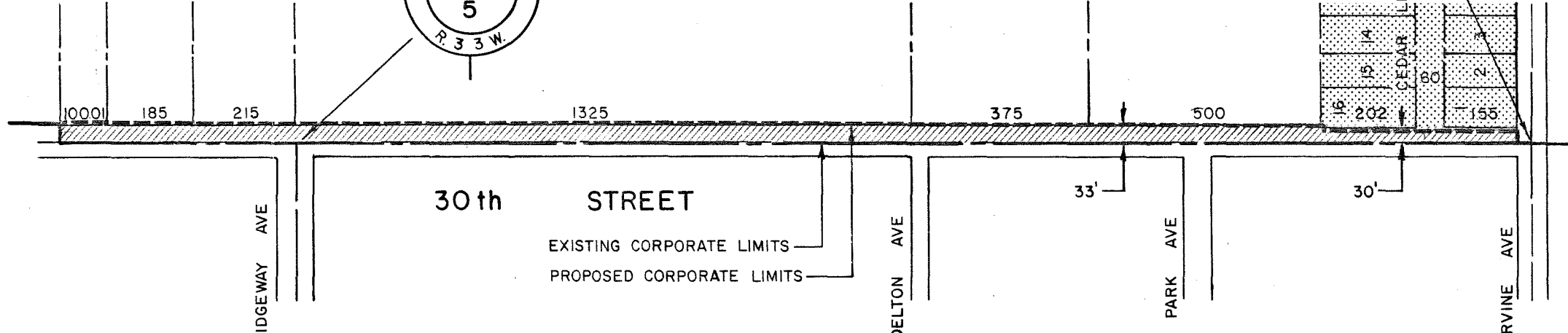
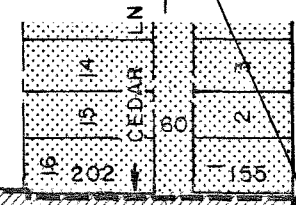
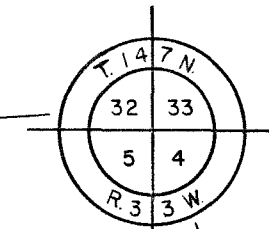

SEC. 32  
VICINITY SKETCH



 DENOTES AREA BEING ANNEXED  
 DENOTES PLATTED AREA (DICKINSON SUBDIVISION)

— ANNEXATION PLAT —  
CITY OF BEMIDJI  
ENGINEERING DEPT. 

RECEIVED  
OCT 21 1965