

MAY 03 1985

ORDINANCE NO. 1002-61

An ordinance extending the corporate limits of the City of Minneota to include certain unincorporated property owned by and abutting upon the limits of the City of Minneota.

The Common Council does ordain as follows:

WHEREAS, The territory described below is not presently within the corporate limits of any incorporated city; and

WHEREAS, This territory abuts upon the corporate limits of the City of Minneota the present corporate boundary thereof and is deemed to be urban or suburban in character; and

WHEREAS, This territory is owned in fee by the city;

The city council of Minneota ordains:

Section 1. Territory annexed. The corporate limits of the City of Minnesota are hereby extended to include the (unplatted) property described as follows now owned by the city:

All that part of the Southeast Quarter of the Northeast Quarter (SE $\frac{1}{4}$ NE $\frac{1}{4}$), of Section Thirty-six (36), Township One hundred Thirteen (113) North, Range Forty-three (43) West, Lyon County, Minnesota, being more particularly described as follows:

Commencing at the Northeast corner of Lot 8, of Wm. Anderson's First Addition to the Village (now City) of Minneota, as filed and recorded in the office of the County Recorder in and for said Lyon County, thence North 56 degrees 11 minutes 53 seconds West, assumed bearing, along the North line of said Lot 8, 81.11 feet; thence North 33 degrees 48 minutes 07 seconds East 301.86 feet; thence South 56 degrees 11 minutes 53 seconds East 515.28 feet; thence South 33 degrees 48 minutes 07 seconds West 185.00 feet to the point of beginning, said point being on the north line of said Southeast Quarter of the Northeast Quarter; thence continuing South 33 degrees 48 minutes 07 seconds West 315.00 feet to a point on the northeasterly right of way line of Minnesota Trunk Highway number 68; thence North 56 degrees 11 minutes 53 seconds West along said right of way line 90.00 feet; thence South 33 degrees 48 minutes 07 seconds West along said right of way line 10.00 feet; thence North 56 degrees 11 minutes 53 seconds West along said right of way line 205.01 feet to a point on the West line of said Southeast Quarter of the Northeast Quarter; thence North 00 degrees 02 minutes 02 seconds East along said west line of the Southeast Quarter of the Northeast Quarter 101.88 feet to the Northwest corner of said Southeast Quarter of the Northeast Quarter; thence North 89 degrees 27 minutes 10 seconds East along the north line of said

Southeast Quarter of the Northeast Quarter 425.91 feet to the point of beginning.

Said tract of land contains 1.58 acres.

Section 2. Filing. The city clerk is directed to file certified copies of this ordinance with the Secretary of State, the County Auditor of Lyon County in which the property is located and the Town Clerk of Eidsvold Township, the Town Clerk of the affected township and Minnesota Municipal Board.

Section 3. Effective date of annexation. The ordinance takes effect upon its passage and publication and the filing of certified copies as directed by Section 2.

Adopted by the City of Minnesota, Minnesota, April 27th, 1985.

ATTEST:

Everett H. Hagelbom
Clerk (Recorder)

Paul Larson
Mayor

Published in Minneapolis 5-2+5-9, 1985.

Clerk's Certificate

I, the undersigned, being duly qualified and acting Clerk-Treasurer of the City of Minneota, Minnesota, hereby certify that I have carefully compared the attached and foregoing ordinance with the original thereof on file in my office and firther certify that the same is a full, true and complete transscript therefrom, insofar as the same relates to the extending of the Corporate limits of the City of Minneota to include certain unincorporated property owned by and abutting upon the limits of the City of Minneota.

I certify that councilman David Meiners introduced ordinance No 1002.01 and moved for its adoption, Councilman Richard Downing seconded the motion and on roll call the "AYES", ABSTAINS" and "NAYES" were as follows;

AYES	ABSTAINS	NAYES
Paul Larson	0	0
David Meiners		
Richard Downing		
Dennis Tomasek		
Jack Rehkamp		

Whereupon, Mayor Paul Larson declared the ordinance duly passed and adopted this 27th day of April, 1985 and that it shall become effective upon its publication as according to law.

I further ceritfy that the said ordinance was duly adopted by the Minneota City Council at a duly called special meeting at 10:00 A. M. on April 27, 1985.

WITNESS my hand officially as such Clerk-Treasurer and the Corporate Seal of the City of Minneota this 1st day of May, 1985.

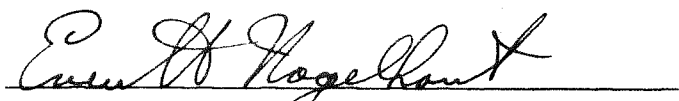

 Everett Nagelhout - Clerk-Treasurer
 City of Minneota, MN

(SEAL)

Published in the Minneota Mascot May 2 and May 9th 1985.

MINNEOTA, MINN.

REC'D. BY
A.M.B. MAY 03 1985

Scale 1 inch = 100 feet

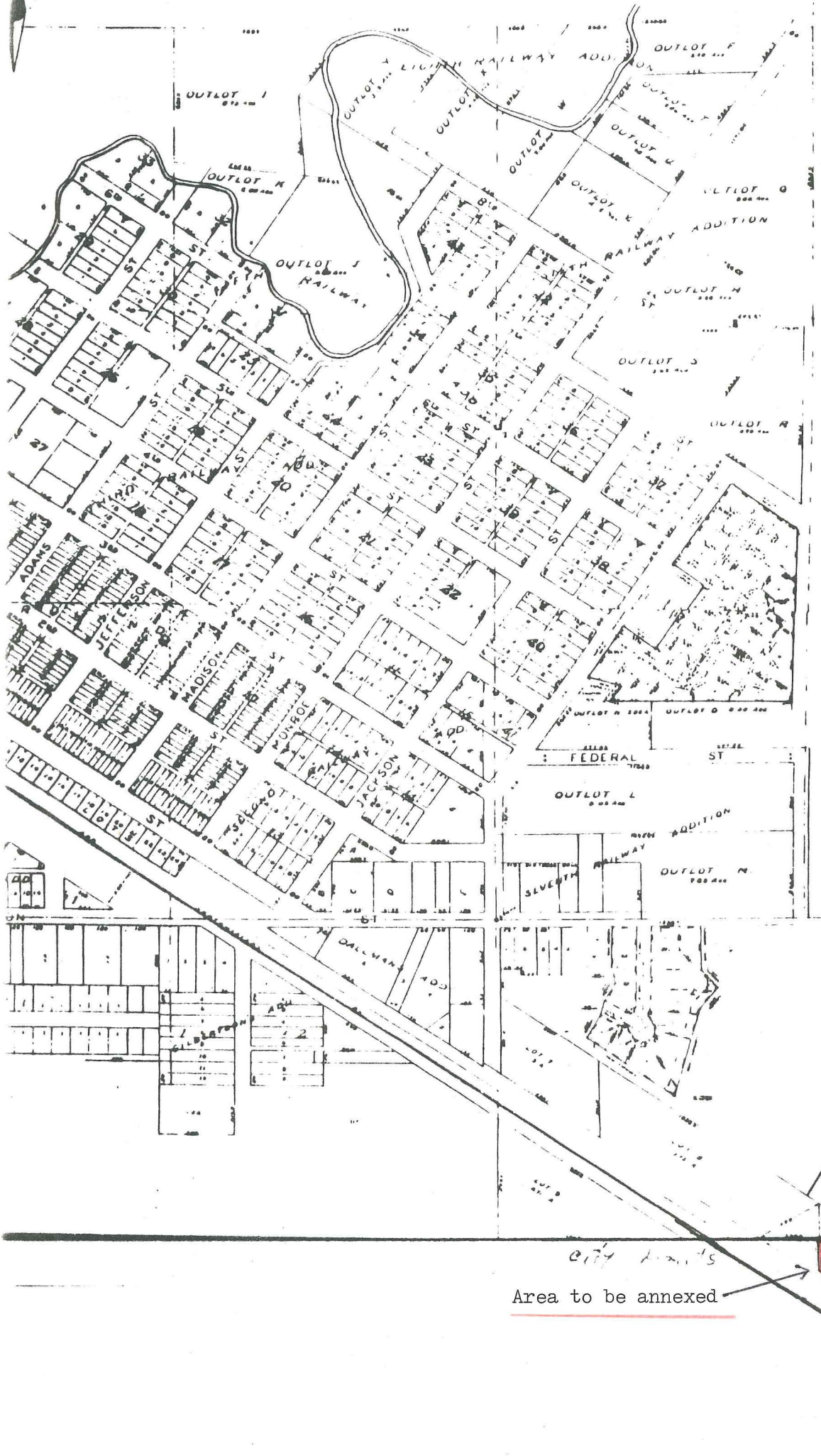

Area to be annexed

Parcel A
Parcel B
5A
5A
1-28-88