

APR 11 1985

ORDINANCE NO. 65

AN ORDINANCE EXTENDING THE CORPORATE LIMITS OF THE CITY OF MAYER TO INCLUDE CERTAIN UNINCORPORATED PROPERTY OWNED BY AND ABUTTING UPON THE LIMITS OF THE CITY.

WHEREAS, the territory described below is not presently within the corporate limits of any incorporated city; and

WHEREAS, this territory abuts upon the corporate limits of the city at the western boundary thereof and deemed to be urban or suburban in character; and

WHEREAS, this territory is owned in fee by the city;

The city council of Mayer ordains:

Section 1. Territory annexed. The corporate limits of the city of Mayer are hereby extended to include the platted property described as follows now owned by the city:

* That part of the East Half of the Northeast Quarter of Section 1, Township 116 North, Range 26 West, described as follows:

Commencing at the northwest corner of said East Half of the Northeast Quarter; thence south along the west line of said East Half of the Northeast Quarter a distance of 660.0 feet to the actual point of beginning; thence easterly parallel with the North line of said East Half of the Northeast Quarter deflecting left $89^{\circ} 49'$ a distance of 900.25 feet; thence continue easterly, parallel with said north line deflecting left $0^{\circ} 17'$ a distance of 61.49 feet to a line 33.0 feet westerly of, measured at right angles to and parallel with the northerly extension of the westerly line of Haueter's Second Addition to Mayer, according to the recorded plat thereof; thence southerly, along said parallel line, deflecting right $90^{\circ} 19'$ a distance of 91.13 feet to the northerly line of land deeded to Fred Lobitz recorded in Book "72" of Deeds, page 321; thence westerly along said northerly line, deflecting right $89^{\circ} 56' 45''$ a distance of 150.00 feet to the westerly line of said Lobitz land; thence southerly along said westerly line, deflecting left $89^{\circ} 56' 45''$ a distance of 100.00 feet to the northerly line of school property recorded in Book "K" of Decrees page 164, Book "30" of Deeds, page 396 and Book "77" of Deeds page 112; thence westerly along said northerly line, deflecting right $89^{\circ} 56' 45''$ a distance of 150.00 feet to the westerly lint of said school property; thence southerly along said westerly line deflecting left $89^{\circ} 56' 45''$ a distance of 561.62 feet to the southerly line of said school property; thence westerly along the westerly extension of said southerly line, deflecting right $89^{\circ} 56' 45''$ a distance of 658.90 feet to the west line of said East Half of the Northeast Quarter; thence north along said west line, deflecting right $89^{\circ} 50' 15''$ a distance of 752.80 feet to the point of beginning.

ORDINANCE NO. 65 (continued)

Section 2. Filing. The city clerk is directed to file certified copies of this ordinance with the Secretary of State, the County Auditor of the county in which the property is located, the Town Clerk of the affected township and the Minnesota Municipal Board.

Section 3. Effective date of annexation. This ordinance takes effect upon its passage and publication and the filing of certified copies as directed in Section 2.

Adopted by the city of Mayer, Minnesota, April 8, 1985.

Attest:

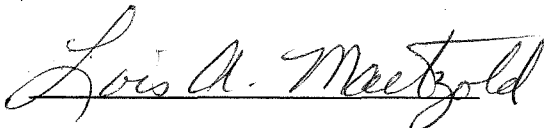

Lois A. Maetzold, City Clerk



Milfred Dalchow, Mayor

Published in the Carver County News on April 18, 1985.

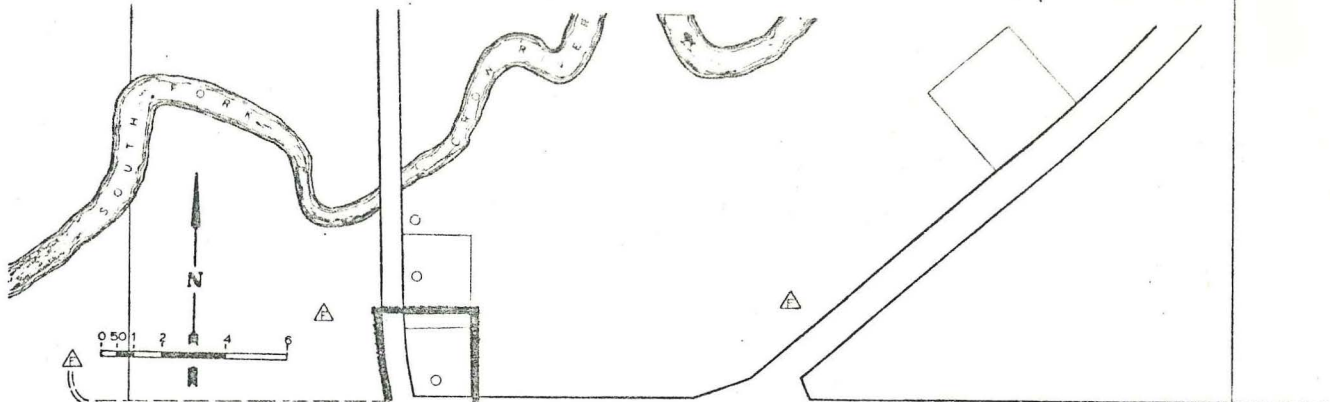

Parcel of land affected by Ordinance #65 →

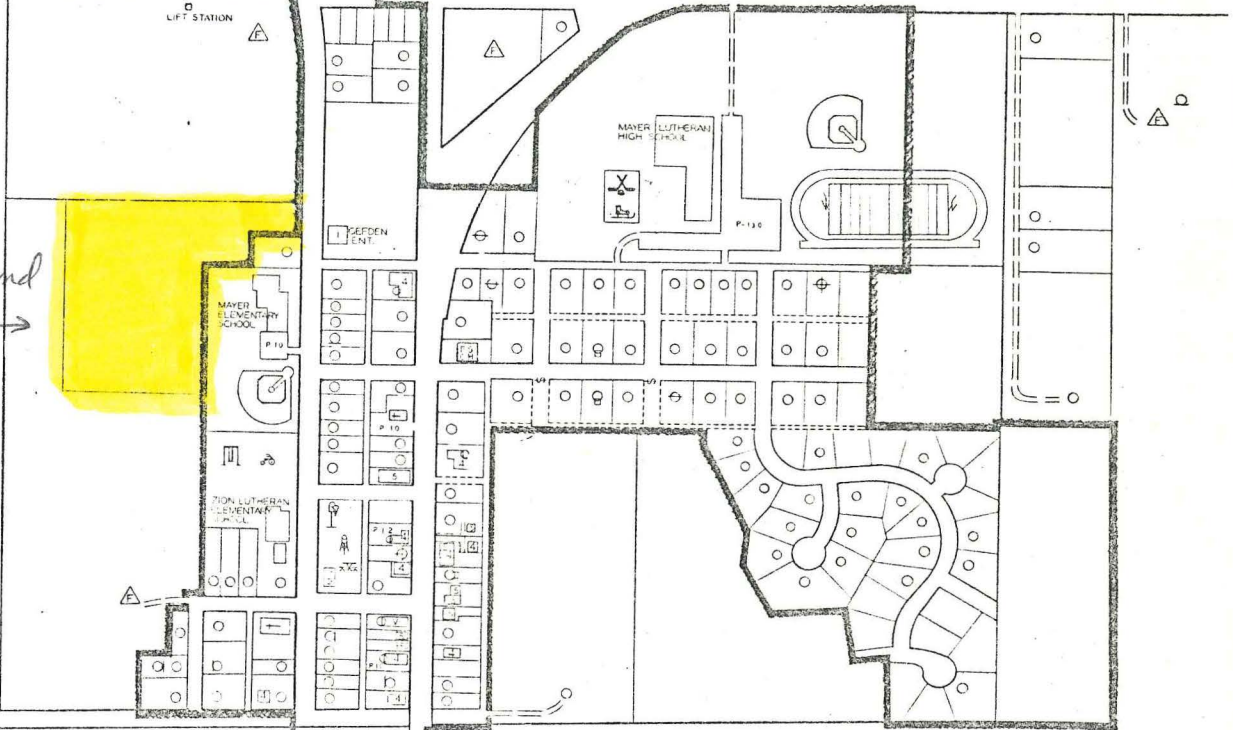
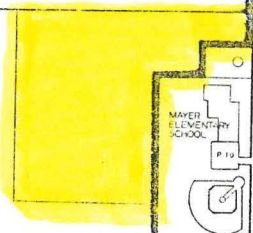

CITY OF MAYER LAND USE MAP

- | | |
|---|--|
| <p>RESIDENTIAL</p> <ul style="list-style-type: none"> ○ single family ◊ mobile home ◇ duplex ◆ triplex ⊕ 4plex ⊖ multiplex ⊗ residence/commercial ⊙ single family, home occupation ⊘ vacant ⊚ farm residence <p>PUBLIC, INSTITUTIONAL & RECREATIONAL</p> <ul style="list-style-type: none"> ⊠ churches ⊡ cemeteries ⊢ watertowers ⊣ city hall ⊤ fire station ⊥ municipal shed ⊦ city well ⊧ county shed ⊨ township shed ⊩ tennis court ⊪ hockey rink ⊫ football field ⊬ baseball field ⊭ tracks ⊮ parks ⊯ skating | <p>TRANSPORTATION, COMMUNICATION UTILITIES & RELATED</p> <ul style="list-style-type: none"> ⊰ parking ⊱ storage tanks ⊲ electrical substation ⊳ transmission tower ⊴ radio television ⊵ railroad ⊶ streets (platted 15 yrs but not existing) ⊷ ingress & egress ⊸ paved streets ⊹ unplatted gravel road ⊺ state highway ⊻ waterways <p>COMMERCIAL & INDUSTRIAL BUILDINGS</p> <ul style="list-style-type: none"> 1 manufacturing (light industry) 2 manufacturing (heavy industry) 3 transportation, communication & utilities 4 trade 5 services 6 cultural, entertainment, recreational |
|---|--|