

PETITION FOR ANNEXATION
CITY OF EITZEN
HOUSTON COUNTY, MINNESOTA

RECD. BY
M M G APR 10 1985

TO THE HONORABLE EITZEN CITY COUNCIL:

The undersigned for their ANNEXATION petition state and allege that they are all of the owners of record of certain lands included in the premises description set forth below; that said lands are unplatted and constitute an area less than 200 acres; that said hereinafter described tract here proposed to be annexed to the City of Eitzen abuts on the present City of Eitzen municipal boundary and is now of urban or suburban character.

The lands the subject matter of this petition are described as follows, to wit:

All that part of the E $\frac{1}{2}$ of the SE $\frac{1}{4}$ of the NE $\frac{1}{4}$ of Section 32, Township 101 North of Range 5 West of the Fifth Principal Meridian lying North of the North right-of-way line of Houston County State Aid Highway #2.

WHEREFORE, your honorable council is petitioned to initiate and process to conclusion this annexation petition, annexing the aforescribed lands by ordinance according to the statute in such cases made and provided, and in connection therewith to serve copies hereof upon the Municipal Board of the State of Minnesota, The Town Board of the Town of Winnebago, and the Houston County Board of Commissioners.

Dated this 28th day of February, 1985.

George Pottratz

Lucille Pottratz

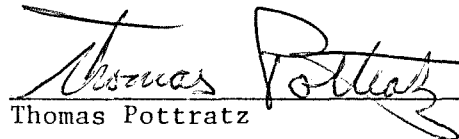

Thomas Pottratz

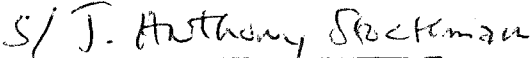
Filed in the Clerk's Office
This 11th day of March, 1985

City Clerk, Eitzen, Mn. 55931

A-4196

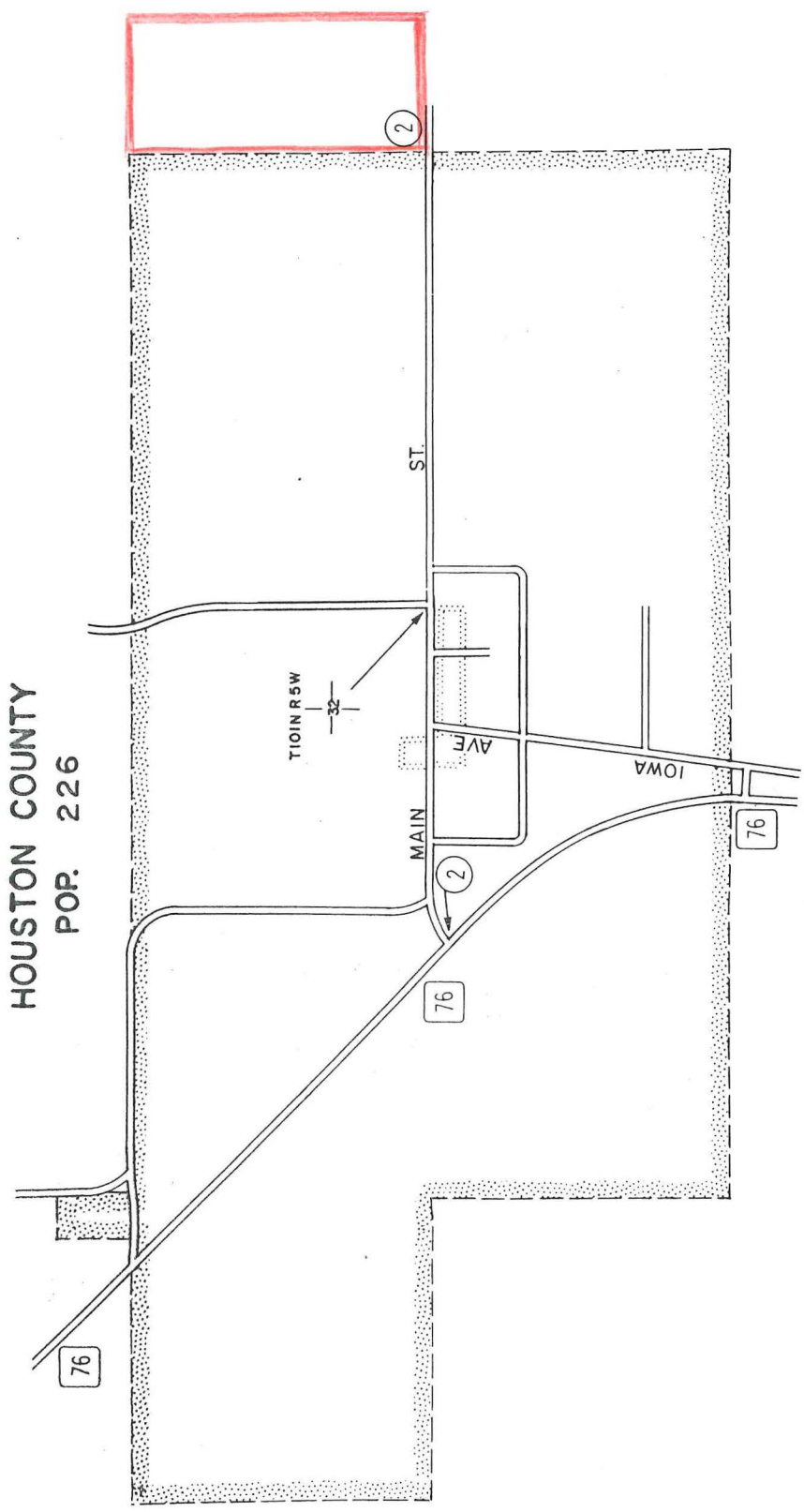
MAP OF
EITZEN
HOUSTON COUNTY
POP. 226



REC'D BY
MMB
APR 10 1985

MMB NO. A-4196