

JAN 15 1985

PUBLICATION NO. 3369

ORDINANCE NO. 707

AN ORDINANCE EXTENDING THE CORPORATE LIMITS OF THE
CITY OF HUTCHINSON TO INCLUDE CERTAIN UNINCORPORATED
TERRITORIES BORDERED BY LAND WITHIN THE CITY
LIMITS AND ABUTTING THEREON

WHEREAS, certain territory described below is not presently included within the corporate limits of any incorporated city or burrough; and

WHEREAS, the land is unplatted, does not exceed 200 acres in area, and 100% of the owners of said land have petitioned the City Council of the City of Hutchinson for annexation and the property is deemed to be urban or suburban in character;

THE CITY COUNCIL OF HUTCHINSON DOES ORDAIN:

SECTION 1. Territory Annexed. The corporate limits of the City of Hutchinson, Minnesota, are hereby extended to include the unplatted territory as follows:

Commencing at the NE corner of the SE $\frac{1}{4}$ of Section 2, T116N, R30W, McLeod County, Minnesota; thence South along the East line of said Section 2, a distance of 649.00 feet; thence West, a distance of 1700.00 feet; thence North, a distance of 150.00 feet; thence West 260.00 feet to the point of beginning; thence continuing West, a distance of 740.00 feet; thence South to a point on the extension of the North line of "First Addition to Maryview" said line being the North line of the Roger Stearns Property; thence Easterly along said North line of Roger Stearns 740 feet; thence North to the point of beginning. Containing 6.8 acres.

SECTION 2. Filing. The City Clerk is directed to file certified copies of this ordinance with the Secretary of State, County Auditor of McLeod County, the Town Clerk of the effected township and the Minnesota Municipal Board.

SECTION 3. Effective Date of Annexation. This ordinance takes effect upon the passage and publication and the filing of certified copies as directed in Section 2 and approval by

the Minnesota Municipal Board.

Adopted by the City Council this 8th day of
January, 1985.

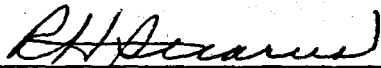

Robert H. Stearns, Mayor

ATTEST:

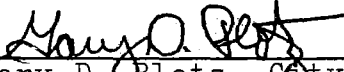

Gary D. Plotz, City Clerk

SEP 7 1984

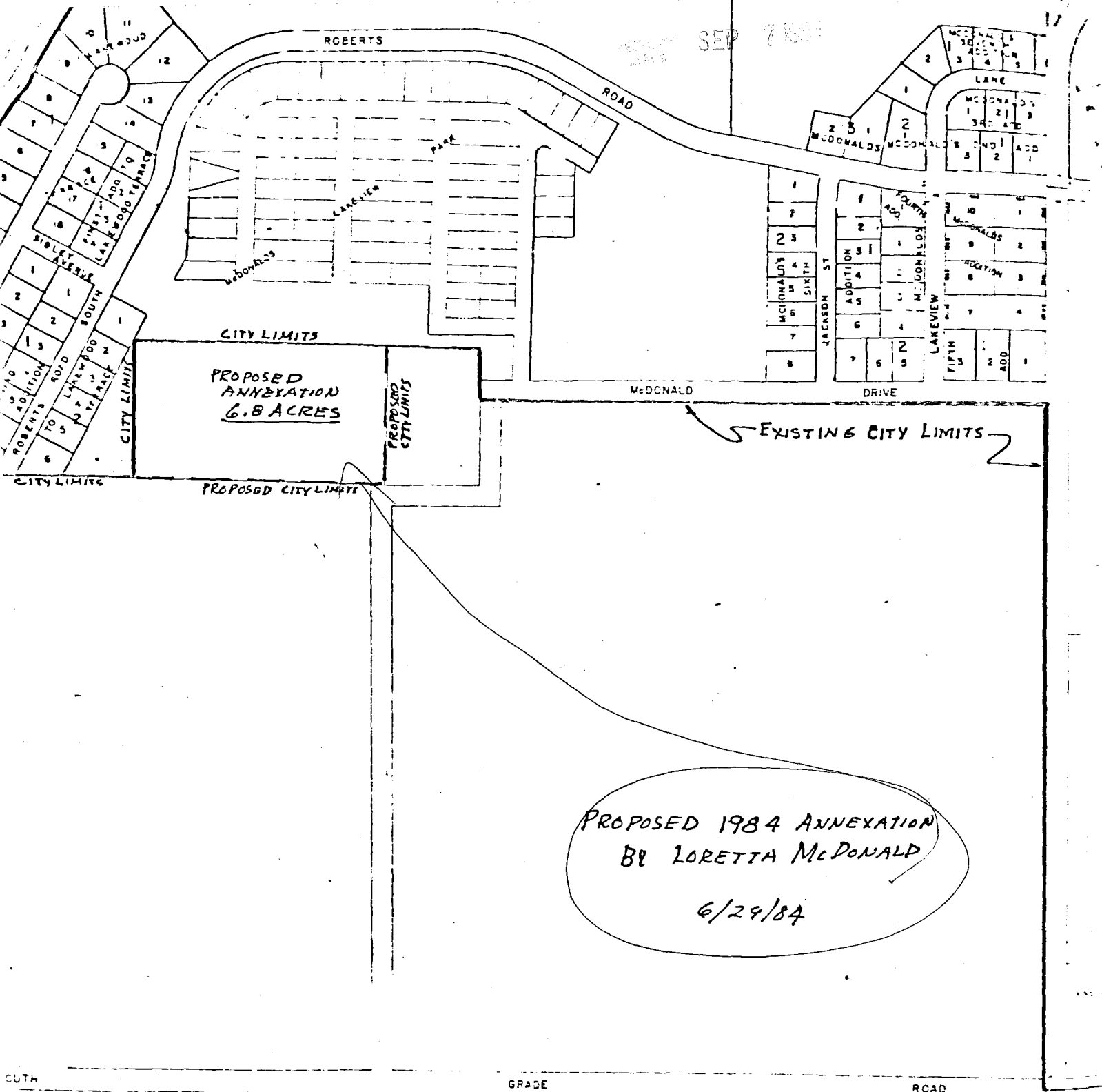

CITY LIMITS

PROPOSED ANNEXATION
6.8 ACRES

PROPOSED CITY LIMITS

EXISTING CITY LIMITS

PROPOSED 1984 ANNEXATION
BY LORETTA McDONALD
6/29/84

CITY LIMITS

PROPOSED CITY LIMITS

ROBERTS ROAD

LANEVIEW PARK

MCDONALD DRIVE

JACKSON ST

LAKEVIEW

GRADE

ROAD