

REC'D. BY SEP 7 1984
M M B



PETITION FOR ANNEXATION
TO THE CITY COUNCIL OF HUTCHINSON, MINNESOTA

The undersigned petitioner(s) respectfully represents and states that he (they) is sole owner of the following described lands:

Commencing at the NE corner of the SE 1/4 of Section 2, T116N, R30W, McLeod County, Minnesota; thence South along the East line of said Section 2, a distance of 649.00 feet; thence West, a distance of 1700.00 feet; thence North, a distance of 150.00 feet; thence West 260.00 feet to the point of beginning; thence continuing West, a distance of 740.00 feet; thence South to a point on the extension of the North line of "First Addition to Maryview" said line being the North line of the Roger Stearns Property; thence Easterly along said North line of Roger Stearns 740 feet; thence North to the point of beginning. Containing 6.8 acres.

And do respectfully request that said lands be annexed to and become part of and included in the corporate limits of the City of Hutchinson.

Date: 6-29-84

Signed: *Loretta McDonald*

" *Larry H Beeble*

SEP 7 1984

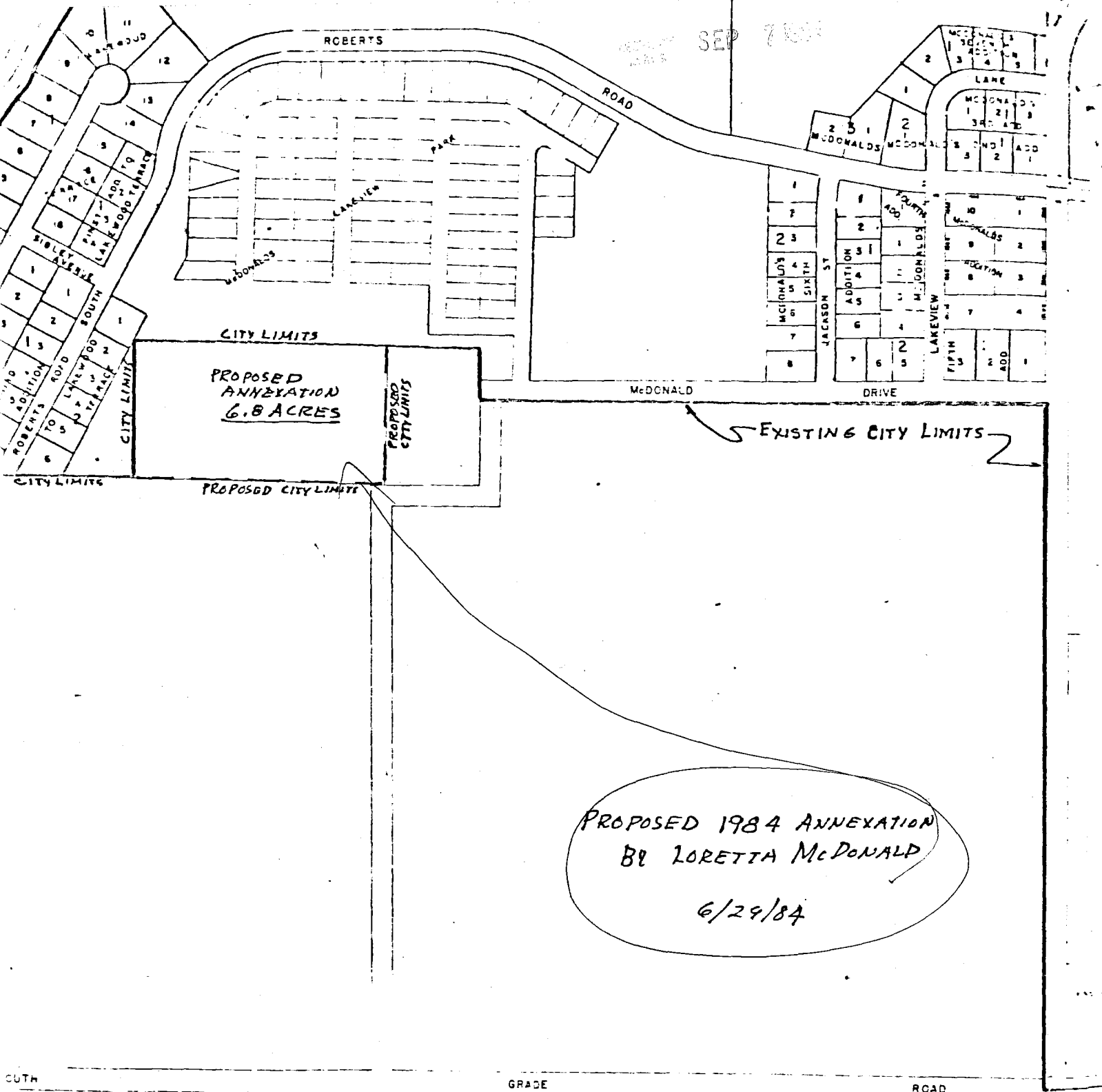

CITY LIMITS
PROPOSED ANNEXATION
6.8 ACRES

EXISTING CITY LIMITS

PROPOSED 1984 ANNEXATION
BY LORETTA McDONALD
6/29/84

CITY LIMITS

GRADE

ROAD