

ORDINANCE NUMBER 298AN ORDINANCE ANNEXING CERTAIN LANDS
OWNED BY THE CITY OF TWO HARBORS

SECTION I

Preamble: The City Council of the City of Two Harbors is the owner in fee simple of the following described real estate, and which real estate adjoins and abutts the City of Two Harbors and which the City desires to incorporate and annex into the City of Two Harbors;

The Southwest Quarter of the Southeast Quarter (SW $\frac{1}{4}$ of SE $\frac{1}{4}$) of Section Thirty (30), Township Fifty-three North (53N), Range Ten West (10W), of the Fourth Principal Meridian, according to the government survey thereof, and located in Lake County, Minnesota, and subject to reservations and restrictions of record;

The Southerly Two hundred feet of the South One-half of the Southwest Quarter (s'yly 200' of S $\frac{1}{2}$ of SW $\frac{1}{4}$), Section Thirty (30), Township Fifty-three North (53N), Range Ten West (10W) of the Fourth Principal Meridian, and subject to reservations and restrictions of record, and located in Lake County, Minnesota;

That part of the Northeast Quarter (NE $\frac{1}{4}$) of Section Thirty-one (31), Township Fifty-three North (53N), Range Ten West (10W) of the Fourth Principal Meridian lying North and West of State Highway 61, and subject to reservations and restrictions of record, and lying and being in the County of Lake, State of Minnesota.

SECTION II

Annexation and Incorporation: Pursuant to and consistent with the authority granted to the City of Two Harbors, by virtue of Minnesota Statutes 1984, Chapter 414.033, the City of Two Harbors does hereby declare as annexed, the land described above and does further incorporate and include such land within the corporate limits of the City of Two Harbors. Such land being unincorporated property and abutting the City.

SECTION III

Notifications: The City Clerk of the City of Two Harbors shall upon the passage and publication of this Ordinance, forthwith file a certified copy of this Ordinance with the Minnesota Municipal Board, the Town Clerk of the Town of Silver Creek, the County Auditor of Lake County, and the Minnesota Secretary of State.

SECTION IV

Effective Date: That this Ordinance and the annexation and incorporation into the City of Two Harbors of the above described real estate, shall become effective upon its passage and publication and the approval of the Minnesota Municipal Board.

SECTION V

Compliance with Other Laws: Upon this Ordinance becoming effective, the City Clerk is authorized and directed to undertake such action as may be necessary to carry out the intent of this Ordinance, including notification of such persons and agencies as may be required, modification of City records as may be required, and amendment of the official City map.

Dated: August 13, 1984



President, City Council

First Reading: July 30, 1984

Adoption of the foregoing Ordinance was moved by Councilor Alexander, seconded by Councilor Smith, and adopted by the following roll call vote.

Ayes: 7, Nays: 0

Second Reading: August 6, 1984

Adoption of the foregoing Ordinance was moved by Councilor Alexander, seconded by Councilor Smith, and adopted by the following roll call vote.

Ayes: 7, Nays: 0

Third Reading: August 13, 1984

Adoption of the foregoing Ordinance was moved by Councilor Alexander, seconded by Councilor Smith, and adopted by the following roll call vote.

Ayes: 7, Nays: 0

ADOPTED This 13th day of August, 1984.



President, City Council

ATTEST:

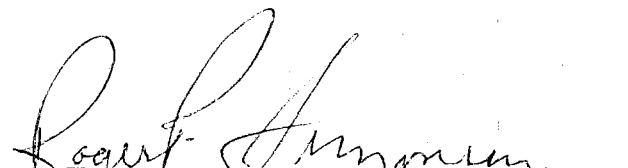

Deputy City Clerk

APPROVED by the Mayor of the City of Two Harbors, this 14th day of August, 1984.

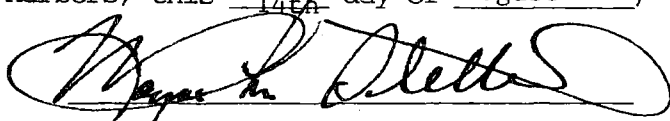

Mayor

25

30

29

INDUSTRIAL

PARK

COUNTY ROAD

200

CITY LIMIT

CITY OWNED

SW 1/4 of SW 1/4
30-53-10
12 A.

SW 1/4 of SE 1/4
30-53-10
40 A.

CITY DUMP
(CLOSED)

122

D.M.B.I.R.
35.23 ACRES
22.03 ACRES
11.92 ACRES

D.M.B.I.R.
40 ACRES
25.27 ACRES
8.68 ACRES

D.M.B.I.R.
40 ACRES
25.5 ACRES
11.47 ACRES

D
M
P
S
I
R

C
S
A
H

CITY LIMIT

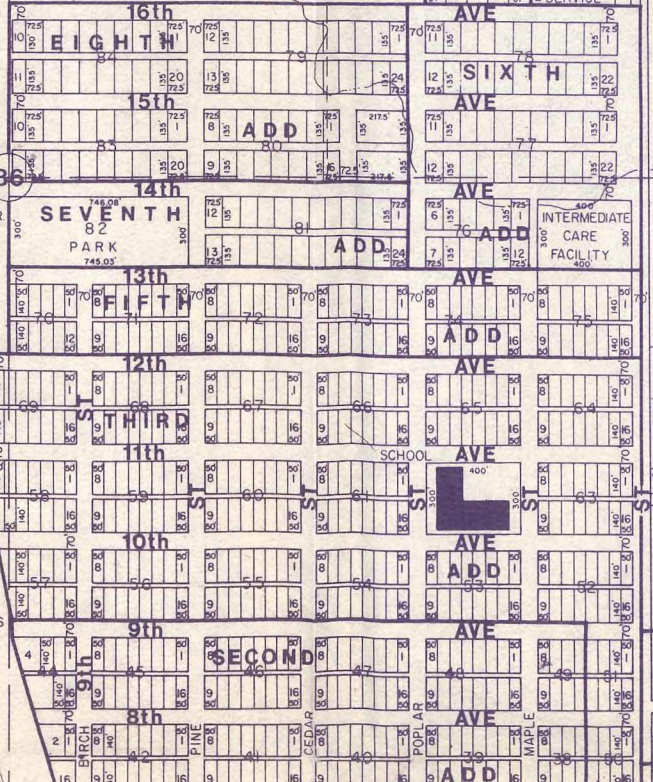

FLOOD BAY

HWY 61

PART of NE 1/4
N + W of Hwy 61
31-53-10
141 A.



U.S. STEEL
29.92 ACRES
SKUNK CREEK

ARENA

BAY VIEW SUBD

U S

CAMP

BAY