

ORDINANCE NO.

2372

REC'D. BY
M.M.B.

JUL 5 1984

AN ORDINANCE ANNEXING TO THE CITY OF
ROCHESTER, MINNESOTA, CERTAIN
PLATTED LAND IN GOLDEN HILL
ADDITION, ROCHESTER TOWNSHIP,
OLMSTED COUNTY, MINNESOTA.

THE COMMON COUNCIL OF THE CITY OF ROCHESTER DO ORDAIN:

Section 1. A petition has been filed with the Common Council of the City of Rochester, signed by the owners of land described herein, requesting the Common Council to annex said land to the City of Rochester. The land described in said petition for annexation is located in Rochester Township, Olmsted County, Minnesota, and is described as follows:

The South 87 feet of Lot 5, Block 15, and the North One-Third of Lot 6, Block 15 including the adjacent right-of-way for First Avenue SW, originally platted as "Oaks Avenue," Golden Hill Addition, Olmsted County.

Said petition has also been filed with the Town Board of Rochester Township, with the County Board of the County of Olmsted, and with the Minnesota Municipal Commission, and the Town Board of Rochester Township has notified the City that it has no objections to the annexation of the above-described land.

Section 2. The quantity of land included in said petition is approximately .95 of an acre in size.

Section 3. The Common Council of the City of Rochester does hereby determine that the land described in Section 1 abuts upon the present territorial limits of the City of Rochester, is so conditioned as to be properly subjected to municipal government, and the annexation of said land will be in the best interest of the City of Rochester and the land described.

Section 4. Therefore, the land described in Section 1 above is hereby annexed, added to and made a part of the City of Rochester, Minnesota, as effectually as if it had originally been a part thereof.

Section 5. Present and future owners of the area annexed by this ordinance are hereby notified that in addition to the usual assessments, it is the intention of the Common Council to assess against benefited property all or a portion of the cost of any storm sewer, water tower, and trunk line sanitary sewer construction, heretofore or hereafter undertaken to serve the area annexed.

Section 6. This ordinance shall take effect and be in force from and after its official publication and from and after the filing of a certified copy hereof with the Minnesota Municipal Board, the Rochester Town Clerk, the County Auditor, and the Secretary of State.

PASSED AND ADOPTED BY THE COMMON COUNCIL OF THE CITY OF ROCHESTER, MINNESOTA, THIS 7th DAY OF MAY, 1984.

R. J. Postner
PRESIDENT OF SAID COMMON COUNCIL

ATTEST: Carol H. Gumm
CITY CLERK

Approved this 8th day of MAY, 1984.

Chuck Hazen
MAYOR OF SAID CITY

(Seal of the City of Rochester, Minnesota)

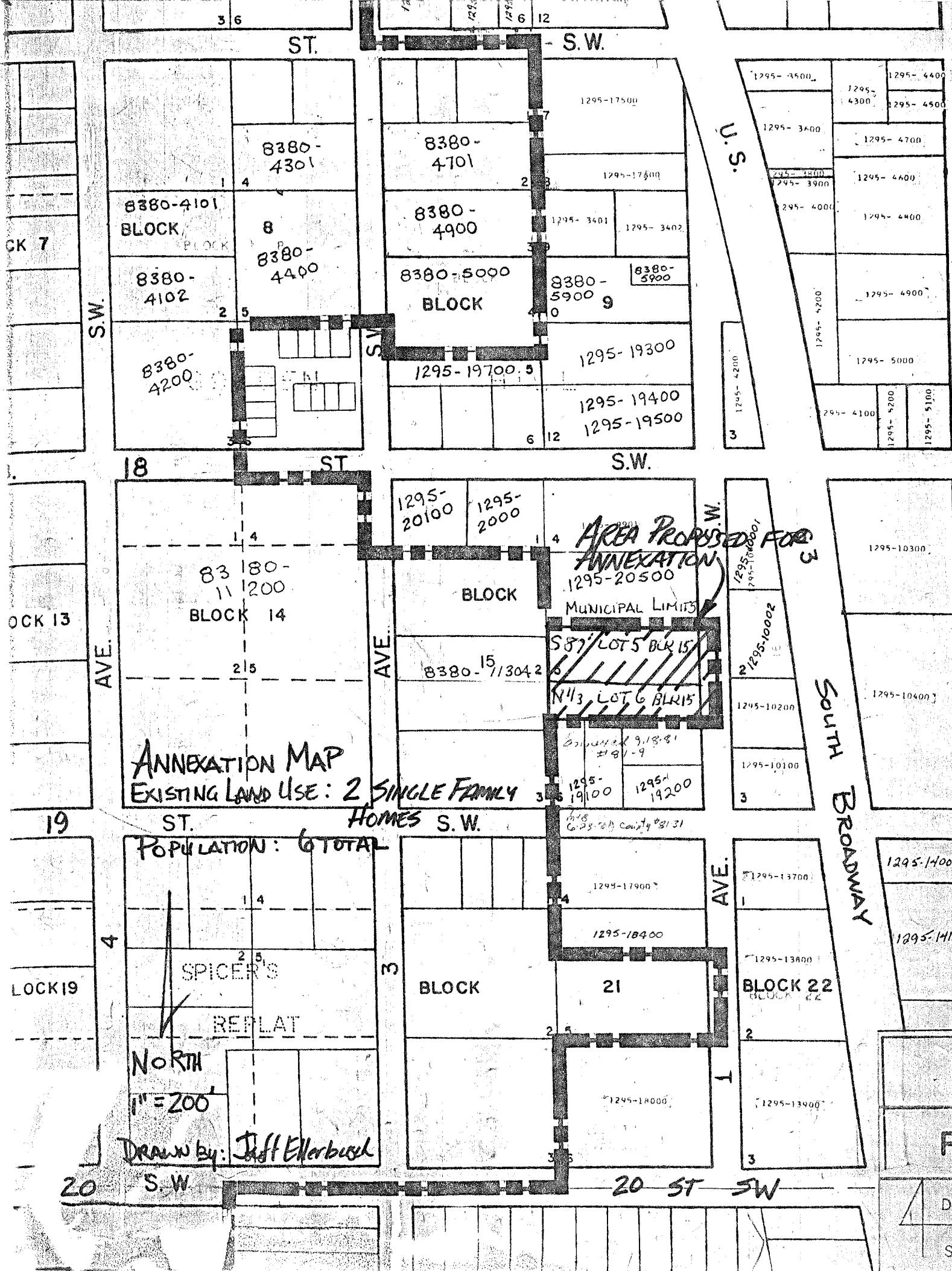

ANNEXATION MAP
 EXISTING LAND USE: 2 SINGLE FAMILY

POPULATION: 6 TOTAL

NORTH

1" = 200'

Drawn by: Jeff Ellerbusch

AREA PROPOSED FOR
 ANNEXATION
 MUNICIPAL LIMITS

S 87 LOT 5 BLK 15
 N 1/3 LOT 6 BLK 15

ST. S.W.

U.S.

S.W.

S.W.

AVE.

AVE.

AVE.

SOUTH BROADWAY

19 ST.

HOMES S.W.

20 S.W.

20 ST SW

8380-11200
 BLOCK 14

BLOCK

8380-1513042

BLOCK

21

BLOCK 22

8380-4101
 BLOCK

8380-4301

8380-4701

8380-4900

8380-5000
 BLOCK

8380-5900

8380-4200

8380-4400

1295-19700.5

1295-19300

1295-19400
 1295-19500

1295-20100

1295-2000

AREA PROPOSED FOR ANNEXATION

1295-20500

MUNICIPAL LIMITS

S 87 LOT 5 BLK 15

N 1/3 LOT 6 BLK 15

Survey 9.13.81 #81-9

1295-19100

1295-19200

1918 Co. 23. 2nd County #31 31

1295-17900

1295-18400

1295-18000

1295-13700

1295-13600

1295-13400

1295-10300

1295-10400

1295-1400

1295-1410

1295-3500
 1295-4300
 1295-4400
 1295-4500

1295-3600

1295-4700

1295-17500

1295-17500

1295-3401

1295-3402

1295-4200

1295-3900

1295-4600

1295-4000

1295-4400

1295-4900

1295-5000

1295-4100

1295-5200

1295-5100

1295-4200

1295-4200

1295-10000

1295-10002

1295-10200

1295-10100

3

CK 7

OCK 13

19

LOCK 19

20

P

D

S