

ORDINANCE NO. 2409

AN ORDINANCE ANNEXING TO THE CITY OF
ROCHESTER, MINNESOTA, CERTAIN
PLATTED LAND IN HILLCREST
SUBDIVISION, ROCHESTER TOWNSHIP,
OLMSTED COUNTY, MINNESOTA.

THE COMMON COUNCIL OF THE CITY OF ROCHESTER DO ORDAIN:

Section 1. A petition has been filed with the Common Council of the City of Rochester, signed by the owners of land described herein, requesting the Common Council to annex said land to the City of Rochester. The land described in said petition for annexation is located in Rochester Township, Olmsted County, Minnesota, and is described as follows:

Lot 1; Lot 4; Lot 7; Lot 2 less the south 49.7 feet of the East 150 feet thereof; Lot 3 less the East 150 feet thereof; Lot 8 less the East 200 feet of the North 100 feet thereof and less the South 200 feet thereof; and the West 161 feet of Outlot A all in the plat of Hillcrest Subdivision.

Said petition has also been filed with the Town Board of Rochester Township, with the County Board of the County of Olmsted, and with the Minnesota Municipal Commission, and the Town Board of Rochester Township has notified the City that it has no objections to the annexation of the above-described land.

Section 2. The quantity of land included in said petition is approximately 7.94 acres in size.

Section 3. The Common Council of the City of Rochester does hereby determine that the land described in Section 1 abuts upon the present territorial limits of the City of Rochester, is so conditioned as to be properly subjected to municipal government, and the annexation of said land will be in the best interest of the City of Rochester and the land described.

Section 4. Therefore, the land described in Section 1 above is hereby annexed, added to and made a part of the City of Rochester, Minnesota, as effectually as if it had originally been a part thereof.

Section 5. Present and future owners of the area annexed by this ordinance are hereby notified that in addition to the usual assessments, it is the intention of the Common Council to assess against benefited property all or a portion of the cost of any storm sewer, water tower, and trunk line sanitary sewer construction, heretofore or hereafter undertaken to serve the area annexed.

Section 6. This ordinance shall take effect and be in force from and after its official publication and from and after the filing of a certified copy hereof with the Minnesota Municipal Board, the Rochester Town Clerk, the County Auditor, and the Secretary of State.

Passed and adopted by the Common Council of the City of Rochester, Minnesota, this 17 day of December, 1984.

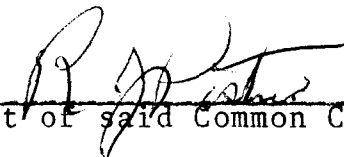

President of said Common Council

Attest: 

City Clerk

Approved this 18 day of December, 1984.

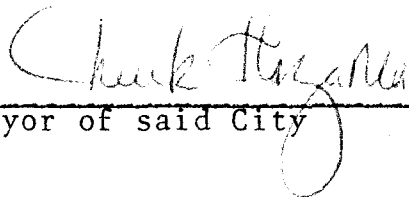

Mayor of said City

(Seal of the City of
Rochester, Minnesota)

APPLICANT'S PROPOSAL FOR ANNEXATION



40302

40303

COUNTY ROAD 34

MILLER PROPERTY

CASCADE TOWNSHIP

ROCHESTER TOWNSHIP

WRIGHT, DUNN, HENDERSON PROPERTY

HIGHLAND COURT SW

4 ST. SW

HILLOREST

CITY LIMITS

23 AVE. S.W.

RUSSELL

TERREVILLE

1690-100

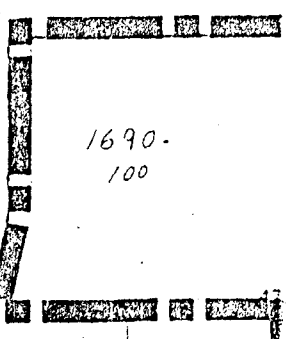
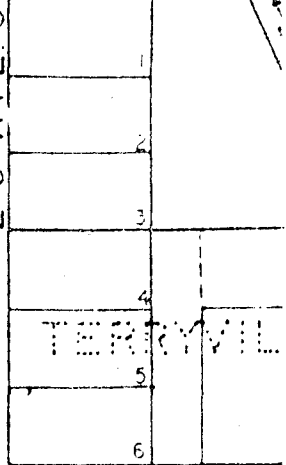
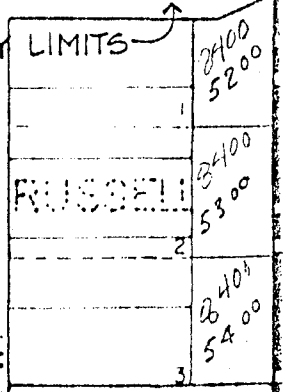
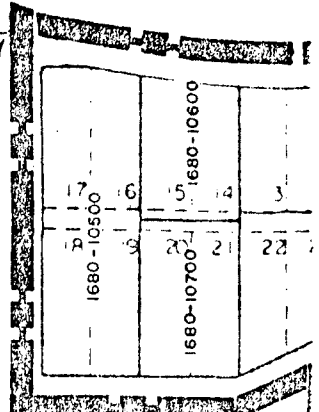
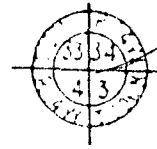

19 20

21 22

C.R. 34

STAFF COMMENDATION FOR ANNEXATION (INCLUDES R.O.W FOR C.R. 34)



40302

40303

CASCADE TOWNSHIP
ROCHESTER TOWNSHIP

MILLER PROPERTY

WRIGHT, DUNN,
HENDERSON PROPERTY

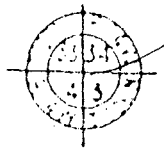

HIGHLAND COURT SW

4 ST. SW

CITY LIMITS

HILLCREST

23 AVE. S.W.

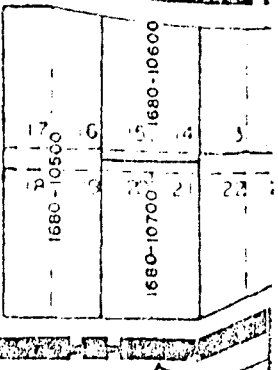

2400
5200
3400
5300
2
2400
5400
3

RUSSELL

TERRIVIL

1690-
100

19 20

C 22

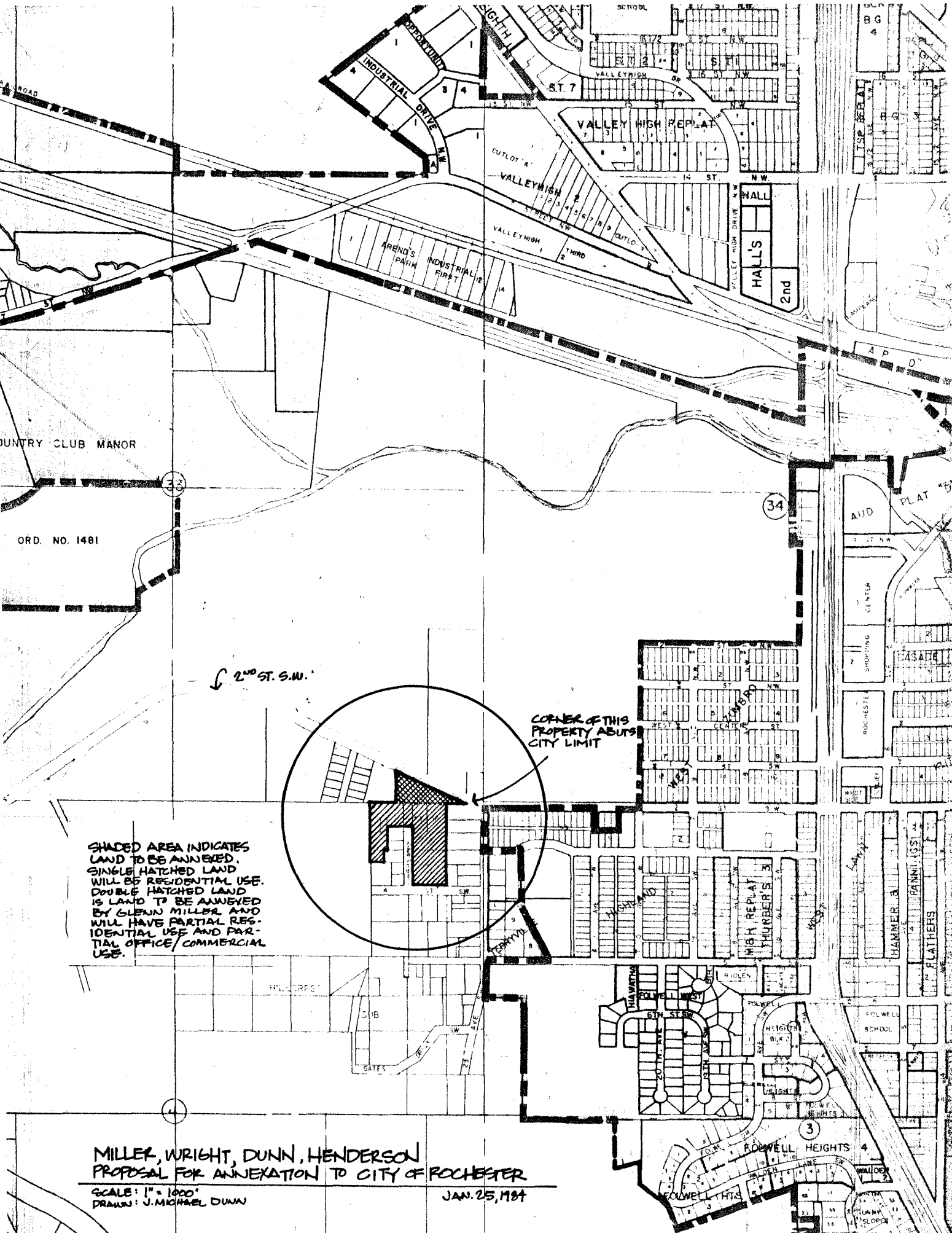

COUNTRY CLUB MANOR

ORD. NO. 1481

↪ 2ND ST. S.W.

CORNER OF THIS PROPERTY ADJUTS CITY LIMIT

SHADED AREA INDICATES LAND TO BE ANNEXED. SINGLE HATCHED LAND WILL BE RESIDENTIAL USE. DOUBLE HATCHED LAND IS LAND TO BE ANNEXED BY GLENN MILLER AND WILL HAVE PARTIAL RESIDENTIAL USE AND PARTIAL OFFICE/COMMERCIAL USE.

MILLER, WRIGHT, DUNN, HENDERSON PROPOSAL FOR ANNEXATION TO CITY OF ROCHESTER

SCALE: 1" = 1000'
DRAWN: J. MICHAEL DUNN

JAN. 25, 1984

REC'D. BY MMB FEB 16 1984