

O-84-0227-139

AN ORDINANCE FOR THE PURPOSE OF
EXTENDING THE CORPORATE LIMITS OF
THE CITY OF MANKATO TO INCLUDE
CERTAIN UNINCORPORATED, UNPLATTED
PROPERTY WHICH IS BORDERED BY
PROPERTY WITHIN THE CITY

WHEREAS, certain property described below is not presently included in the corporate limits of any incorporated city, village, or borough; and

WHEREAS, the owner of the property described below has petitioned the City of Mankato for annexation of such property; and

WHEREAS, the property is located adjacent to existing City boundaries and can be served with public utilities; and

WHEREAS, the Council of the City of Mankato finds that the property is about to become urban in character and no objections to the annexation have been forthcoming;

NOW, THEREFORE, the City of Mankato hereby ordains that the corporate limits of the City are hereby extended to include the land described as follows and the same is hereby annexed to and included within the City as effectually as if it had originally been part thereof:

The east 45.45 acres (easterly of centerline of ravine) of the south half of the southeast quarter of Section 19, Township 108 North, Range 26 West, Blue Earth County, Minnesota, excepting therefrom the following described parcel previously annexed to the City of Mankato, to-wit:

That part of the southeast quarter of the southeast quarter of Section 19, Township 108 North, Range 26 West, Blue Earth County, Minnesota, described as:

Commencing at the southeast corner of Section 19, thence north 00 degrees 00 minutes 00 seconds east (assumed bearing) along the east line of the southeast quarter of Section 19, a distance of 557 feet to the point of beginning; thence continuing north 00 degrees 00 minutes 00 seconds east along said east line, the same being the centerline on Monks Avenue, a distance of 140 feet; thence south 90 degrees 00 minutes 00 seconds west 210 feet; thence south 00 degrees 00 minutes 00 seconds west, and parallel with the east line of the southeast quarter of Section 19, a distance of 140 feet; thence north 90 degrees 00 minutes 00 seconds east 210 feet to the point of beginning.

The City Clerk is hereby directed to file copies of this ordinance with the Minnesota Municipal Board, the Secretary of State, the Blue Earth County Auditor and the Mankato Town Board.

This ordinance shall take effect 30 days after its passage, due publication thereof and approval by the Minnesota Municipal Board.

Adopted this 27th day of February, 1984.

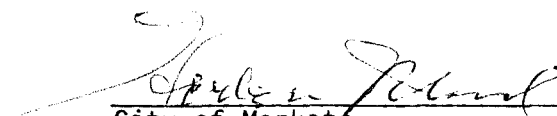

City of Mankato
By Herbert Mocol, Mayor

ATTEST: 
Secretary to the Council

I hereby certify that notice of the adoption of the ordinance set forth above was published in the Mankato Free Press on the _____ day of _____, 1984.

Carla Raberge
City Clerk

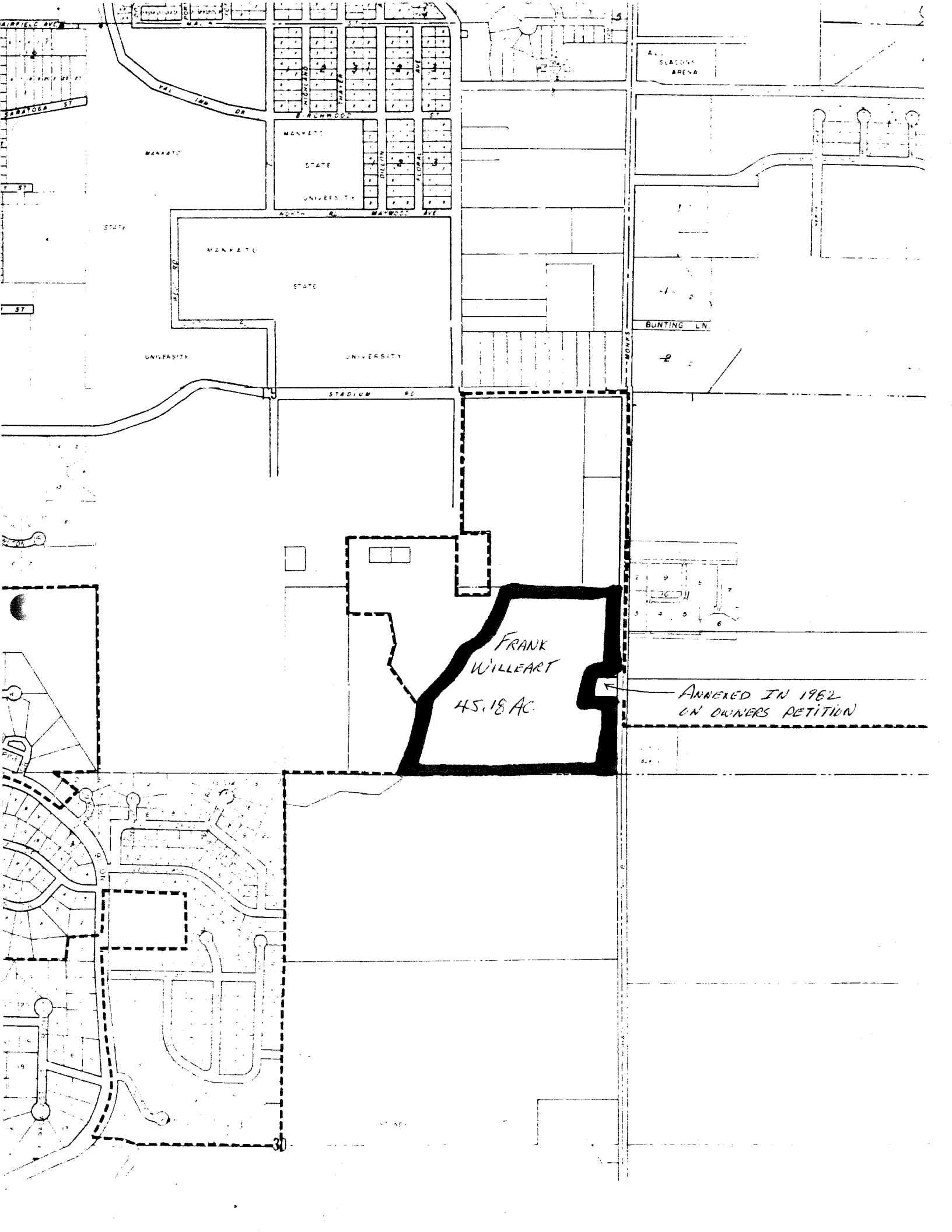

FRANK
WILLEART
45.18 AC.

ANNEXED IN 1962
ON OWNERS PETITION

SLAUGHTER
ARENA

BUNTING LN.

STADIUM RD.

MANHATTAN

STATE

UNIVERSITY

UNIVERSITY

STATE

MANHATTAN

MANHATTAN
STATE
UNIVERSITY

AIRFIELD AVE
SARATOGA ST

37

WOLFE

20711
1 2 3 4 5 6 7

30