

PETITION FOR ANNEXATION

REC'D. BY  
MMR

JUL 29 1983

In the matter of the Petition of Rudy Prestholdt and Bernice Prestholdt, husband and wife, Leonard Liebl and Ione Liebl, husband and wife, and Dawson Cemetery Association, for annexation by ordinance of unincorporated property to the City of Dawson.

TO THE HONORABLE CITY COUNCIL OF THE CITY OF DAWSON, COUNTY OF LAC QUI PARLE, STATE OF MINNESOTA

The undersigned petitioners respectfully represent and show to the City Council:

1. That they are the majority of the owners of certain real estate lying and being in the County of Lac qui Parle, State of Minnesota, described as follows, to-wit: See Schedule A attached hereto,

2. That said real estate is within the Town of Riverside in the County of Lac qui Parle, State of Minnesota, and is an unplatted tract of land not exceeding two hundred acres.

3. That said real estate is contiguous with the corporate limits of said City of Dawson and is not included in any other municipality.

4. That said property is suitable for commercial development adaptable to urban government.

5. That it will be for the best interest of said City of Dawson and Town of Riverside that said real estate be annexed to the City of Dawson.

THEREFORE, your petitioners pray that the City of Dawson, by ordinance, declare such land annexed to the City of Dawson

Rudy Prestholdt  
Rudy Prestholdt

Bernice Prestholdt  
Bernice Prestholdt

Leonard Liebl  
Leonard Liebl

Ione Liebl  
Ione Liebl

DAWSON CEMETERY ASSOCIATION

By Walter Bergendahl  
Its W. Bergendahl

SCHEDULE A

Tracts of land located in the Northwest Quarter of the Northwest Quarter ( $NW\frac{1}{4}NW\frac{1}{4}$ ) of Section Twenty-two (22), Township One Hundred Seventeen (117) North, of Range Forty-three (43) West, beginning at the Northwest corner of said section, thence east on the section line twelve point seventy-six chains (12.76 ch), thence south five point five chains (5.5 ch), thence west twelve point seventy-six chains (12.76 ch) to the west line of said section, thence north on said west section line to the place of beginning; also a tract of land beginning at a point twelve point seventy-six chains (12.76 ch) east of the Northwest corner of said section, thence continuing east on the north line of said section to the Northeast corner of the Northwest Quarter of the Northwest Quarter ( $NW\frac{1}{4}NW\frac{1}{4}$ ) of said section, thence south one hundred feet, thence west to the east line of the above described tract, thence north to the place of beginning; *ordnance say 370' of the SE 1/4...* also the Southeast Quarter of the Southwest Quarter ( $SE\frac{1}{4}SW\frac{1}{4}$ ) of Section *(much smaller than 40 acres listed here)* Fifteen (15), Township One Hundred Seventeen (117) North, of Range Forty-three (43) West.



# MAP OF RIVERSIDE

REC'D. BY JUL 29 1983



TOWNSHIP: 117 N

CODE: RS

RANGE: 43 W

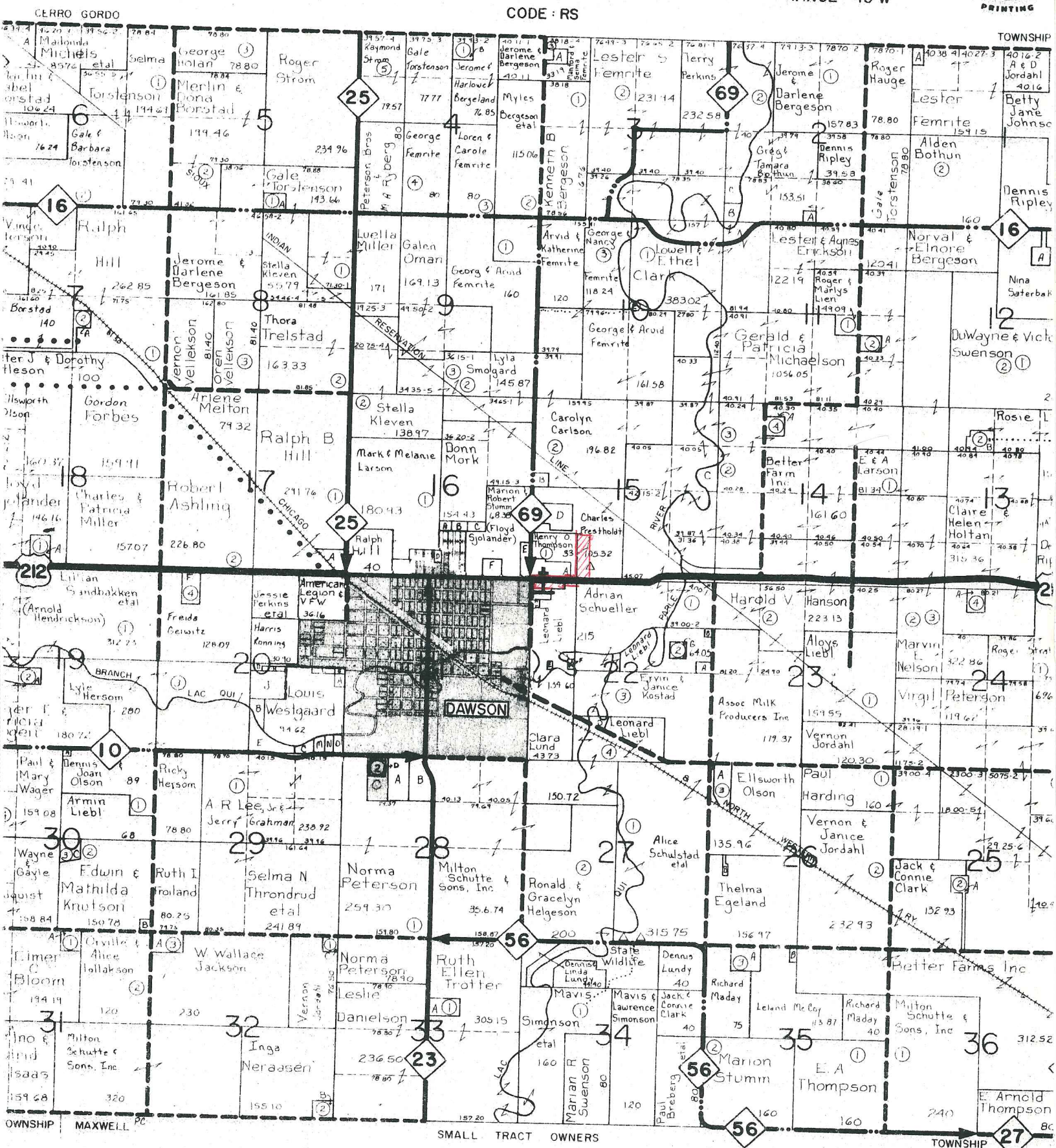

SEE SMALL TRACT SECTION FOLLOWING TOWNSHIP MAPS