

RESOLUTION NO. 2005-103

**IN THE MATTER OF THE AMENDMENT TO THE JOINT RESOLUTION
FOR ORDERLY ANNEXATION BETWEEN THE TOWNSHIP OF ISANTI
AND THE CITY OF ISANTI, MINNESOTA PURSUANT TO MINNESOTA
STATUTES 414.0325. SUBD. 1**

**TO: OFFICE OF STRATEGIC & LONG RANGE PLANNING, ROOM 300, 658
CEDAR STREET, ST. PAUL, MN 55155:**

WHEREAS, the Township of Isanti and the City of Isanti are parties to a Joint Resolution for Orderly Annexation, which Joint Resolution was duly filed with the Municipal Board on August 31, 1973, (File No: A-2457(OA) which Resolution has since been amended to include additional lands; and,

WHEREAS, the lands described on the attached Exhibit "A", incorporated herein by this reference, are included in the area designated by said Joint Resolution as properly subject to and in need of Orderly Annexation as provided by Statute;

**NOW, THEREFORE, BE IT RESOLVED BY THE TOWNSHIP OF
ISANTI AND THE CITY OF ISANTI, AS FOLLOWS:**

1. Both the Township and the City agree that no alteration of the stated boundaries of the lands herein designated for annexation pursuant to this Resolution, as described on Exhibit "A" attached hereto and made a part hereof is appropriate. Further, both the City and Township agree that pursuant to Minnesota Statutes 414.0325, Subd. 1, no consideration by the Office of Strategic & Long Range Planning, is necessary for annexation of the herein described territory to the City of Isanti. Upon receipt of this Resolution, the Office of Strategic & Long Range Planning may review and comment, but shall, within thirty (30) days, order the annexation of the property as described on the attached Exhibit "A" in accordance with the terms of this Joint Resolution.

Adopted by Resolution of the Isanti Township Board this 12 day of July
2002.

2005

ISANTI TOWNSHIP BOARD

By: Michael E. Blum
Its: Chairman

By: Ann Butler
Its: Township Clerk

Exhibit "A"

PID: 050313100

3.22 Acre Parcel

Isanti County, Minnesota, to-wit:

The East 246.25 feet of the West 661.25 feet of the North 570 feet of the Southwest Quarter of the Northeast Quarter (SW $\frac{1}{4}$ of NE $\frac{1}{4}$) of Section Thirty-one (31), Township Thirty-five (35), Range Twenty-three (23), subject to roads, easements and restrictions if any.

JUL 26 2005

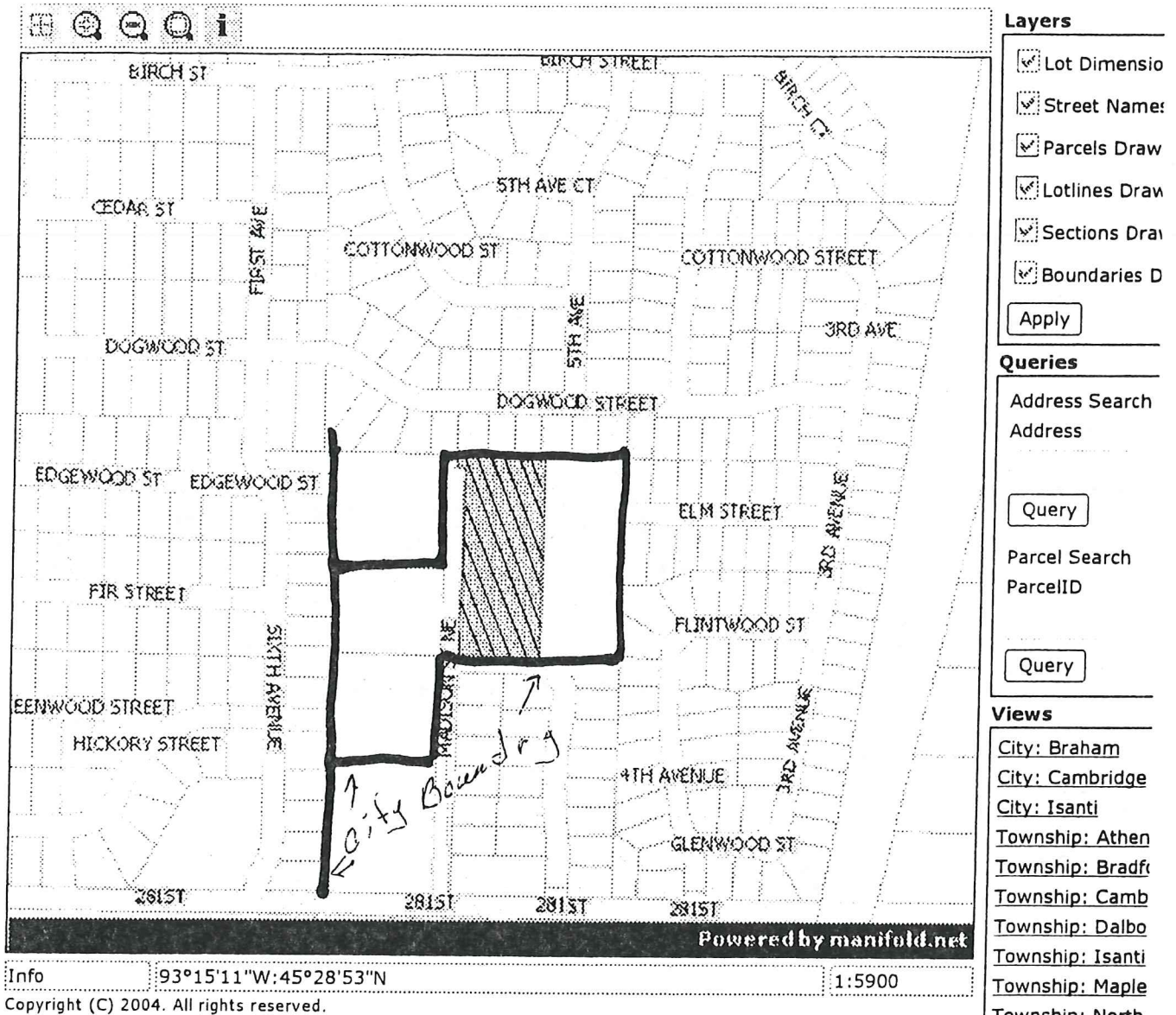

DETAIL [Click for More Information](#)

PID 050313100

TAX_YR 2006

OWNER DANIEL C ANTILLA &

SITUS 28211 MADISON ST NE

SITUS_CITY ISANTI

ACRES 3.22

SEC 31

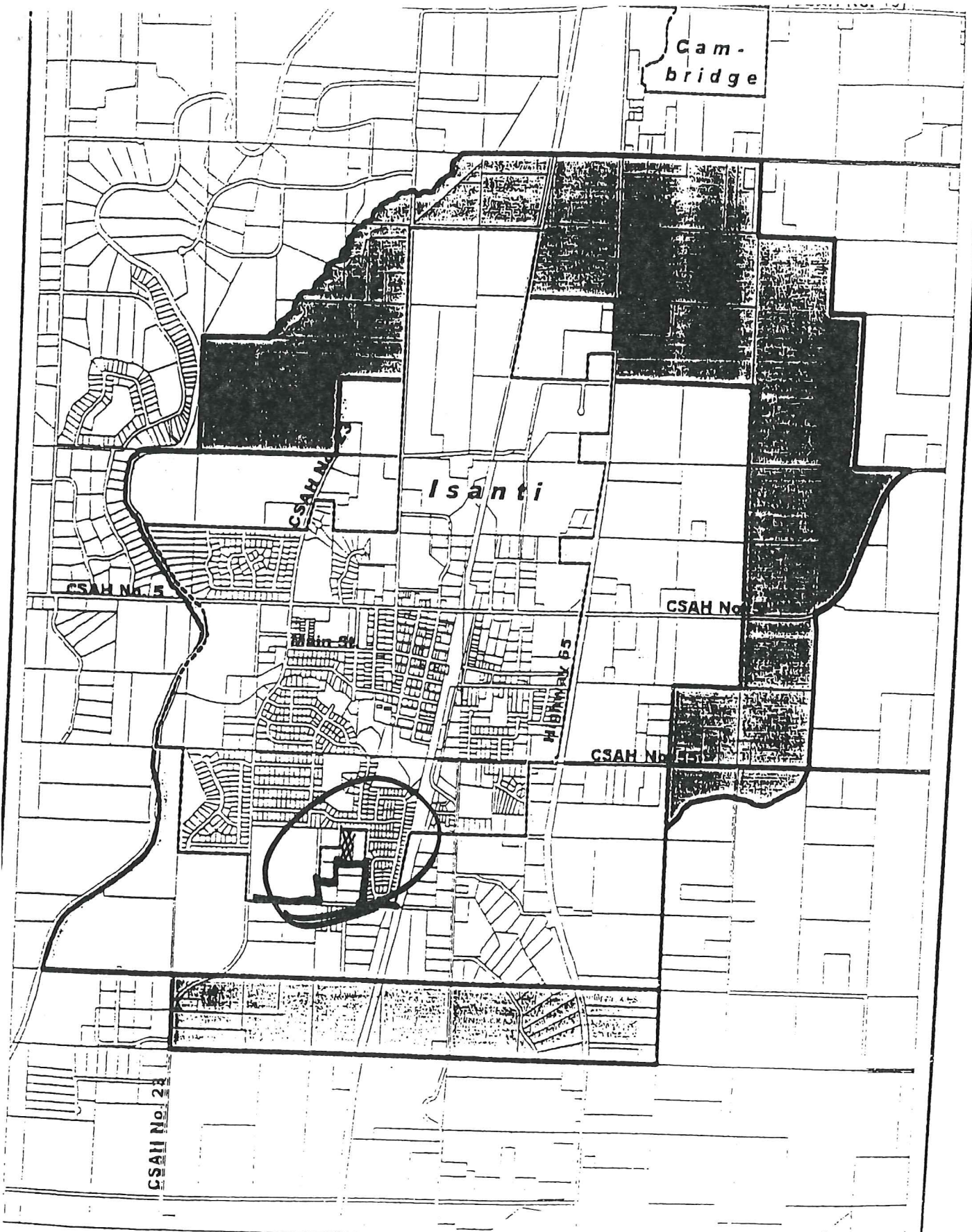





Figure 8.
 Proposed USA Tier I Boundary
 Isanti, Minnesota

-  City Boundary
-  Existing USA Boundary
-  Proposed USA Boundary

REC'D BY
 MMB JUL 26 2005

