

APR 18 2002

RESOLUTION NO. 2002-031

IN THE MATTER OF THE AMENDMENT TO THE JOINT RESOLUTION  
FOR ORDERLY ANNEXATION BETWEEN THE TOWNSHIP OF ISANTI  
AND THE CITY OF ISANTI, MINNESOTA PURSUANT TO MINNESOTA  
STATUTES 414.0325. SUBD. 1

TO: OFFICE OF STRATEGIC & LONG RANGE PLANNING, ROOM 300, 658  
CEDAR STREET, ST. PAUL, MN 55155:

WHEREAS, the Township of Isanti and the City of Isanti are parties to a Joint Resolution for Orderly Annexation, which Joint Resolution was duly filed with the Municipal Board on August 31, 1973, (File No: A-2457(OA) which Resolution has since been amended to include additional lands; and,

WHEREAS, the lands described on the attached Exhibit "A", incorporated herein by this reference, are included in the area designated by said Joint Resolution as properly subject to and in need of Orderly Annexation as provided by Statute;

NOW, THEREFORE, BE IT RESOLVED BY THE TOWNSHIP OF  
ISANTI AND THE CITY OF ISANTI, AS FOLLOWS:

1. Both the Township and the City agree that no alteration of the stated boundaries of the lands herein designated for annexation pursuant to this Resolution, as described on Exhibit "A" attached hereto and made a part hereof is appropriate. Further, both the City and Township agree that pursuant to Minnesota Statutes 414.0325, Subd. 1, no consideration by the Office of Strategic & Long Range Planning, is necessary for annexation of the herein described territory to the City of Isanti. Upon receipt of this Resolution, the Office of Strategic & Long Range Planning may review and comment, but shall, within thirty (30) days, order the annexation of the property as described on the attached Exhibit "A" in accordance with the terms of this Joint Resolution.

Adopted by Resolution of the Isanti Township Board this 8<sup>th</sup> day of April  
2002.

ISANTI TOWNSHIP BOARD

By: Michael E. Blund

Its: Chairman

By: Dean Dettmer

Its: Township Clerk

**Exhibit "A"**

The Northwest Quarter of the Northeast Quarter (NW  $\frac{1}{4}$  of NE  $\frac{1}{4}$ ) of Section Thirty (30), Township Thirty-five (35), Range Twenty-three (23), excepting therefrom, however, those certain tracts of land described as follows:

- A. That part of the NW  $\frac{1}{4}$  of NE  $\frac{1}{4}$ , Section 30, Township 35, Range 23, described by metes and bounds as follows: Commencing at a point on the North line of said Section, 19 rods East of the Northwest corner of said NW  $\frac{1}{4}$  of NE  $\frac{1}{4}$ , thence continuing East following the north line of said Section a distance of 8 rods, thence South and parallel to the North and South Quarter line a distance of 20 rods, thence West and parallel to the North line of said Section a distance of 11 rods, thence Northeasterly 20 rods, more or less, to the point of beginning and there to terminate (Warranty Deed recorded in Book "54" of Deeds, page 302).
- B. That part of the NW  $\frac{1}{4}$  of NE  $\frac{1}{4}$ , Section 30, Township 35, Range 23, described by metes and bounds as follows, to-wit: Commencing at a point on the North and South Quarter line in said Section, Township and Range 410 feet North of the Southwest corner of said NW  $\frac{1}{4}$  of NE  $\frac{1}{4}$ , thence East and parallel to the North  $\frac{1}{16}^{\text{th}}$  line a distance of 225 feet, thence North and parallel to the North and South Quarter line a distance of 240 feet, thence West parallel to the North  $\frac{1}{16}^{\text{th}}$  line to the north and South Quarter line, thence South following the North and South Quarter a distance of 240 feet to the place of beginning and there to terminate (Warranty Deed recorded in Book "58" of Deeds, page 280).
- C. That part of the NW  $\frac{1}{4}$  of NE  $\frac{1}{4}$ , Section 30, Township 35, Range 23, described by metes and bounds as follows, to-wit: Commencing at a point on the north line of said Section 30, 19 rods East of the Northwest corner of said NW  $\frac{1}{4}$  of NE  $\frac{1}{4}$ , thence West following the North line of said Section a distance of 7.6 rods, thence in a Southwesterly direction and parallel to the public roadway as presently existing and laid out a distance of 16 rods, thence in a Southeasterly direction of 15 rods more or less and to the Southwest corner of that certain parcel of land conveyed by a Warranty Deed running from Roger A. Carlson and Faye M. Carlson, his wife to David S. Sperry and Paulletta Sperry, his wife, dated September 1, 1966, filed for record in the Office of the Register of Deeds, Isanti County, Minnesota on September 13, 1966, in Book "63" of Deeds, page 222-223, thence in a Northeasterly direction and along the West line of said parcel recorded in Book "63" of Deeds, page 222-223, a distance of 20 rods more or less and to point of beginning (Warranty Deed recorded in Book "65" of Deeds, page 29).
- D. That part of the NW  $\frac{1}{4}$  of NE  $\frac{1}{4}$ , Section 30, Township 35, Range 23, described as follows, to-wit: Beginning at a point on the North line of

Section 30, 27 rods East of the Northwest corner of the NW  $\frac{1}{4}$  of NE  $\frac{1}{4}$ , thence South parallel to the North-South quarter line 20 rods FOR THE ACTUAL POINT OF COMMENCEMENT OF THE TRACT TO BE DESCRIBED: Thence West parallel to the North line of Section 30, to the East right-of-way line of the public road as now located; thence Southwesterly on the East right-of-way line of said public road, to a point thereon 650 feet North, as measured at right angles, from the South line of said NW  $\frac{1}{4}$  of NE  $\frac{1}{4}$ ; thence East parallel to the North  $\frac{1}{16}$ <sup>th</sup> line to a point 650 feet North and 225 feet East of the Southwest corner of said NW  $\frac{1}{4}$  of NE  $\frac{1}{4}$ ; thence South parallel to the North-South quarter line, 66 feet thence East 150 feet; thence North 405 feet, more or less, to the actual point of commencement and there terminating (Warranty Deed recorded in Book "66" of Deeds, page 231).

- E. The NE  $\frac{1}{4}$  of NE  $\frac{1}{4}$  of NW  $\frac{1}{4}$  of NE  $\frac{1}{4}$  of Section 30, Township 35, Range 23, subject to roads, restrictions and reservations of record, if any (Warranty Deed recorded in Book "92" of Deeds, page 109).
- F. That part of the Northwest Quarter of the Northeast Quarter of Section 30, Township 35, Range 23, Isanti County, Minnesota, described as follows: Commencing at a point on the north line of Section 30, 27 rods East of the northwest corner of the NW  $\frac{1}{4}$  of NE  $\frac{1}{4}$  of Section 30; thence South parallel with the North-South quarter line, 20 rods; thence West parallel with the north line of section 30, 11 rods to the point of beginning of the parcel to be herein described, said point is also the southwest corner of that certain parcel of land conveyed by a Warranty Deed running from Roger A. Carlson and Faye M. Carlson, his wife, to David S. Sperry and Paultetta Sperry, his wife, dated September 1<sup>st</sup>, 1966, filed for record in the office of the Register of Deeds, Isanti County, Minnesota on September 13, 1966, in book "63" of Deeds, page 222-223 and said point is also the southeast corner of that parcel described on Warranty Deed filed for record in book 65 of Deeds, page 29, in the office of the Register of Deeds, Isanti County, Minnesota; thence northwesterly along the southerly line of said parcel described on Warranty Deed recorded in book 65 of Deeds, page 29 to the easterly line of Parcel Number 8 of the CITY OF ISANTI RIGHT OF WAY PLAT NO. 1 on file in the office of the County Recorder, Isanti County, Minnesota; thence southwesterly, along said easterly line to the point of intersection with a line drawn thru the point of beginning of the parcel herein described and drawn parallel with the north line of Section 30, thence East, along said line to the point of beginning.



REC'D BY  
M.M.B. APR 18 2002

COMMUNITY BASE MAP

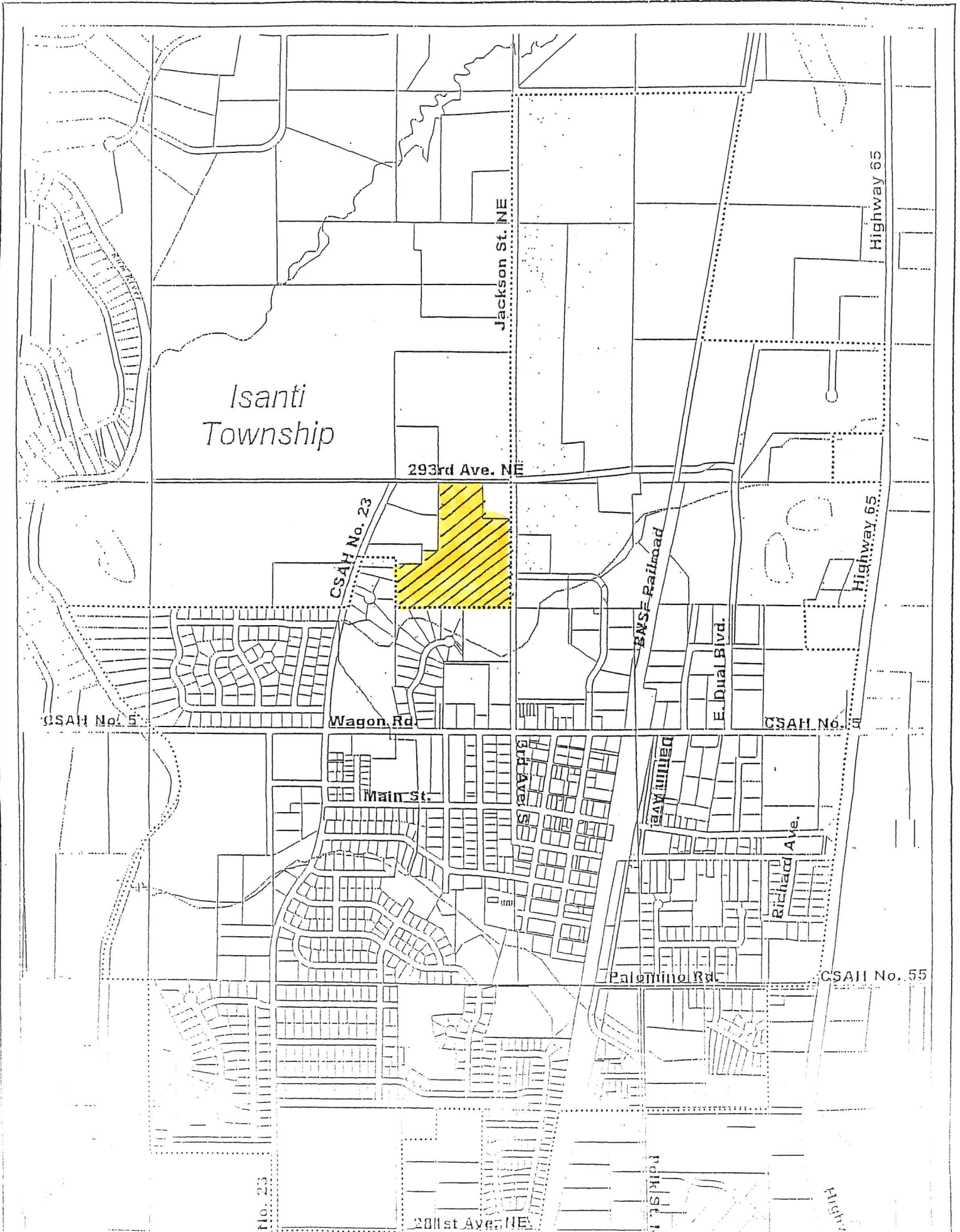



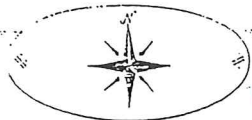

REC'D BY  
MAM B

APR 18 2002

©1999 Cloud Cartographers, Inc., St. Cloud, MN 56301

SEE PAGE 36

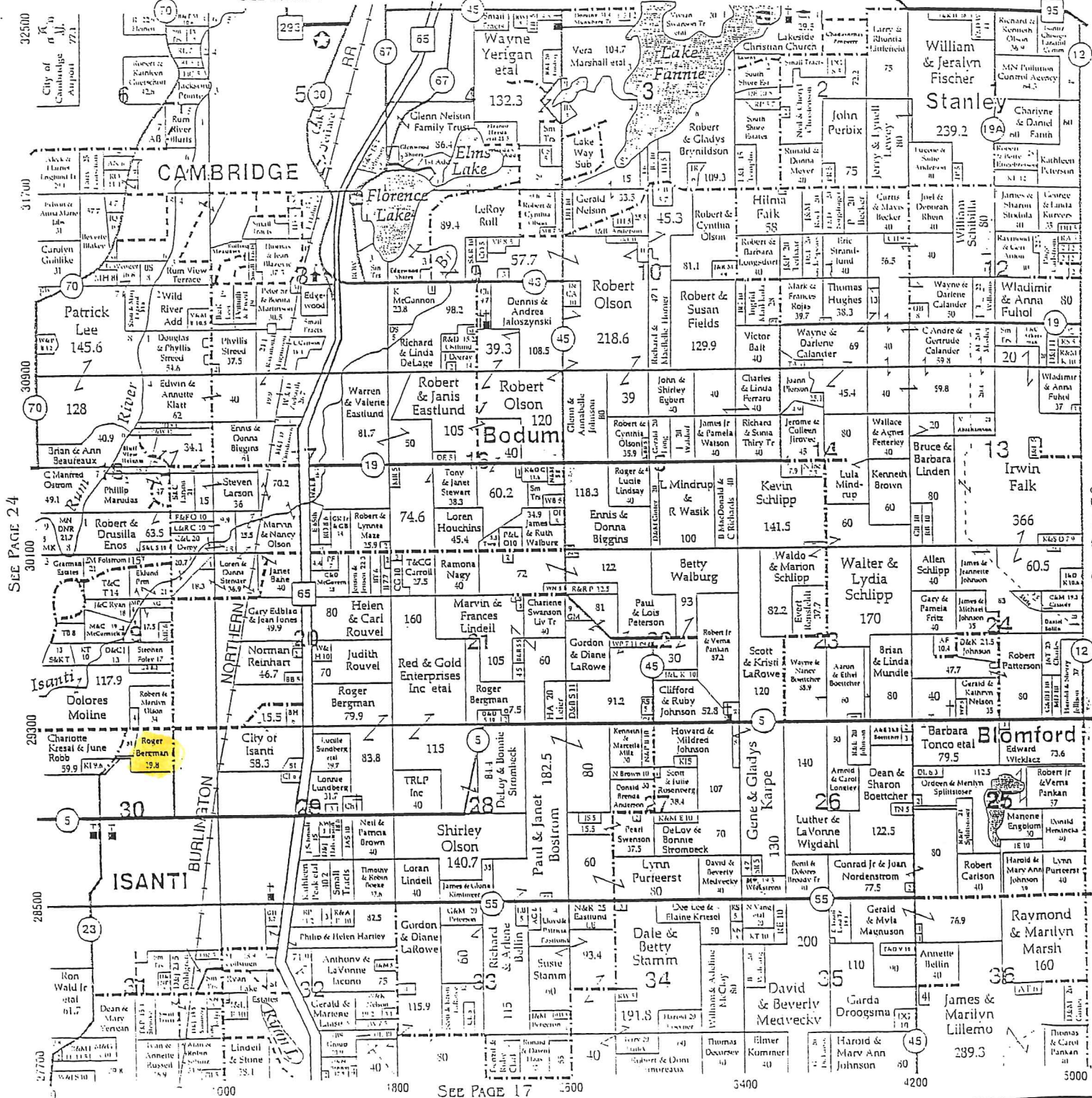

SEE PAGE 24

SEE PAGE 30



Serving you  
24 hours a day

**Northland 66**

Hwy. 65 & County Rd 5 • Isanti (612) 444-6018

Convenience Store • Deli • Fresh Bakery • Car Wash • Propane • Gas

