

RESOLUTION NO. 7434

REQUEST FOR ANNEXATION

WHEREAS, the following described property is urban in character and adjoins the City of Hutchinson, and

WHEREAS, the City Council of the City of Hutchinson hereby requests the described property to be annexed to the City of Hutchinson, and

WHEREAS, authority to effect such annexation is vested in the Minnesota Municipal Board by virtue of joint resolution of township and City,

NOW THEREFORE BE IT RESOLVED BY THE CITY COUNCIL OF THE CITY OF HUTCHINSON:

THAT, the Minnesota Municipal Board is requested to hold hearing and effect the annexation of the following tract:

That part of the Northwest Quarter of Section 36, Township 117 N, Range 30 West, described as follows:

Commencing at the North Quarter corner of Section 36; thence along the North line of said NW 1/4, on an assumed bearing of West, a distance of 565.92 feet to the point of beginning, said point being the SE corner of the Oakwood Addition; thence continuing West along said North line, a distance of 753.30 feet; thence South one (1) degree 53 minutes West, a distance of 279.65 feet; thence East 805.19 feet, to the center line of County Road No. 12 and the NE corner of the Green's View Addition; thence Northwesterly along said center line of County Road No. 12, a distance of 282.74 feet more or less to the point of beginning.

Adopted by the City Council this 28th day of June, 1983.

ATTEST:

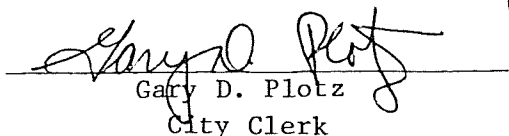
Gary D. Plotz
City Clerk

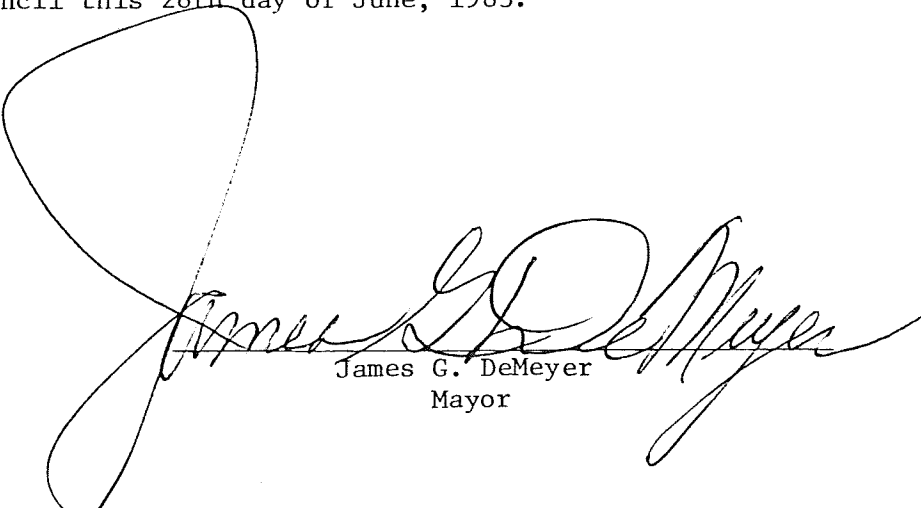
James G. DeMeyer
Mayor

S E A L

REC'D BY
MUR JUL 15 1983

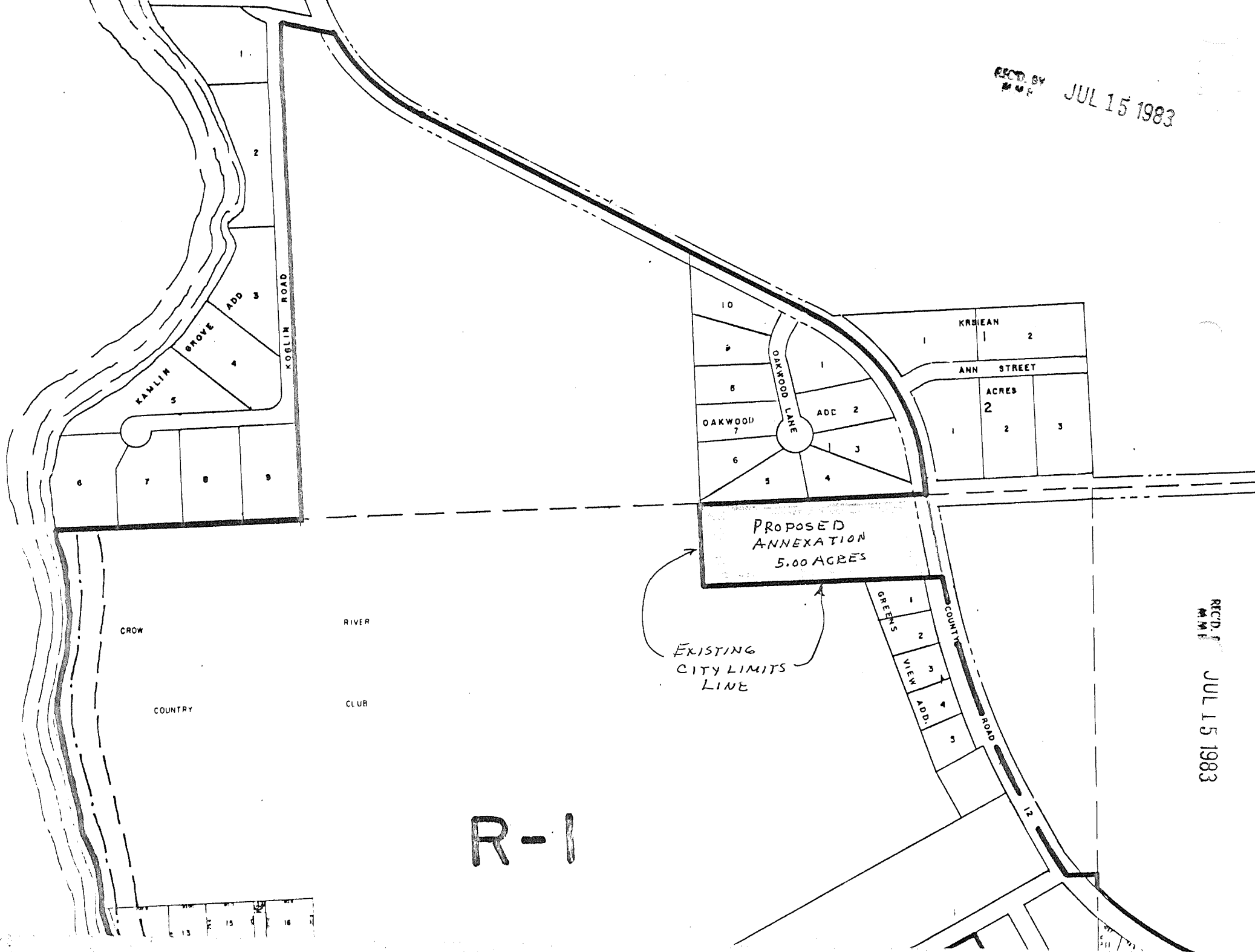

REC'D BY
MME JUL 15 1983